



sistema de gradeamento e corrimão

railing and handrail system

système de garde-corps et main courante



## Características do Sistema

System features

Caractéristiques du système



Sistema de alumínio que permite a execução de gradeamentos e corrimões com capacidade de responder às necessidades de qualquer tipo de habitação. A variedade de acabamentos em conjugação com a diversidade de tipologias faz com que se possa adaptar a qualquer tipo de habitação. Com a utilização do vidro consegue-se atingir o requinte exigido pela arquitetura moderna.

Aluminium system that favours the setting of railings and banisters in any type of housing. The variety of finishing together with the diversity of typology make them adaptable to any sort of decoration. With the use of glass can be achieved the refinement required by modern architecture.

Système en aluminium permettant la réalisation de garde-corps et rampes capables de répondre à toutes les exigences quelque soit le type de bâtiment. La variété des finitions peut s'associer aux différents éléments déjà existants et permet l'adaptation à tout type de décoration. Avec un remplissage en verre, il s'accorde parfaitement au raffinement de l'architecture moderne.

|                                       |   |
|---------------------------------------|---|
| <b>Corrimão:</b>                      | <b>Reta: 77x36mm   80x36mm Redonda: Ø66mm</b> |
| Handrail                              | Straight: 77x36mm   80x36mm Round: Ø66mm      |
| Main courante                         | Droite: 77x36mm   80x36mm Ronde: Ø66mm        |
| <b>Prumo:</b>                         | <b>40x20mm</b>                                |
| Column                                |   |
| Poteau                                |   |
| <b>Grade:</b>                         | <b>Secção triangular 20x20mm</b>              |
| Railing                               | Triangular section 20x20mm                    |
| Barreau                               | Section triangulaire 20x20mm                  |
| <b>Pateres:</b>                       | <b>Extrudidos</b>                             |
| Column support                        | Extruded                                      |
| Sabot sur dalle                       | Extrudé                                       |
| <b>Acessórios:</b>                    | <b>Fixação oculta</b>                         |
| Accessories                           | Concealed anchorage                           |
| Accessoires                           | Fixation cachée                               |
| <b>Distância máxima entre prumos:</b> | <b>1,00 m</b>                                 |
| Maximum distance between columns      |   |
| Distance maximale entre poteaux       |   |
| <b>Acabamentos:</b>                   | <b>Lacados   Anodizados</b>                   |
| Finishes                              | Powder coating   Anodizing                    |
| Finitions                             | Laqué   Anodisé                               |

\*\*\* EUROPEAN  
ALUMINIUM ASSOCIATION  
QUALANOD  
Licença nº. 1406 - Metalfer  
Licença nº. 1411 - Alfa Sul

QUALICONT  
Licença nº. 809



3

### Listagem de perfis

Profiles list  
Liste des profils

7

### Acessórios

Accessories  
Accessoires

13

### Pormenores de montagem

Assembly details  
Détails d'assemblage



**Listagem de perfis**

Profiles list  
Liste des profils

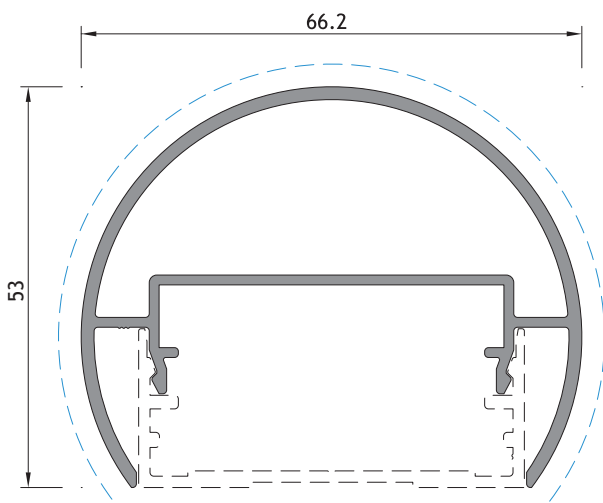

NC 01

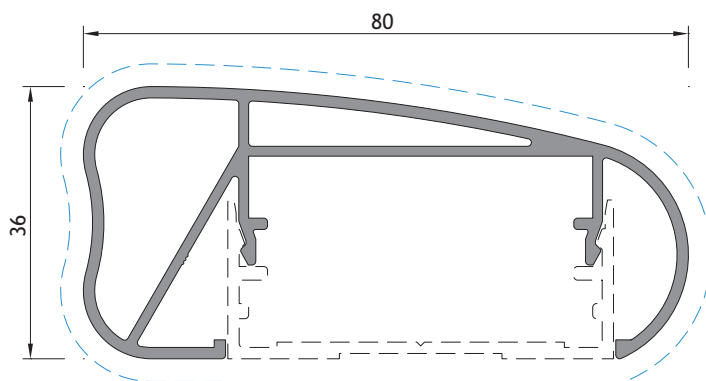

NC 10

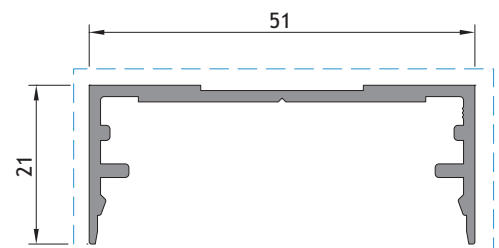

NC 03

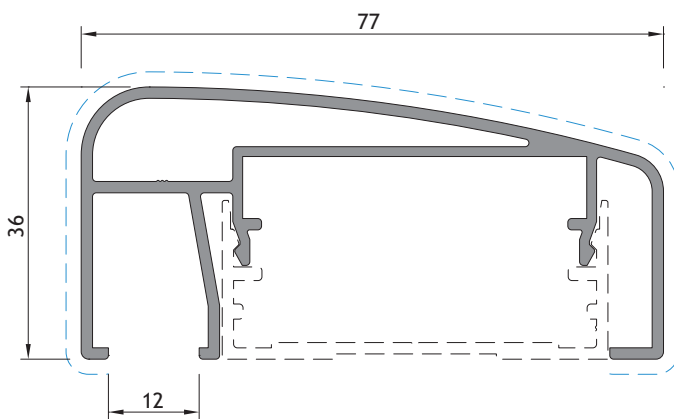

NC 20

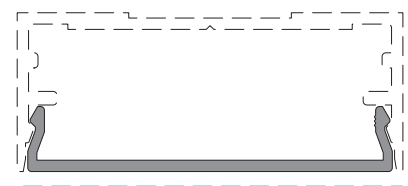

NC 04

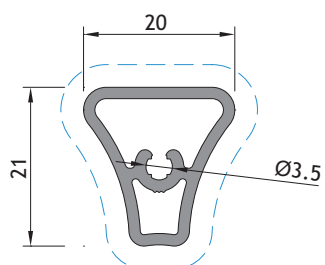

NC 00

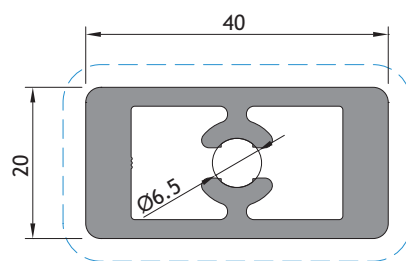

NC 05

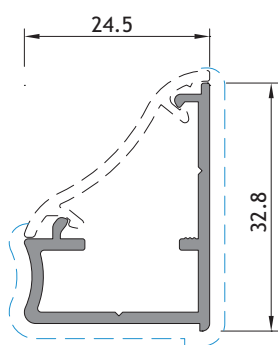

NC 13

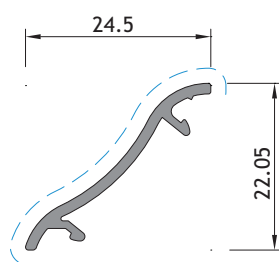

NC 14

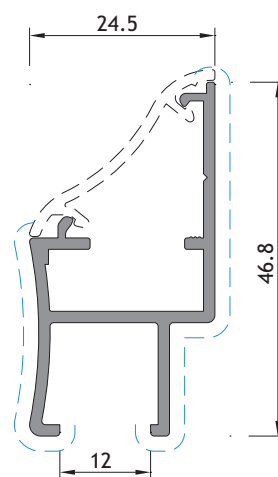

NC 15





## **Acessórios**

Accessories

Accessoires







210266

TOPO NC 01 RA 723 Ny. Pr.

210025  
210026TOPO NC 10 DIREITO Ny. Pr.  
TOPO NC 10 ESQUERDO Ny. Pr.

212534

CONJUNTO TOPO NC 01 INCLINADO RA 724 (Lacados, Bruto)

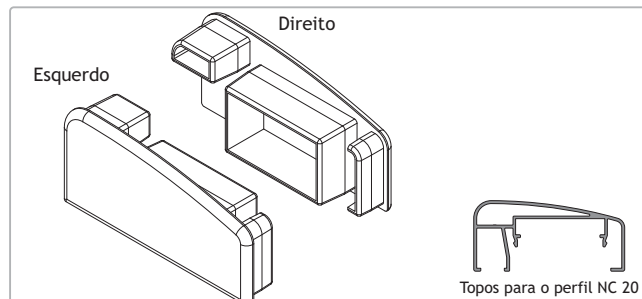

212369

CONJUNTO TOPOS NC 20 Ny. Pr.

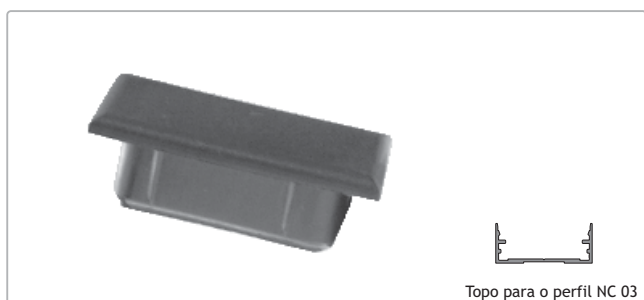

210031

TOPO NC 03 RA 452 Ny. Pr.

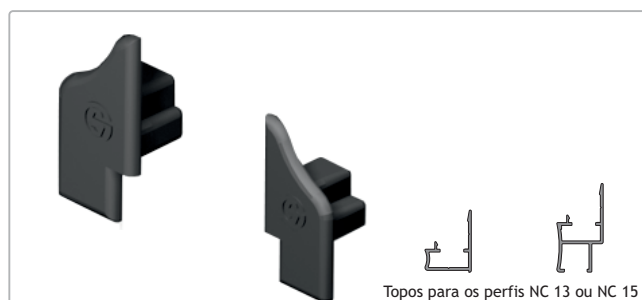
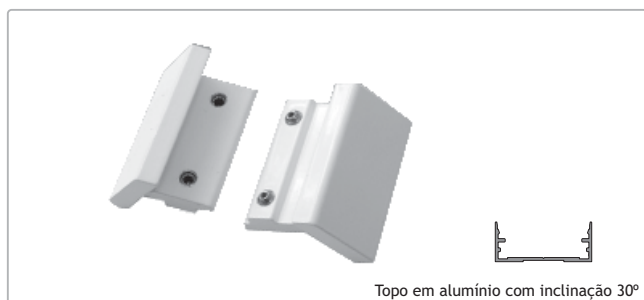
210281  
210282TOPO NC 15 DIREITO Ny. Pr.  
TOPO NC 15 ESQUERDO Ny. Pr.

212535

CONJUNTO TOPO NC 03 INCLINADO RA 656 (Lacados, Bruto)

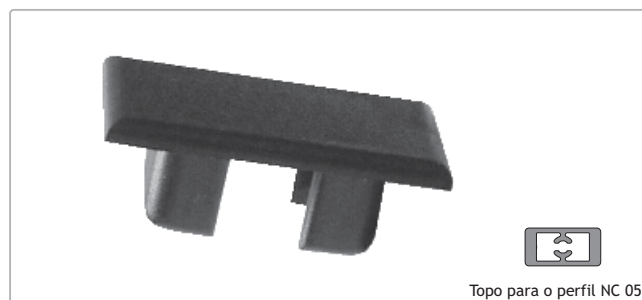

210024

TOPO NC 05 RA 592 Ny. Pr.

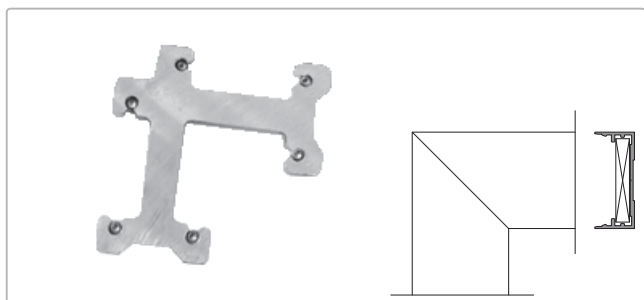

204740

ESQUADRO RA 385

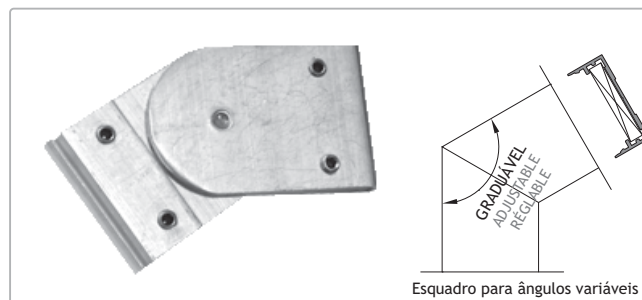

204742

ESQUADRO GRADUÁVEL P/ÂNGULO RA 391

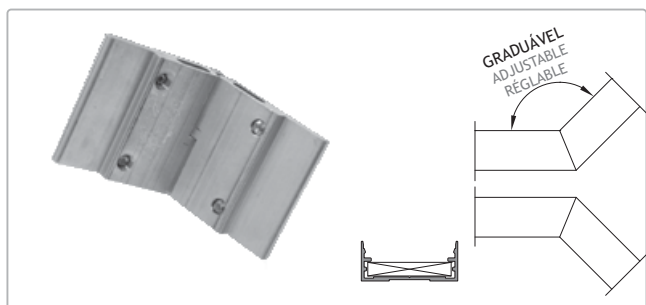

204307 ESQUADRO GRADUÁVEL RA 390

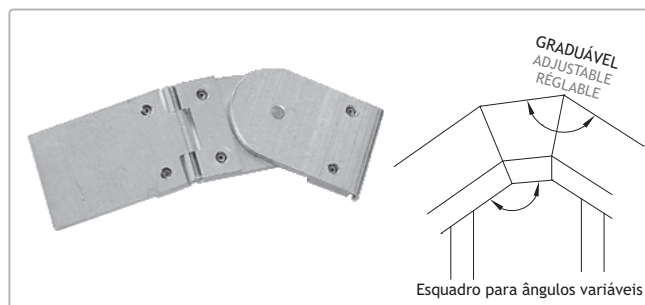

204743 ESQUADRO GRADUÁVEL P/ÂNGULO RA 575

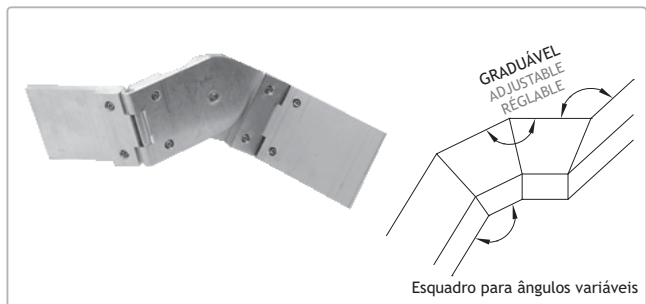

204744 ESQUADRO GRADUÁVEL P/ÂNGULO RA 576

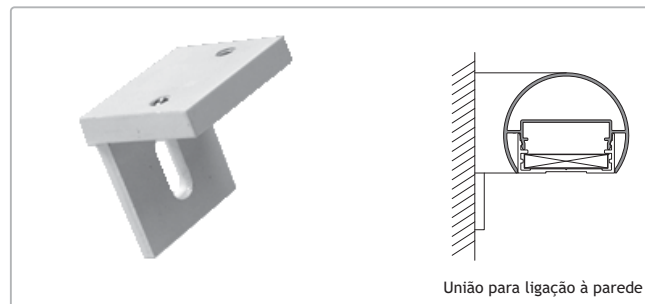

232001 UNIÃO PARA FIXAÇÃO RA 389 (Lacados, Bruto)



212536 CONJUNTO UNIÃO PARA FIXAÇÃO RA 469 (Lacados, Bruto)

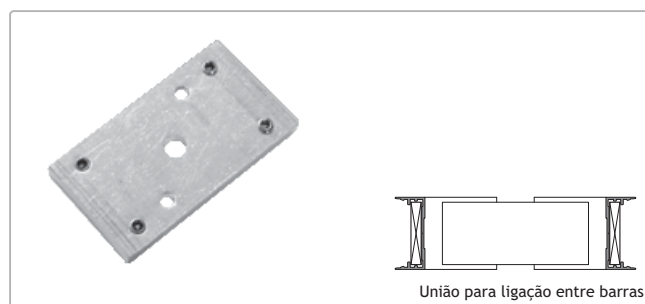

232003 UNIÃO RA 393



212915 CONJUNTO UNIÃO PARA MONTANTE RA 857

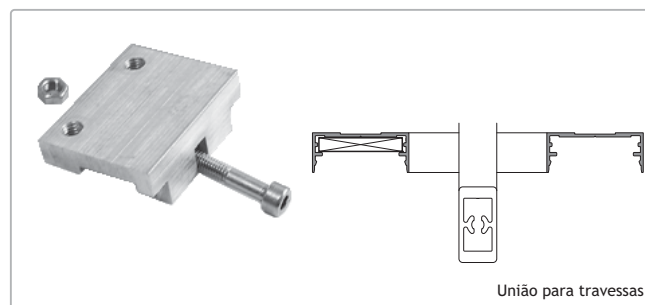

232008 UNIÃO DE TRAVESSAS RA 489



232005 UNIÃO DE TRAVESSAS INCLINADA RA 490

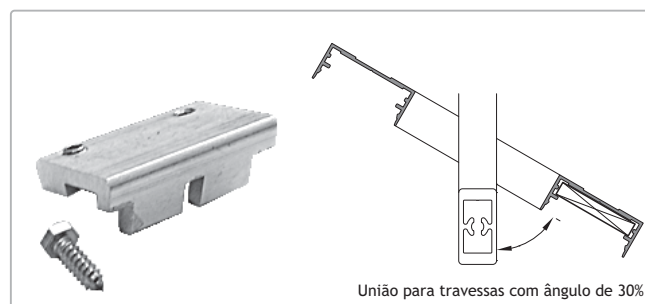

232006 UNIÃO DE TRAVESSAS INCLINADA RA 624

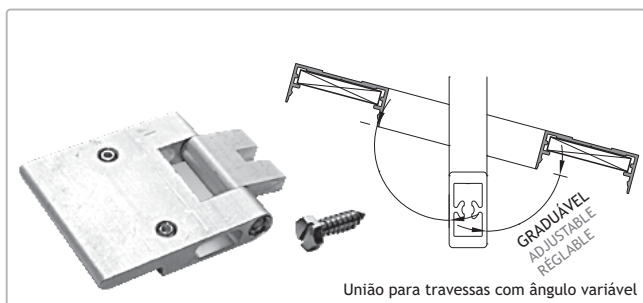

232004

UNIÃO DE TRAVESSA GRADUÁVEL RA 774

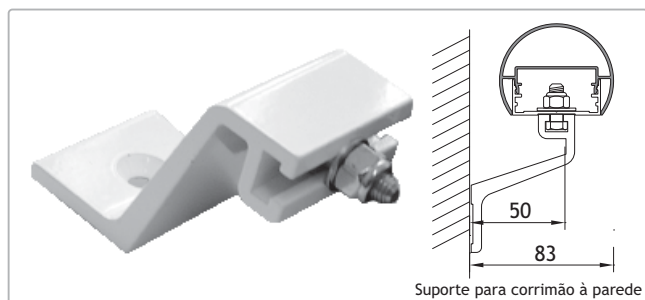

230008

SUPORTE DE FIXAÇÃO RA 718 (Lacados, Bruto)

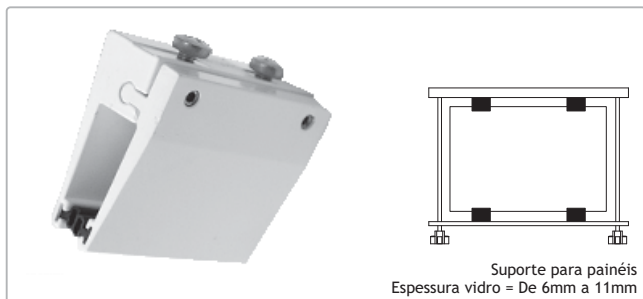

230011

SUPORTE PARA PAINEL RA 905 (Lacados, Bruto)



230007

SUPORTE INCL. ESQ. P/PAINEL RA 480 (Lacados, Bruto)



230006

SUPORTE INCL. DIR. P/PAINEL RA 480 (Lacados, Bruto)

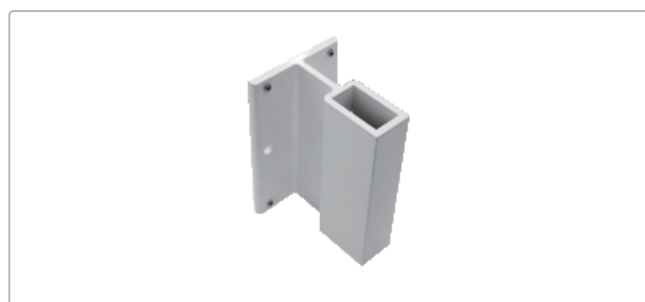

206062

PATER FIXAÇÃO LATERAL RA 761 (Lacados, Anodizados, Bruto)

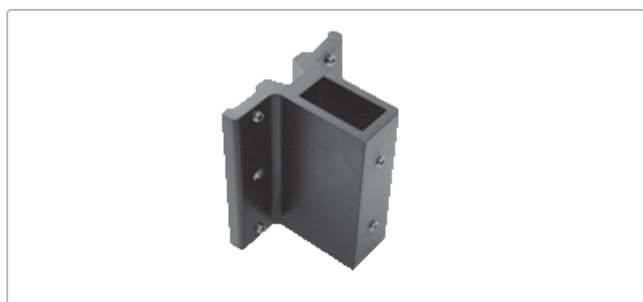

206063

PATER FIXAÇÃO LATERAL RA 763 (Lacados, Anodizados, Bruto)



206004

PATER FIXAÇÃO VERTICAL RA 461 (Lacados, Bruto)



206515

PATER FIXAÇÃO VERTICAL RA 908 (Lacados, Anodizados, Bruto)



210032

TOPO PARA PATER RA 472 (Lacados, Bruto)



206003 PATER FIX. VERTICAL C/AVANÇO RA 823 (Lacados, Bruto)

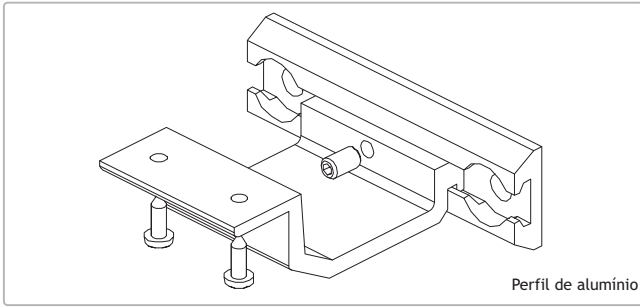

230500 SUPORTE DE FIXAÇÃO RA 634 (Lacados, Anodizados, Bruto)



213010 CANTO ALUMÍNIO PARA NC 01 RA 901(Lacados, Bruto)

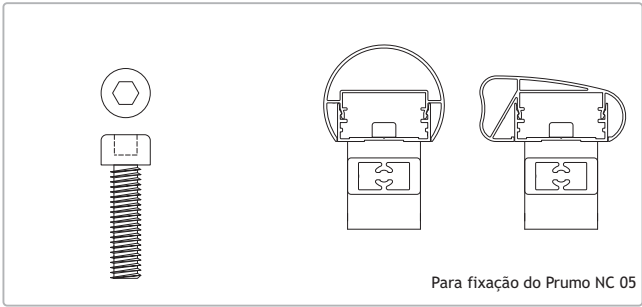

290456 PARAFUSO SEXTAVADO INTERIOR M8x30 INOX

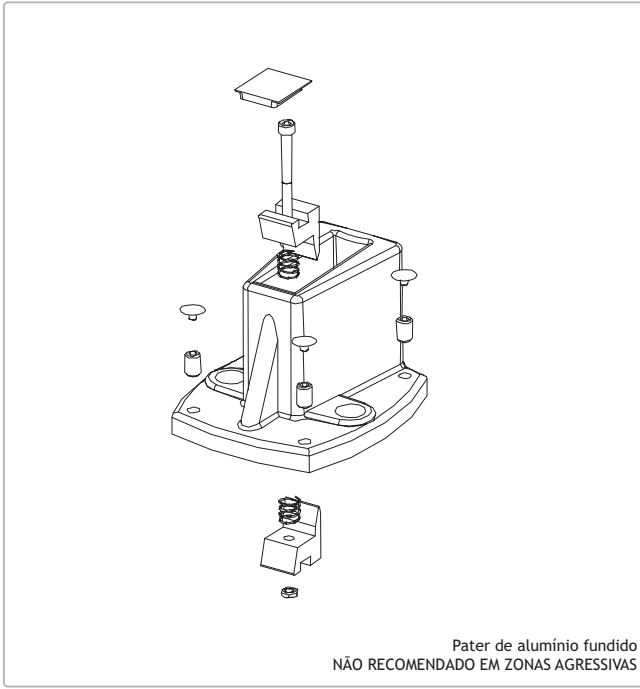

214102 BASE PATER 903306 (Lacados, Bruto)



208704 PRODUTO DE LIMPEZA DE ALUMÍNIO (1L) Transparente



208019 SELA JUNTAS 150gr. (Cinza)



## **Pormenores de montagem**

Assembly details  
Détails d'assemblage



## GUARDA-CORPOS COM GRADEAMENTO NA VERTICAL

VERTICAL RAILING

GARD-CORPS AVEC BARREAUDAGE VERTICAL

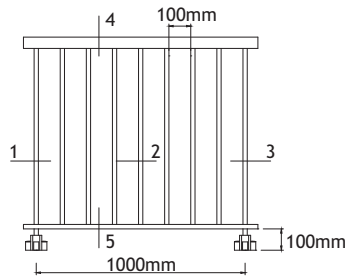

GRADEAMENTO ENTRE PRUMOS  
VERTICAL RAILING BETWEEN COLUMNS  
BARREAUDAGE ENTRE POTEAUX

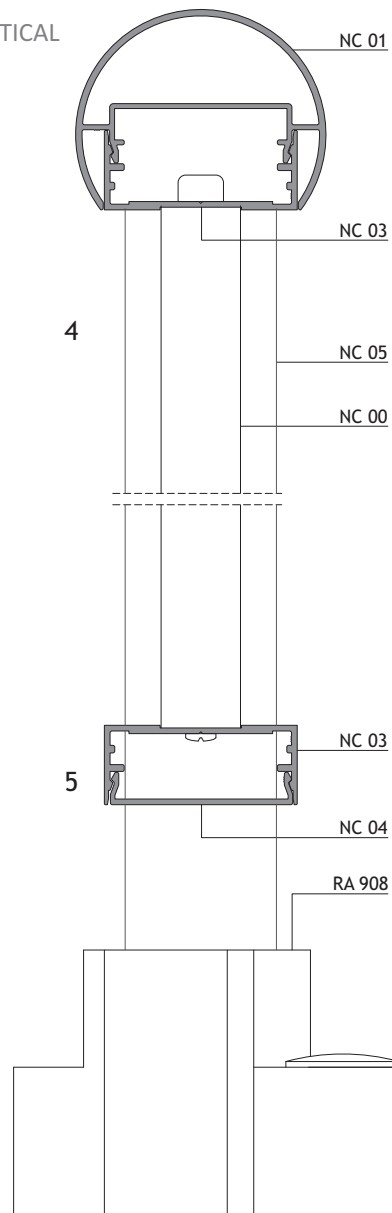

COM CORRIMÃO NC 01  
WITH HANDRAIL NC 01  
AVEC MAIN COURANTE NC 01

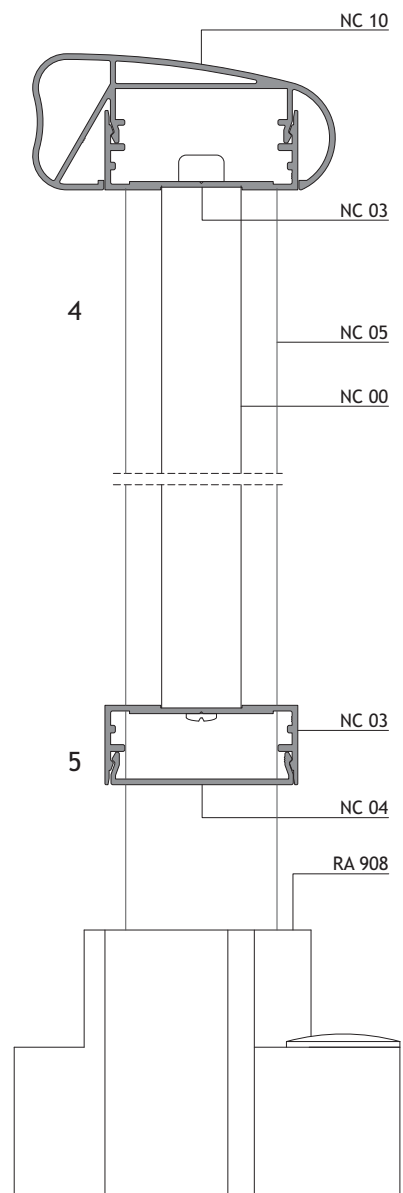

COM CORRIMÃO NC 10  
WITH HANDRAIL NC 10  
AVEC MAIN COURANTE NC 10

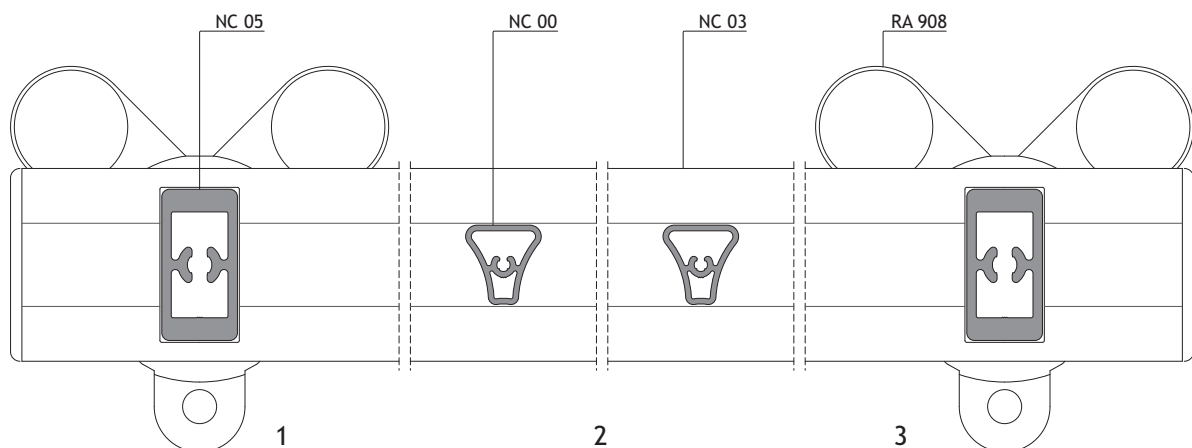

ESC: 1/2



## GUARDA-CORPOS COM GRADEAMENTO NA VERTICAL

VERTICAL RAILING

GARD-CORPS AVEC BARREAUDAGE VERTICAL

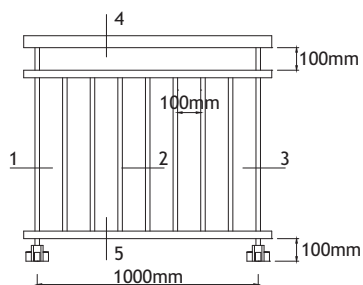

GRADEAMENTO FRONTAL AOS PRUMOS  
VERTICAL RAILING IN FRONT OF COLUMNS  
BARREAUDAGE FRONTAL AUX POTEAUX

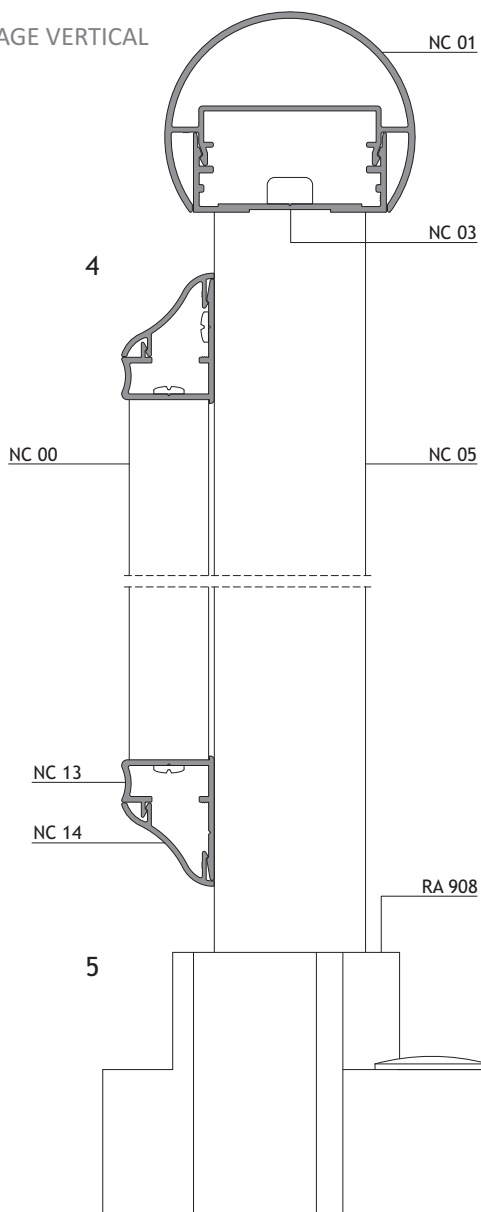

COM CORRIMÃO NC 01  
WITH HANDRAIL NC 01  
AVEC MAIN COURANTE NC 01

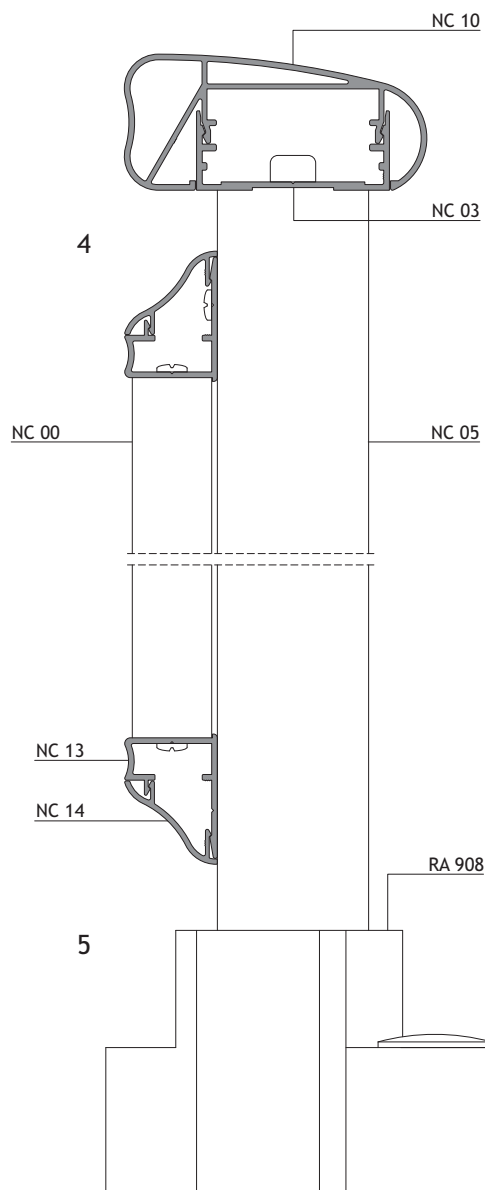

COM CORRIMÃO NC 10  
WITH HANDRAIL NC 10  
AVEC MAIN COURANTE NC 10

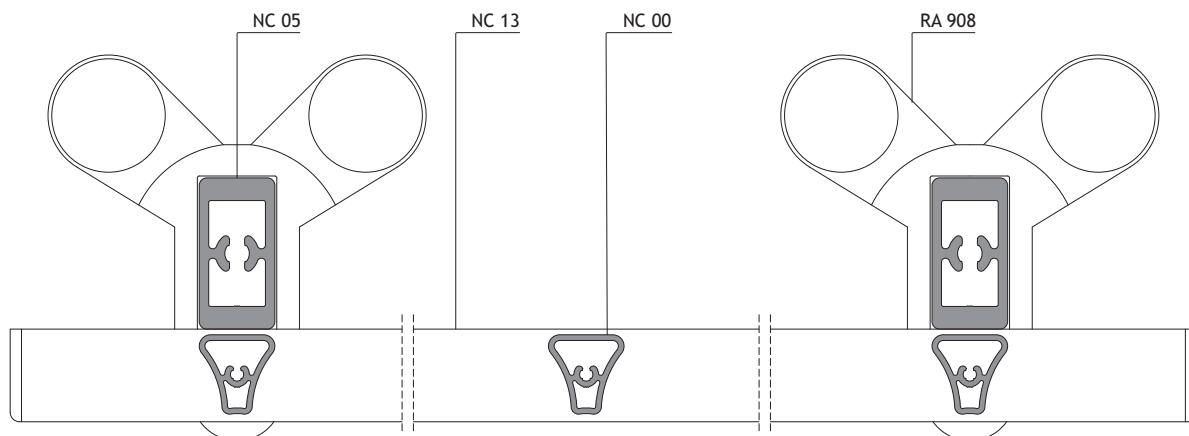

## GUARDA-CORPOS COM PAINEL EM VIDRO

GLASS RAILING

GARD-CORPS AVEC PANNEAU DE VERRE

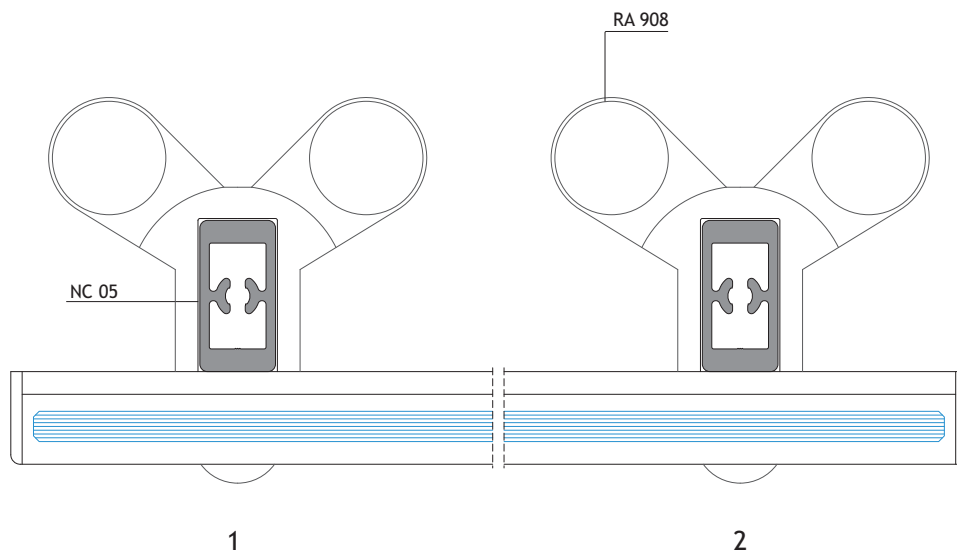
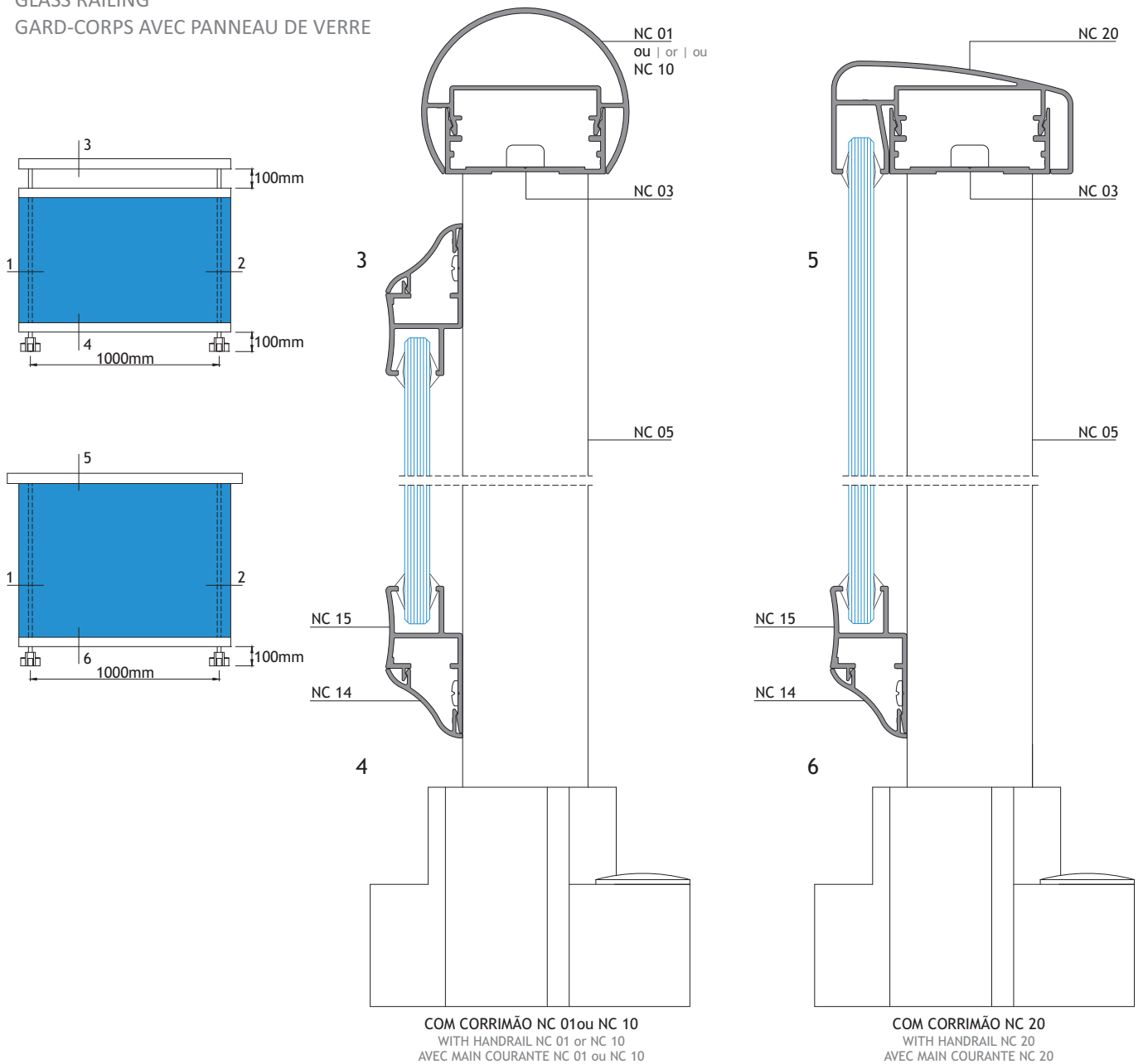

## FIXAÇÃO DO CORRIMÃO À PAREDE COM SUPORTE DE FIXAÇÃO RA 634

HANDRAIL FIXATION TO THE WALL WITH HANDRAIL BRACKET RA 634

FIXATION DU MAIN COURANTE AU MUR AVEC SUPPORT DE MAIN COURANTE RA 634

DISTÂNCIA MÁXIMA ENTRE APOIOS = 1200mm  
 MAXIMUM DISTANCE BETWEEN BRACKETS = 1200mm  
 DISTANCE MAXIMALE ENTRE SUPPORTS = 1200mm

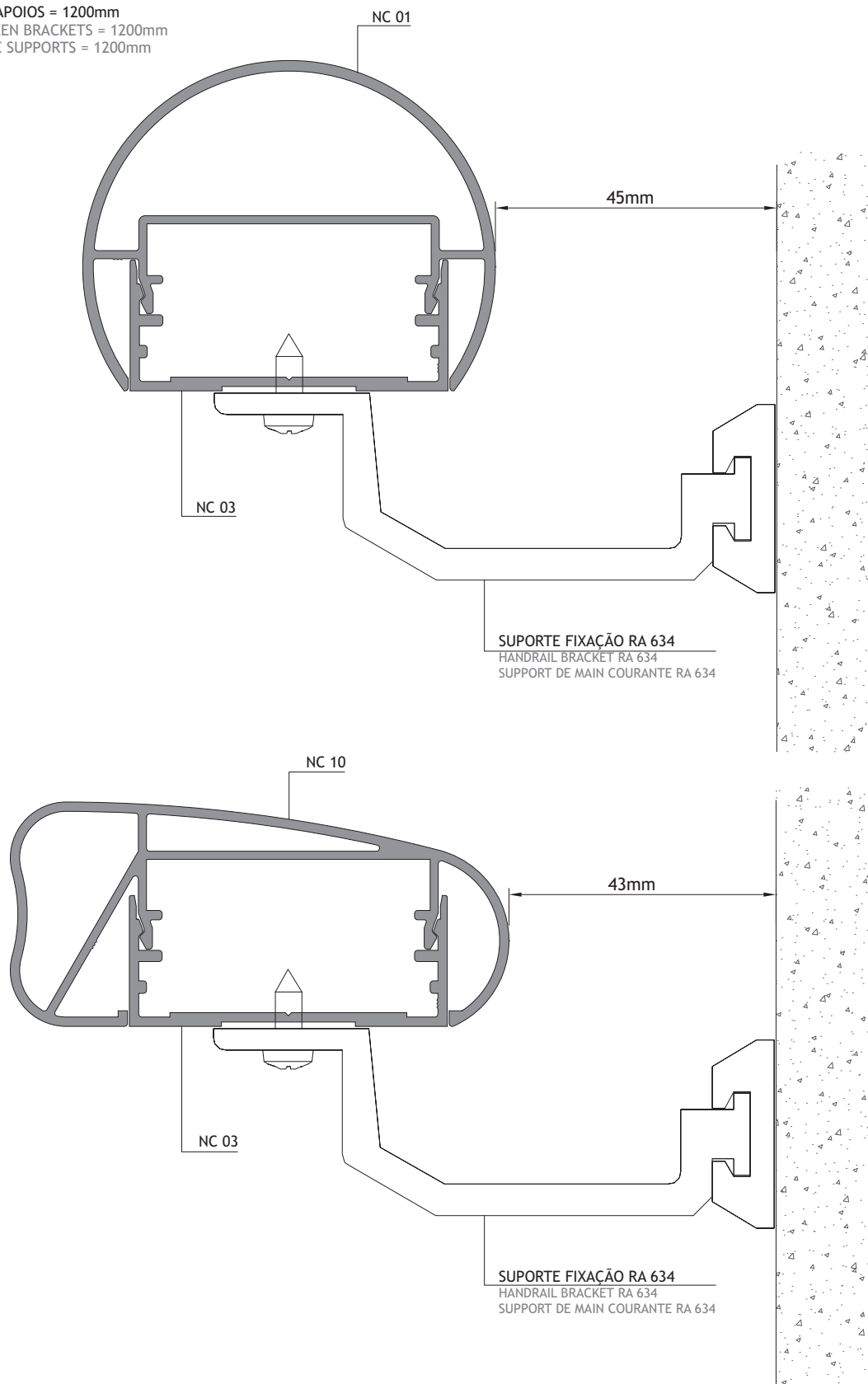





**SISTEMAS**  
**EURO 2000**®  
PERFIS DE ALUMÍNIO E VIDROS PARA ARQUITECTURA

### ALFA SUL

EN Lisboa-Sintra Km 14  
2725-397 Mem Martins  
T +351 219 265 090 | F +351 219 265 098  
E [alfa.sul@sosoares.pt](mailto:alfa.sul@sosoares.pt)

### ALULIDER

Pavilhão Industrial H - Plataforma 13D  
Zona Franca Industrial  
9200-047 Caniçal - Madeira  
T +351 291 960 494 | F +351 291 960 497  
E [alulider@sosoares.pt](mailto:alulider@sosoares.pt)

### METALFER

Travessa do Bolegão, 146  
Apartado 1  
3754-904 Fermentelos  
T +351 234 729 740 | F +351 234 729 741  
E [metalfer@sosoares.pt](mailto:metalfer@sosoares.pt)

### PERFIS OEIRAS

Rua da Colónia - Quinta da Cardosa  
Apartado 214 - Abrunheira  
2711-952 Sintra  
T +351 219 156 660 | F +351 219 156 661  
E [perfis.oeiras@sosoares.pt](mailto:perfis.oeiras@sosoares.pt)

### PORTALEX

Estrada de S. Marcos, 23  
2735-521 Cacém  
T +351 210 412 500 | F +351 210 412 507  
E [comercial@portalex.eu](mailto:comercial@portalex.eu)

### SOSOARES

Rua do Campo Alegre, 474  
4150-170 Porto  
T +351 226 096 709 | F +351 226 005 642  
E [comercial@sosoares.pt](mailto:comercial@sosoares.pt)



[www.sosoares.pt](http://www.sosoares.pt)



[www.portalex.eu](http://www.portalex.eu)