



sistema de batente de 70mm com canal 16 com corte térmico

70mm opening system with channel 16 with thermal break

système d'ouvrant de 70mm avec chenal 16 à rupture de pont thermique





Características do Sistema - Sistema OT

System features - OT System

Caractéristiques du système - Système OT



O sistema OT foi desenvolvido com o objectivo de reduzir os tempos de execução e aplicação, consistindo assim num sistema cujos processos de maquinação, montagem e aplicação são bastante simplificados. A utilização das ferragens canal 16 permitem vários eixos de afinação, contribuindo deste modo para o excelente funcionamento do caixilho. Combinando com tudo isto a aplicação de vidros selectivos, o sistema OT proporciona excelentes prestações térmicas e acústicas.

The OT system was developed with the aim to reduce the execution and application time, consisting of a system whose processes like machining, assembly and application is greatly simplified. The use of the hardware channel 16 allow multi-axis adjustment, thereby contributing to the excellent operation of the frame. Combining all this with the application of selective glazing, the OT system provides excellent thermal and acoustic benefits.

Le système OT a été développé afin de réduire les durées d'exécution et d'application, constituant ainsi un système dont les processus d'usinage, d'assemblage et d'application sont fortement simplifiés. L'utilisation des accessoires pour chenal 16 permettent le réglage multi-axes, ce qui contribue à l'excellent fonctionnement du châssis. Ajoutant à tout cela l'application sélective d'un vitrage, le système OT fournit d'excellents avantages thermiques et acoustiques.

OT		OT-Ocultia Concealed Cachée
Apresentação: Presentation Présentation	Reta Decor Straight Decor Droite Decor	
Dimensões: Dimensions Dimension	Aro Fixo: Fixed frame Cadre dormant 70mm	70mm
	Aro Móvel: Mobile frame Cadre ouvrant 83mm	75mm
Bites: Glazing beads Parcloses	Retos ou Redondos Straight or Round Droite ou Arrondie	
Enchimento: Filling Remplissage	Máximo 55mm (vidro) Maximum of 55mm (glass) Maximale 55mm (verre)	Máximo 30mm (vidro) Maximum of 30mm (glass) Maximale 30mm (verre)
Canal: Channel Chenal	Canal 16 Channel 16 Chenal 16	
Cortes: Cuts Coupes	45° 90°	
Vedação: Insulation Étanchéité	Junta em EPDM EPDM joints Joint en EPDM	
Unões: Joint Union	Exteriores de várias dimensões Esquadros de bloqueio interiores Exteriors of several dimensions Inner blocking brackets Extérieures de différentes dimensions Équerres de verrouillage intérieurs	
Peso máximo: Maximum weight Poids maximale	Janela batente (1 2 folhas) - 110 130Kg/folha leaf vantail Casement (1 2 leaves) Fenêtre à la française (1 2 vantaux) Oscilo-batente (1 2 folhas) - 110 130Kg/folha leaf vantail Tilt and turn (1 2 leaves) Oscillo-Battant (1 2 vantaux) Basculante - 70 Kg/folha leaf vantail Hopper À soufflet	
Acabamentos: Finishes Finitions	Lacados Anodizados Bicolores Powder coating Anodizing Bicolour Laqué Anodisé Bicolore	

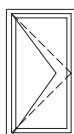

Batente int|ext 1|2 folhas
casement in|out 1|2 leaves
française int|ext 1|2 vantaux



Oscilo-batente 1|2 folhas
tilt and turn 1|2 leaves
oscillo-battant 1|2 vantaux



Basculante
hopper
à soufflet

Desempenho do sistema

System performance

Performance du système

Marcação CE

CE Marking

Marquage CE

NP EN 14351-1

Janela 2 folhas com 1,55x1,60m - OT-Ocultas

Vidro : 8 + 16 + 8

2 leaves window 1.55 x 1.60m - OT-Concealed

Glass: 8 + 16 + 8

Fenêtre 2 vantaux 1,55m x 1,60m - OT-Cachée

Verre: 8 + 16 + 8

Permeabilidade ao AR

AIR Permeability

Perméabilité à l'AIR

4

Estanquidade à ÁGUA

WATER Tightness

Étanchéité à l'EAU

E1350

Resistência ao VENTO

WIND Resistance

Résistance au VENT

C5

Coef. Transm. TÉRMICA

THERMAL Transmittance

Coef. de Transmission THERMIQUE

Uw = 1,33 W/m² K

Ug = 1,1W/m² K (Janela 2 folhas com 1,55x1,60m)

Ug = 1,1W/m²K (2 leaves window with 1,55x1,60m)

Ug = 1,1W/m²K (Fenêtre de 2 vantaux avec 1,55x1,60m)

Isolamento ACÚSTICO

ACOUSTIC Insulation

Isolation ACOUSTIQUE

Rw janela(dB)= 34dB

Rw (IGU) = 32dB, área ≤ 2,70m²

Rw (IGU) = 32dB, area ≤ 2,70m²

Rw (IGU)=32dB, aire ≤ 2,70m²

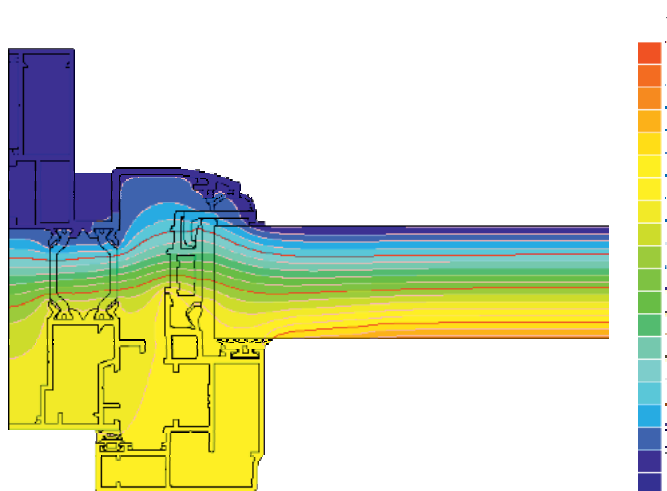
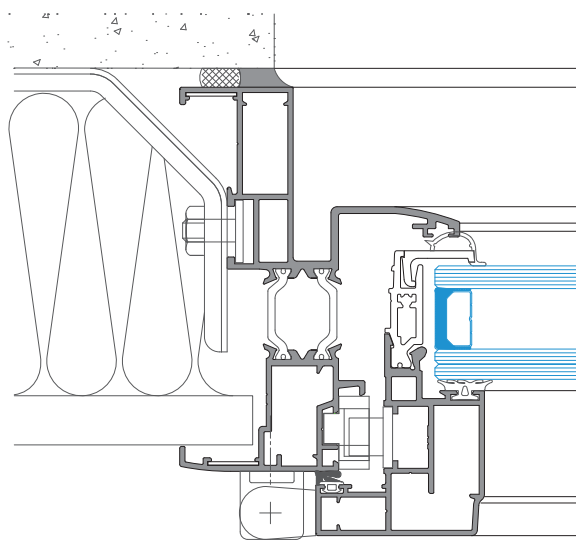



5

Listagem de perfis

Profiles list
Liste des profils

21

Acessórios

Accessories
Accessoires

35

Pormenores de montagem

Assembly details
Détails d'assemblage





Listagem de perfis

Profiles list

Liste des profils

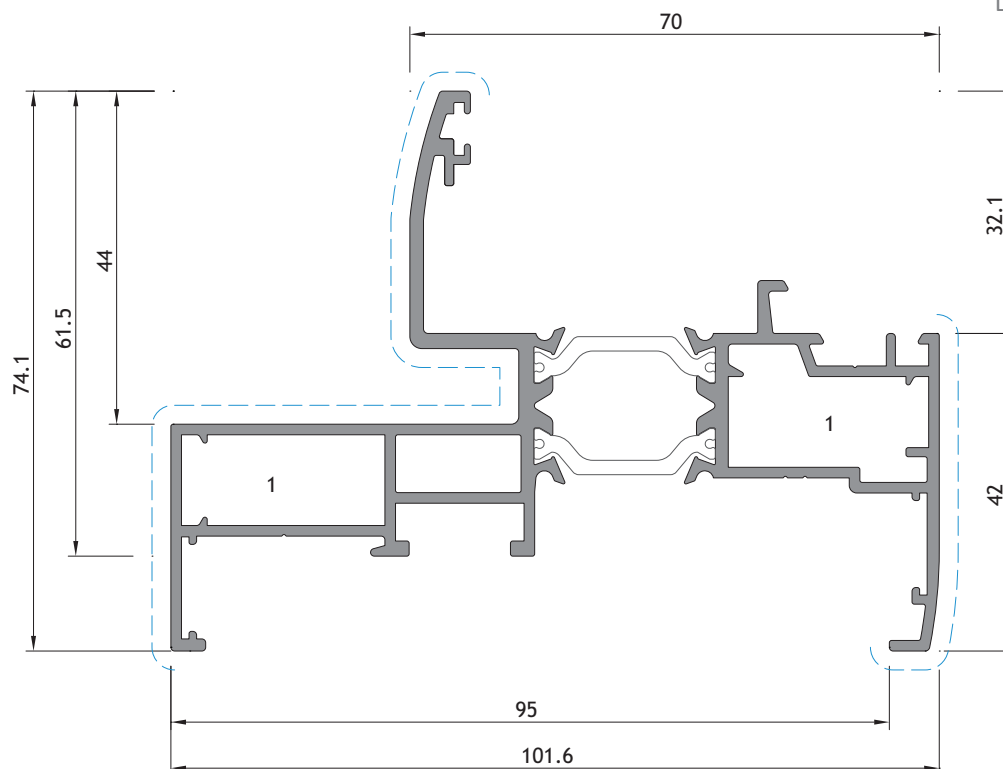

OT 01

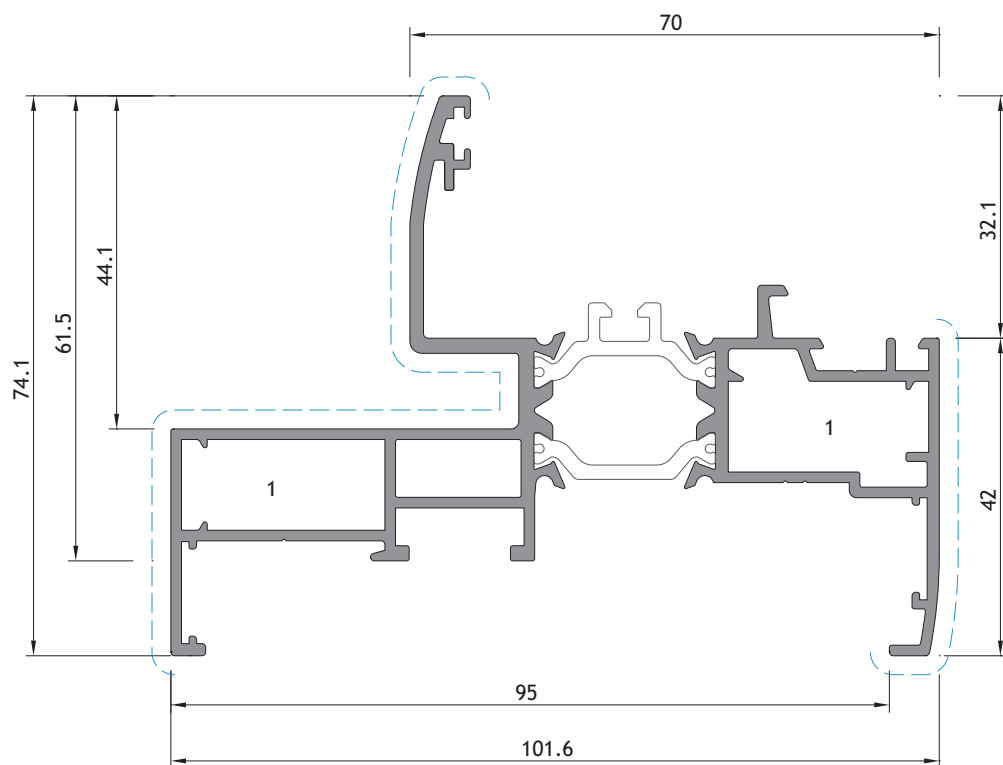

OT 03

1 - ESQUADRO 18-1123-C

4 - ESQUADRO SA 35 CORTADO PEQ.

2 - ESQUADRO AT PEQ. PEQUENO

5 - ESQUADRO 18-1135-C

3 - ESQUADRO 18-1112-C

6 - UNIÃO TRAVESSA SA2001 G

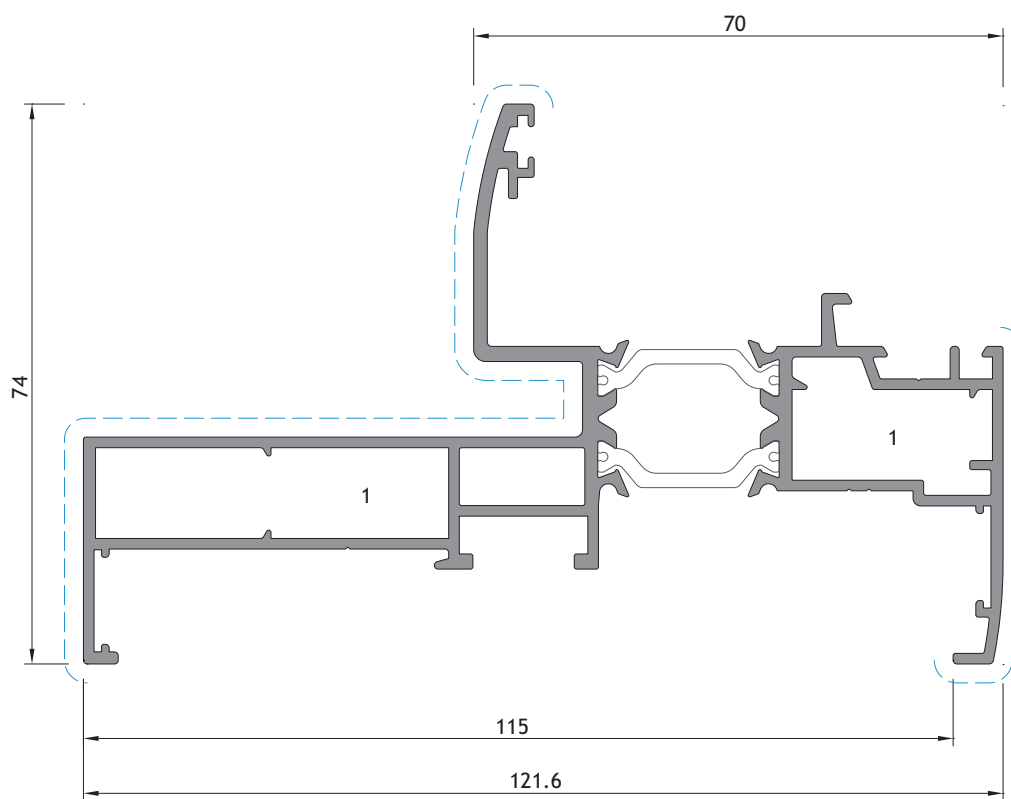

OT 41

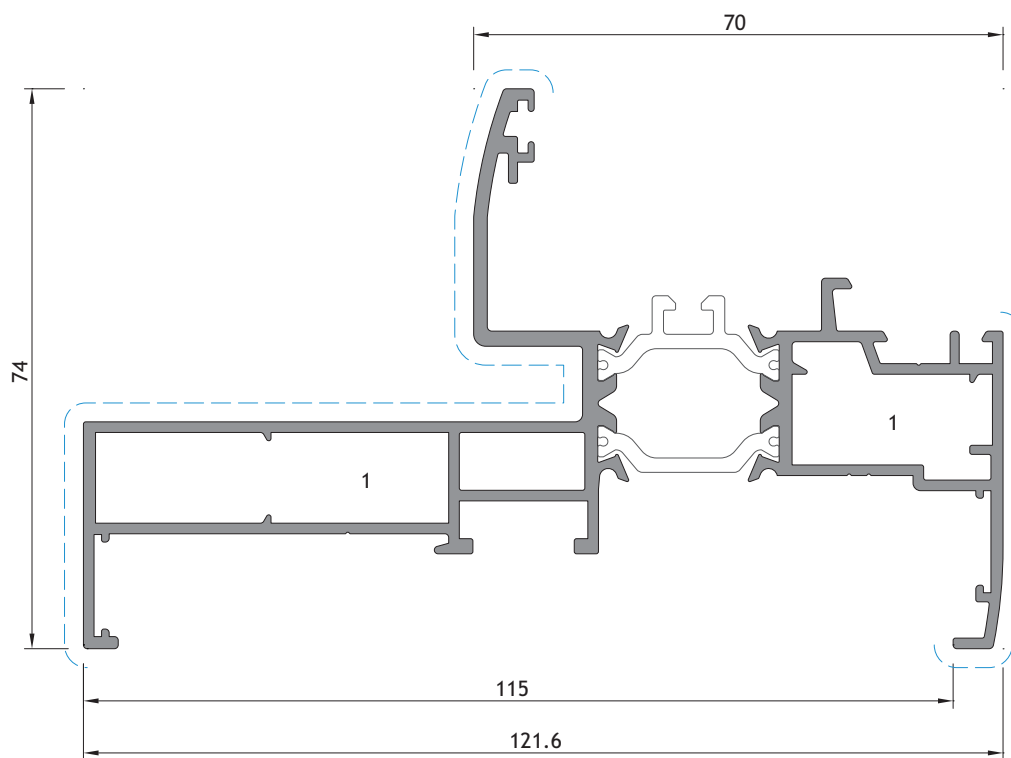

OT 43

1 - ESQUADRO 18-1123-C

4 - ESQUADRO SA 35 CORTADO PEQ.

2 - ESQUADRO AT PEQ. PEQUENO

5 - ESQUADRO 18-1135-C

3 - ESQUADRO 18-1112-C

6 - UNIÃO TRAVESSA SA2001 G

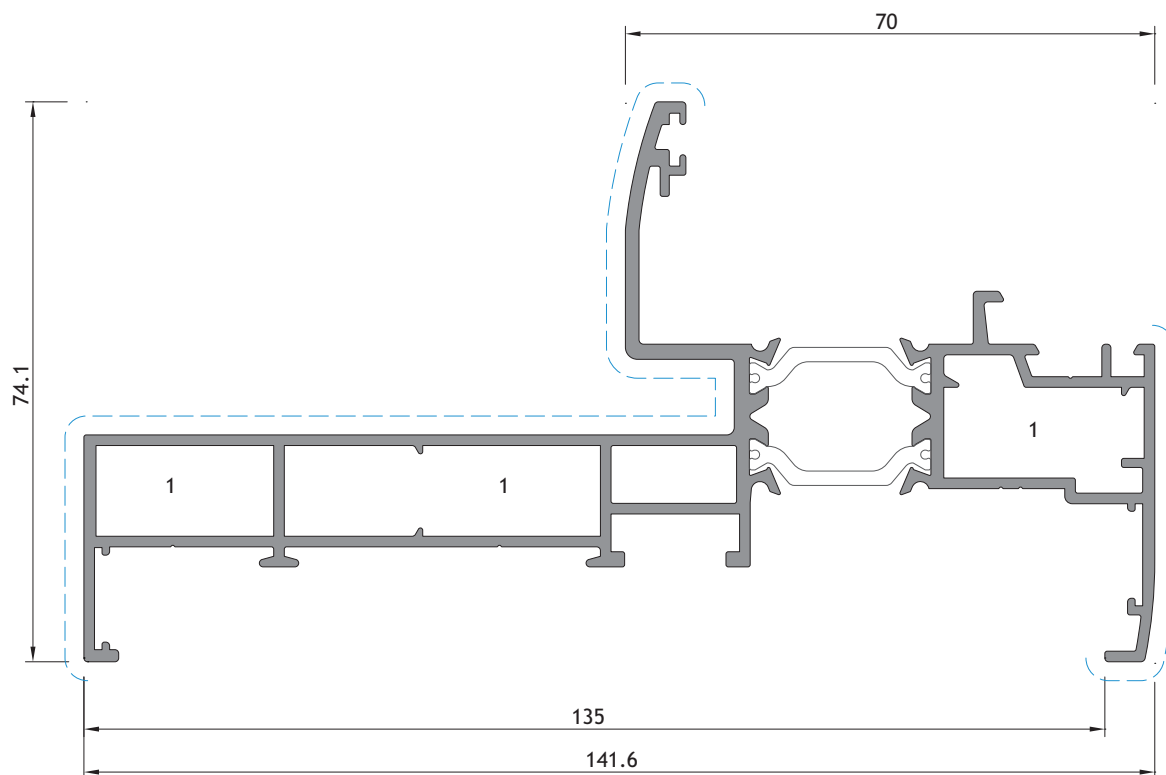

OT 51

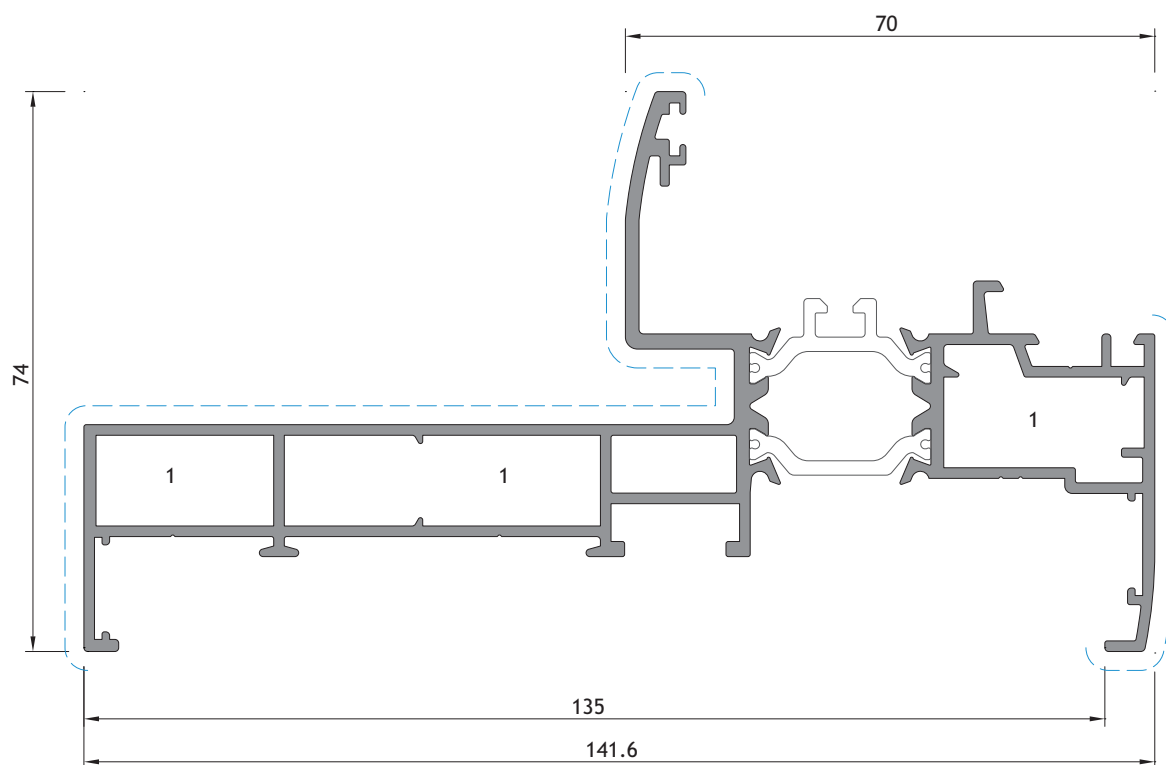

OT 53

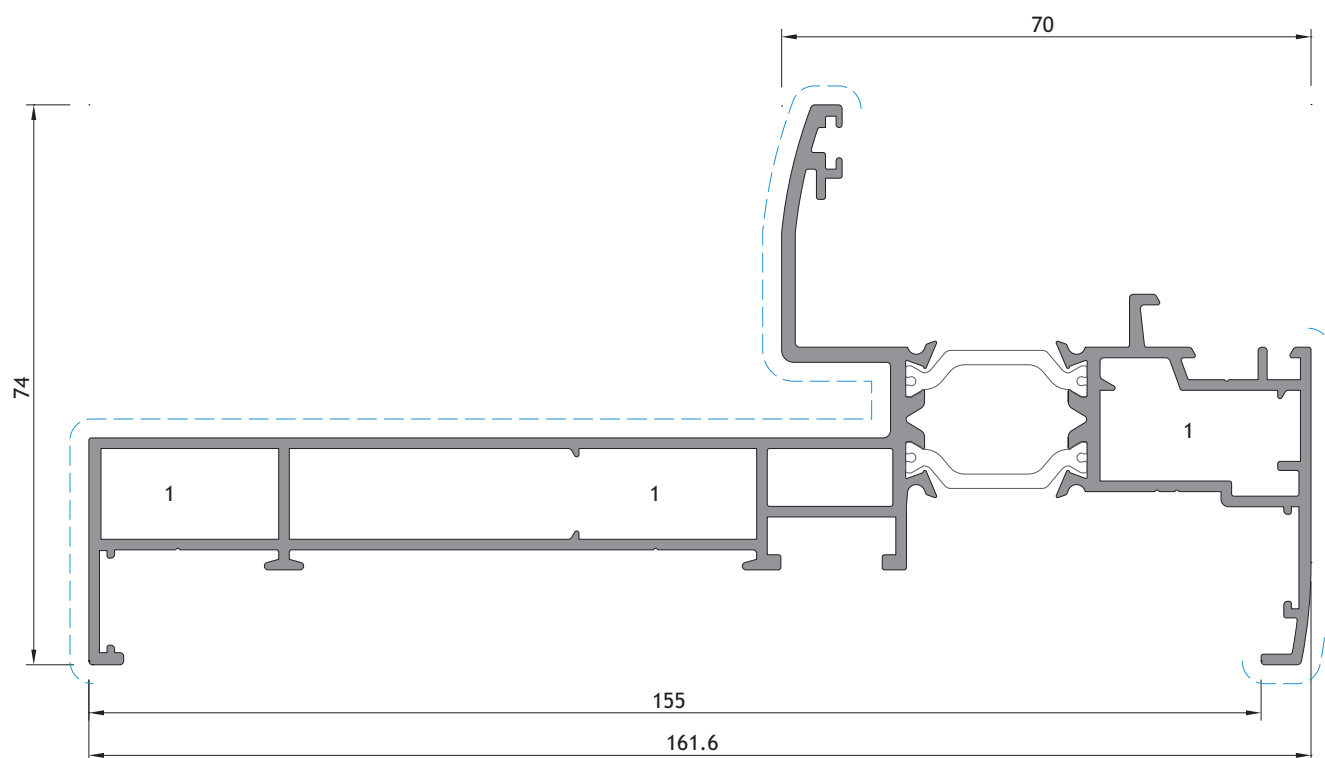

OT 61

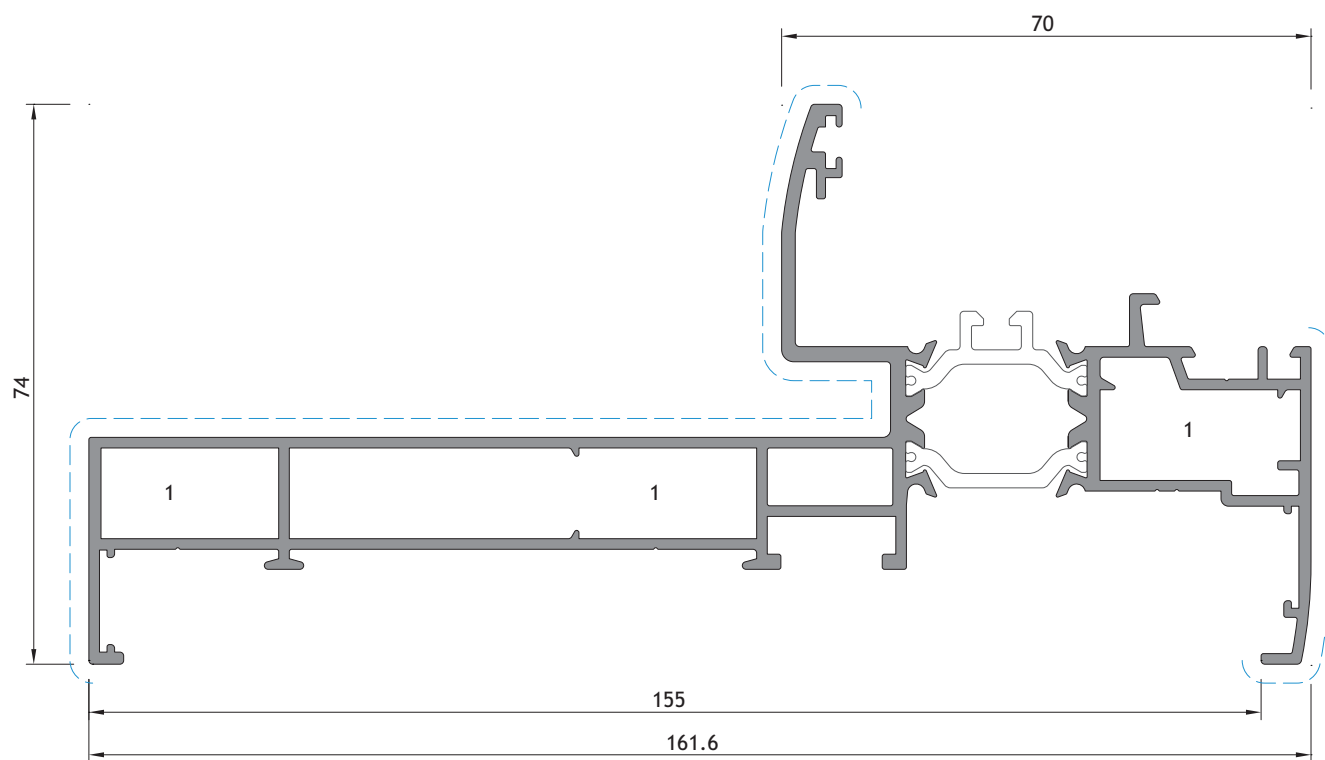

OT 63

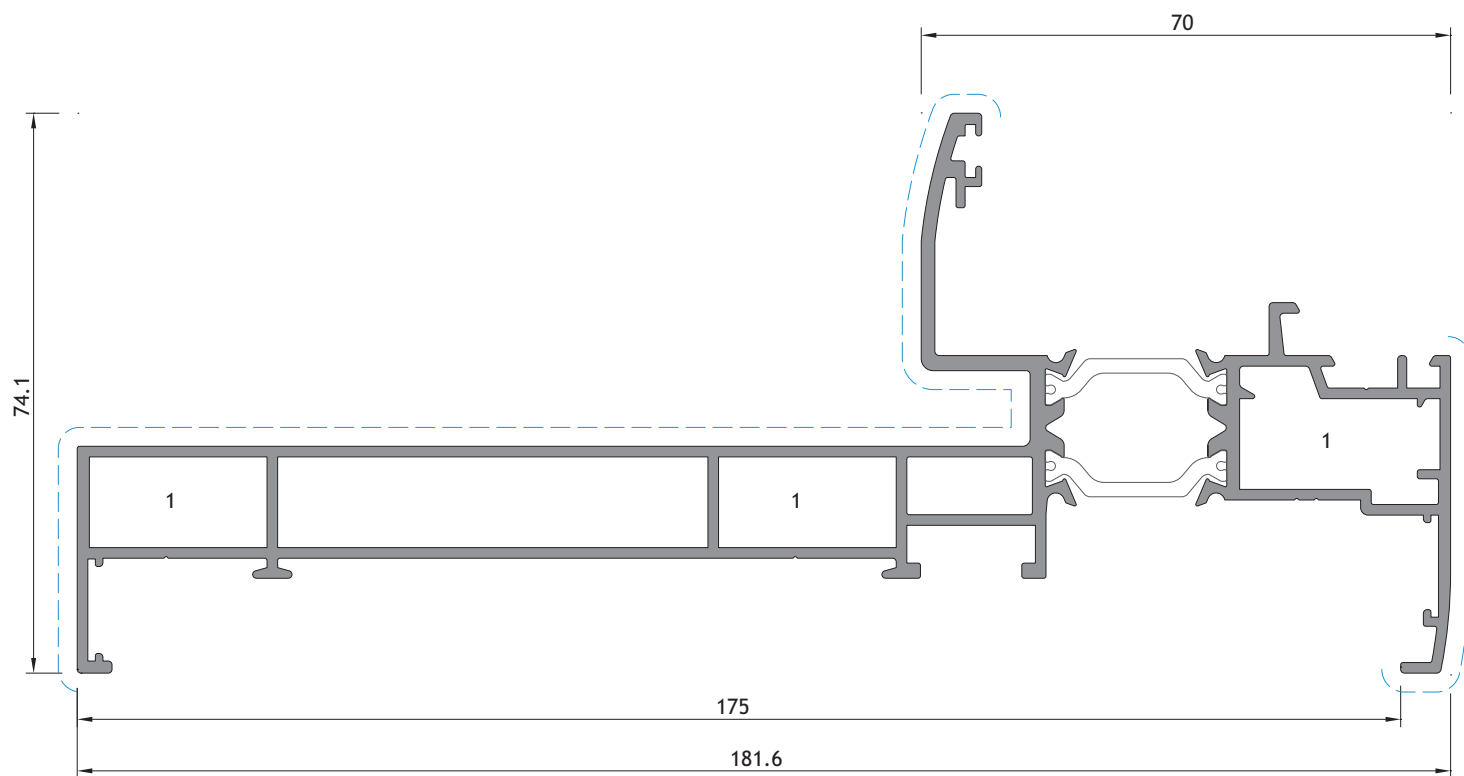

OT 71

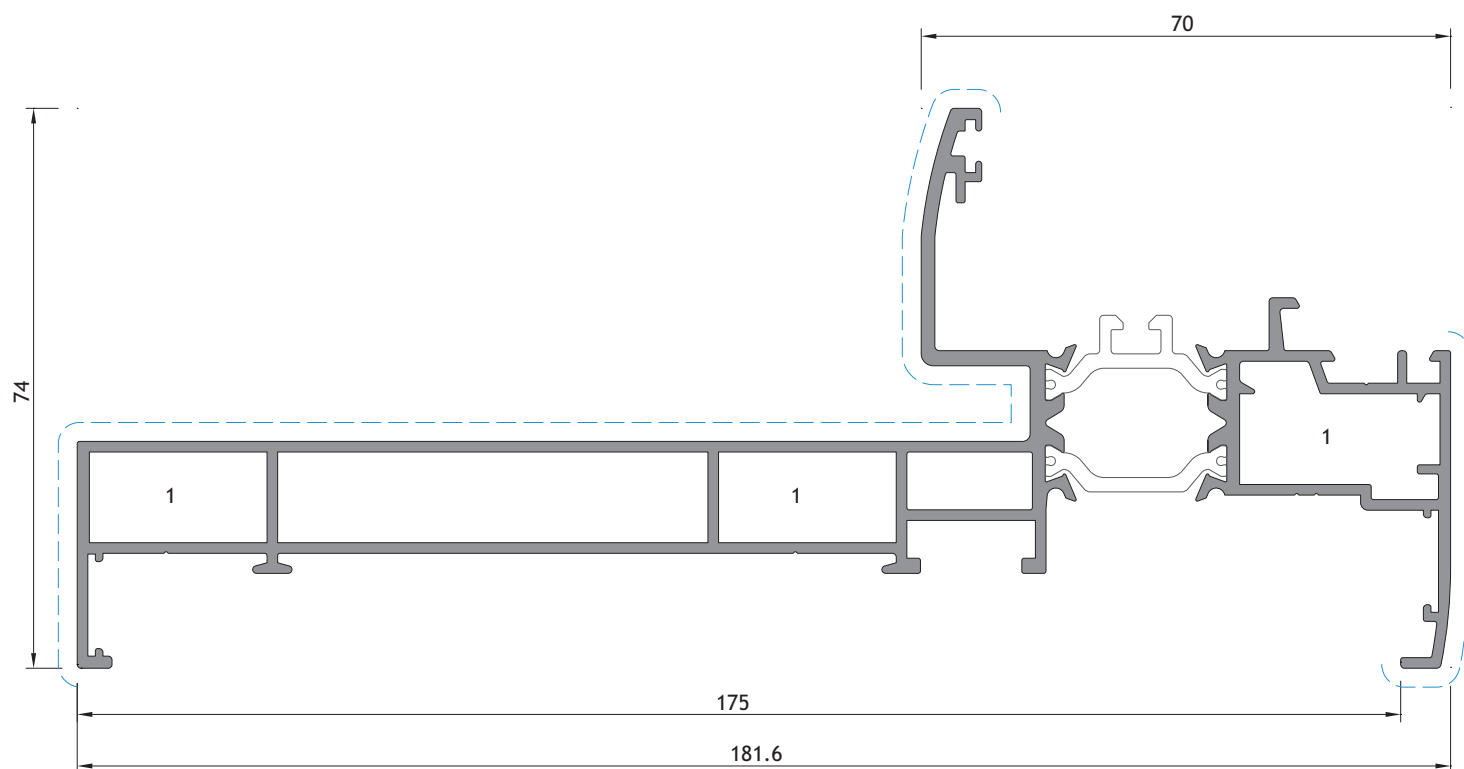

OT 73

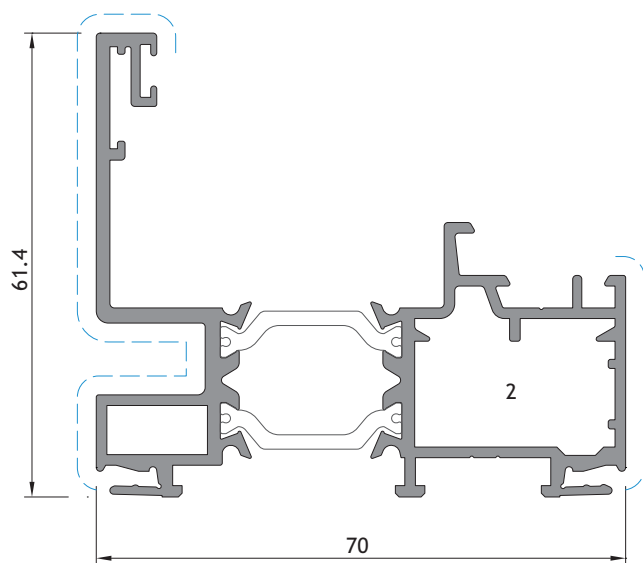

OT 60

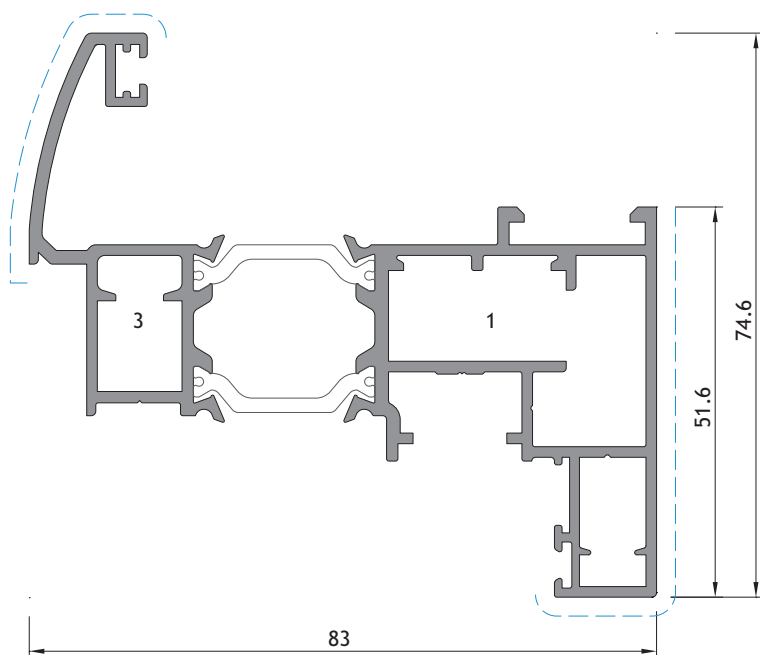

OT 85

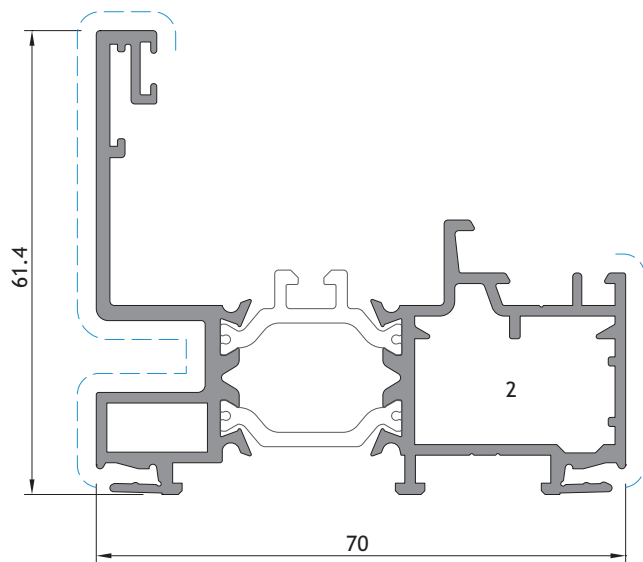

OT 62

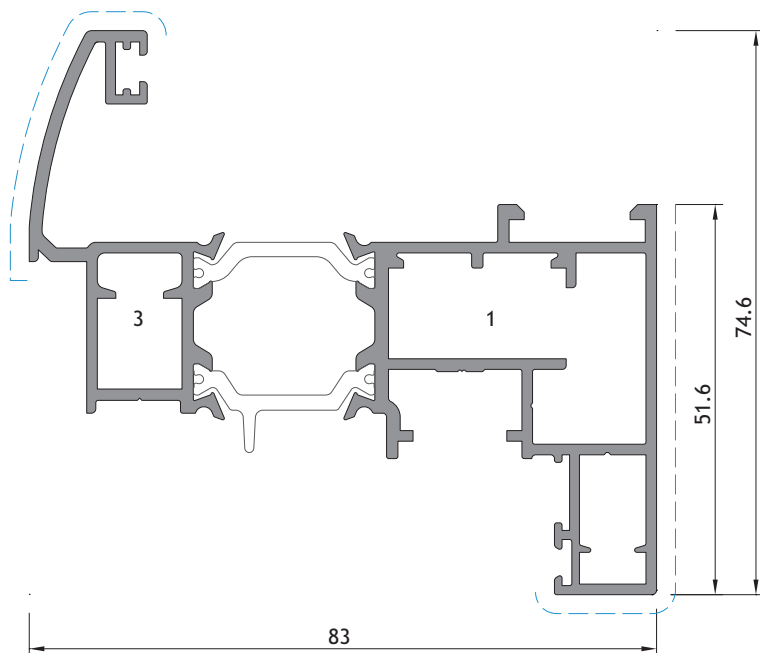

OT 86

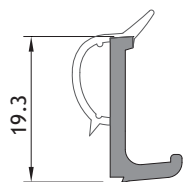

OT 95
(PERFIL EM PVC)
(PVC PROFILE)
(PROFIL EN PVC)

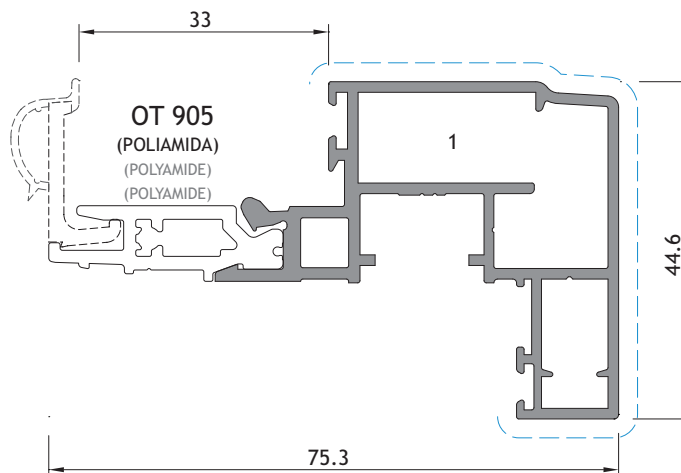

OT 05
(PARA OT OCULTA - LINHA DECOR)
(FOR CONCEALED OT - LINE DECOR)
(POUR OT OUVRANT CACHÉ - LIGNE DECOR)

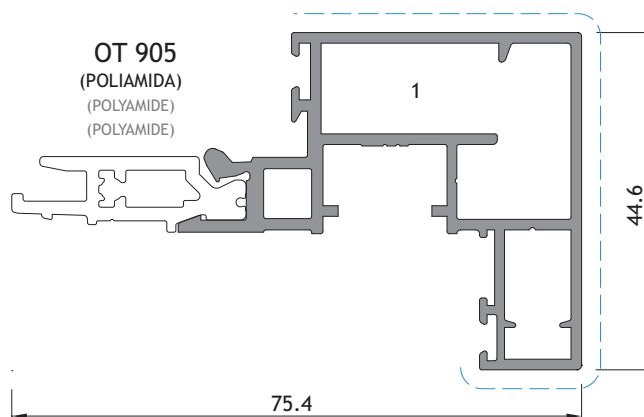

OT 02
(PARA OT OCULTA - LINHA RETA)
(FOR CONCEALED OT - LINE STRAIGHT)
(POUR OT OUVRANT CACHÉ - LIGNE DROITE)

IMPORTANTE | IMPORTANT | AVERTISSEMENT: OT-02

1º Anodizar/lacar o perfil OT-02

2º Cravar o OT-905 (Poliamida). O perfil OT- 905 não pode ser lacado/anodizado

1º Anodize/Powder coat profile OT-02

2º Clip profile OT-905 (Polyamide). The profile OT-905 cannot be powder coated/anodized

1º Anodisé/laqué profil OT-02

2º Enfoncer le profil OT-905 (Polyamide). Le profil OT-905 ne peuvent pas être laqué/anodisé

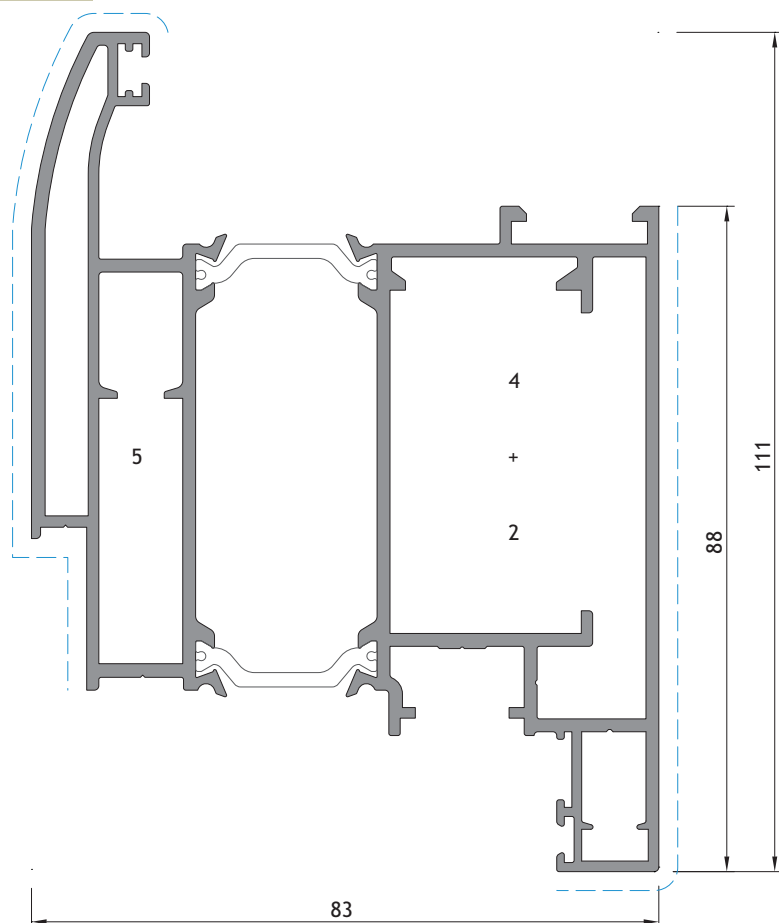

OT 88

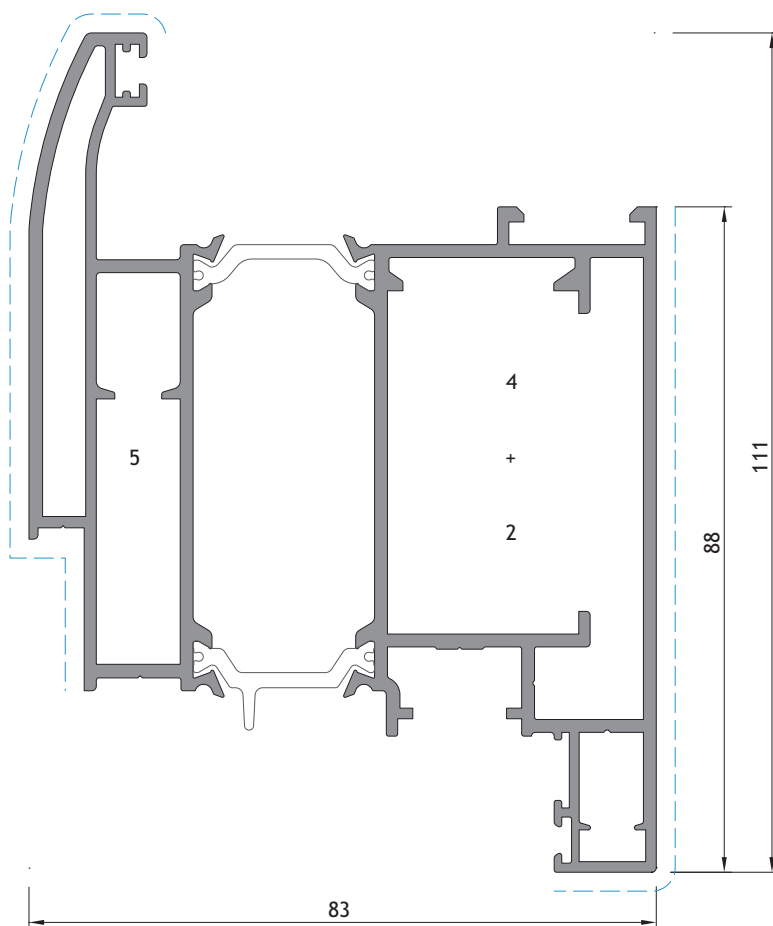

OT 89

1 - ESQUADRO 18-1123-C
4 - ESQUADRO SA 35 CORTADO PEQ.

2 - ESQUADRO AT PEQ. PEQUENO
5 - ESQUADRO 18-1135-C

3 - ESQUADRO 18-1112-C
6 - UNIÃO TRAVESSA SA2001 G

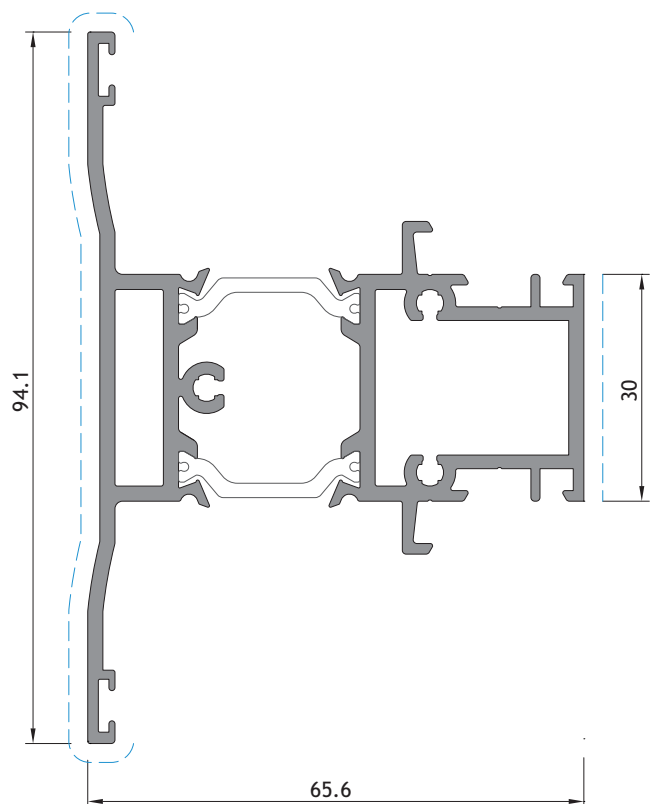

OT 20

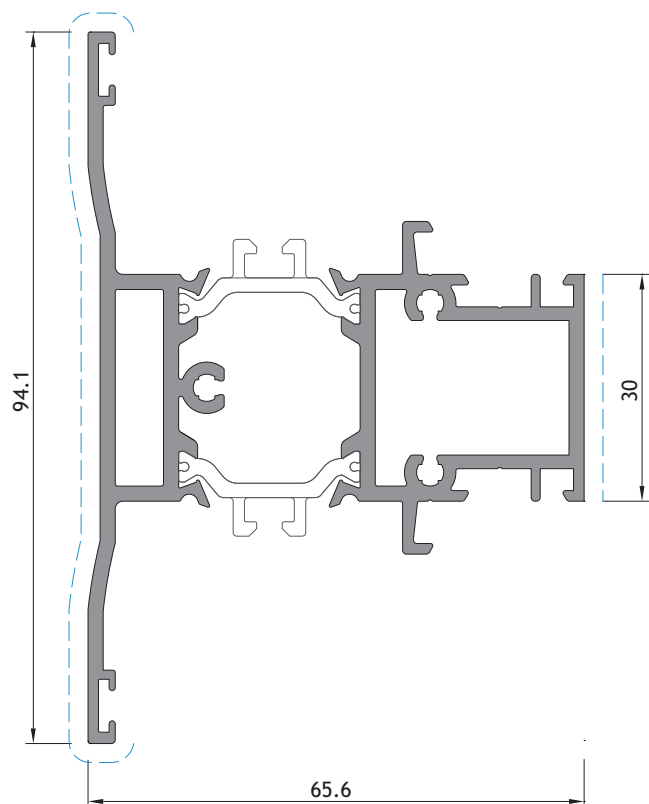

OT 22

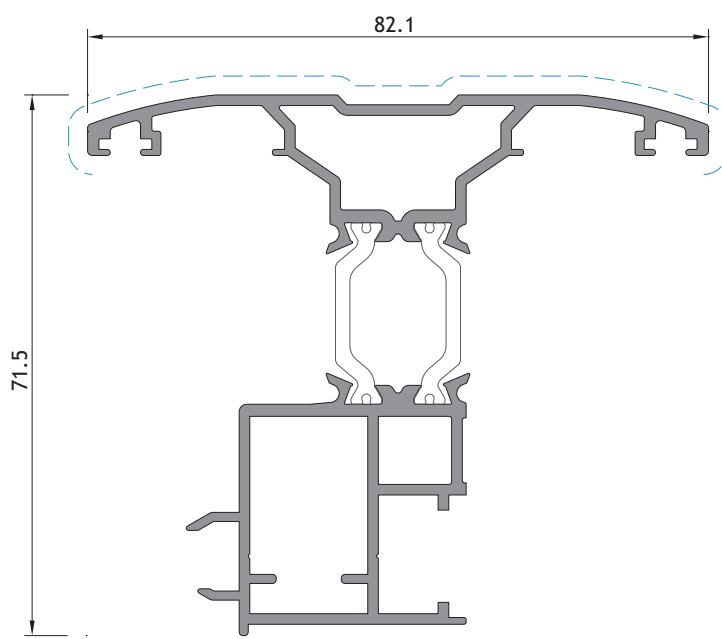

OT 06

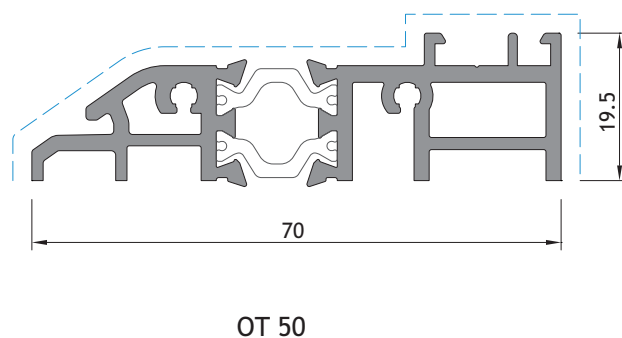
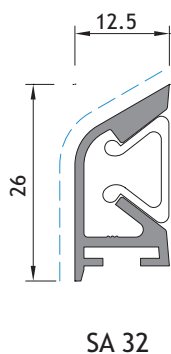
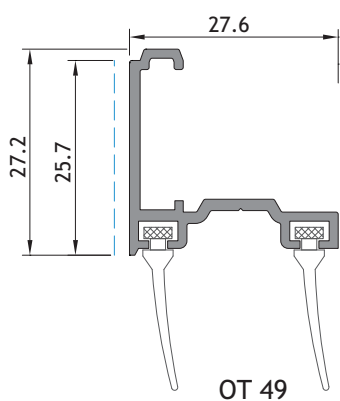
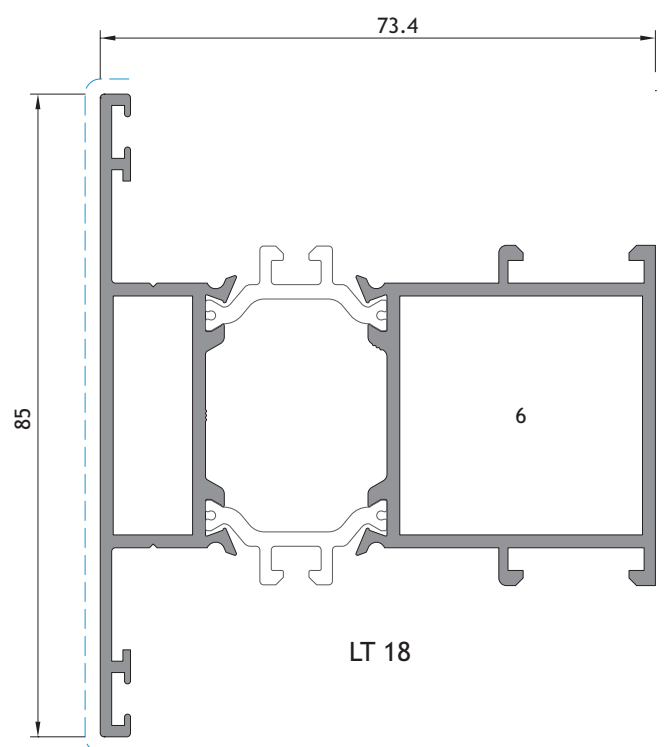
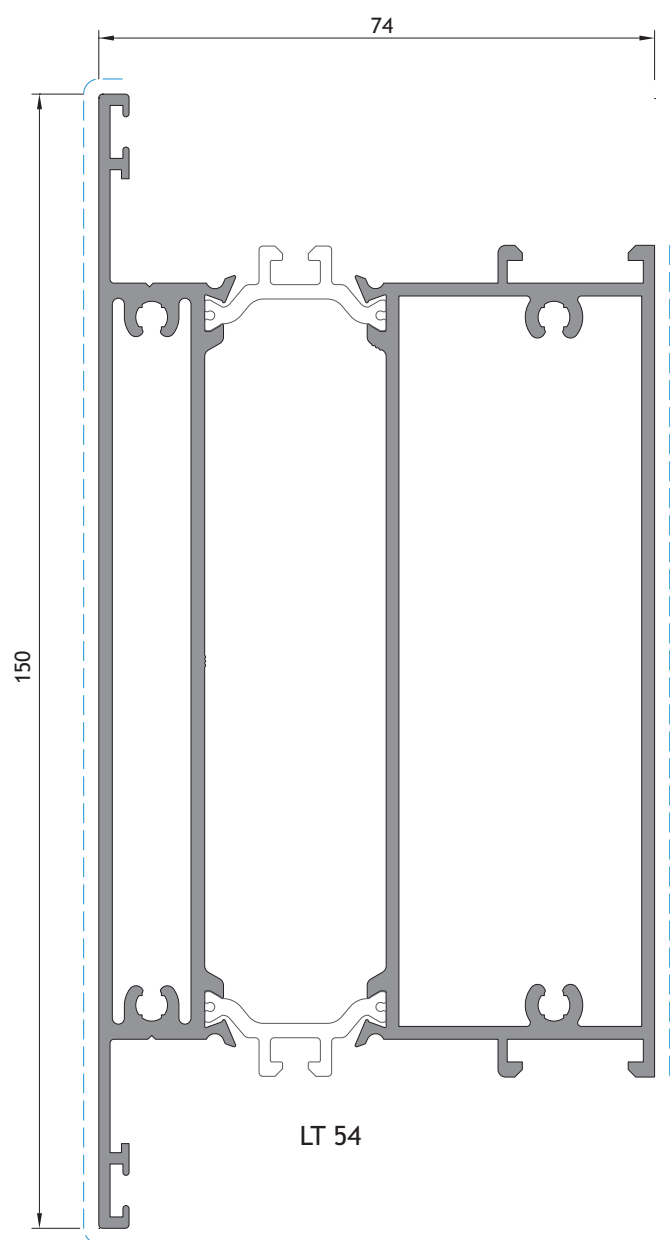

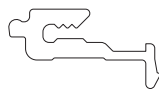
**MOLA BITE FOLHA OT**

Para aro fixo | For fixed frame | Pour cadre dormant

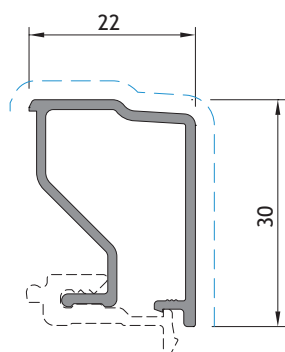

OT 92

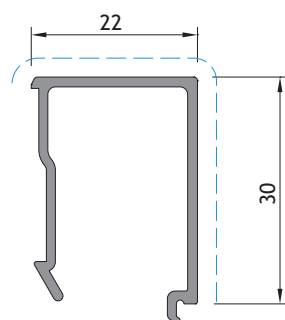

OT 93

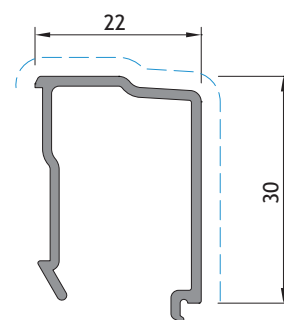

OT 94

**MOLA EURO 2000**

Para aro móvel | For mobile frame | Pour cadre ouvrant

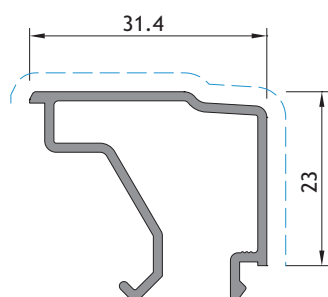

OT 96

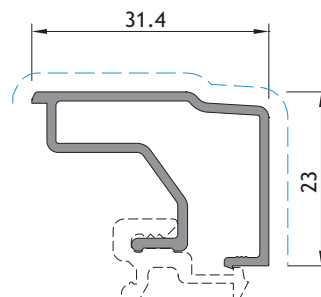

OT 97

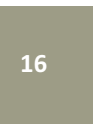

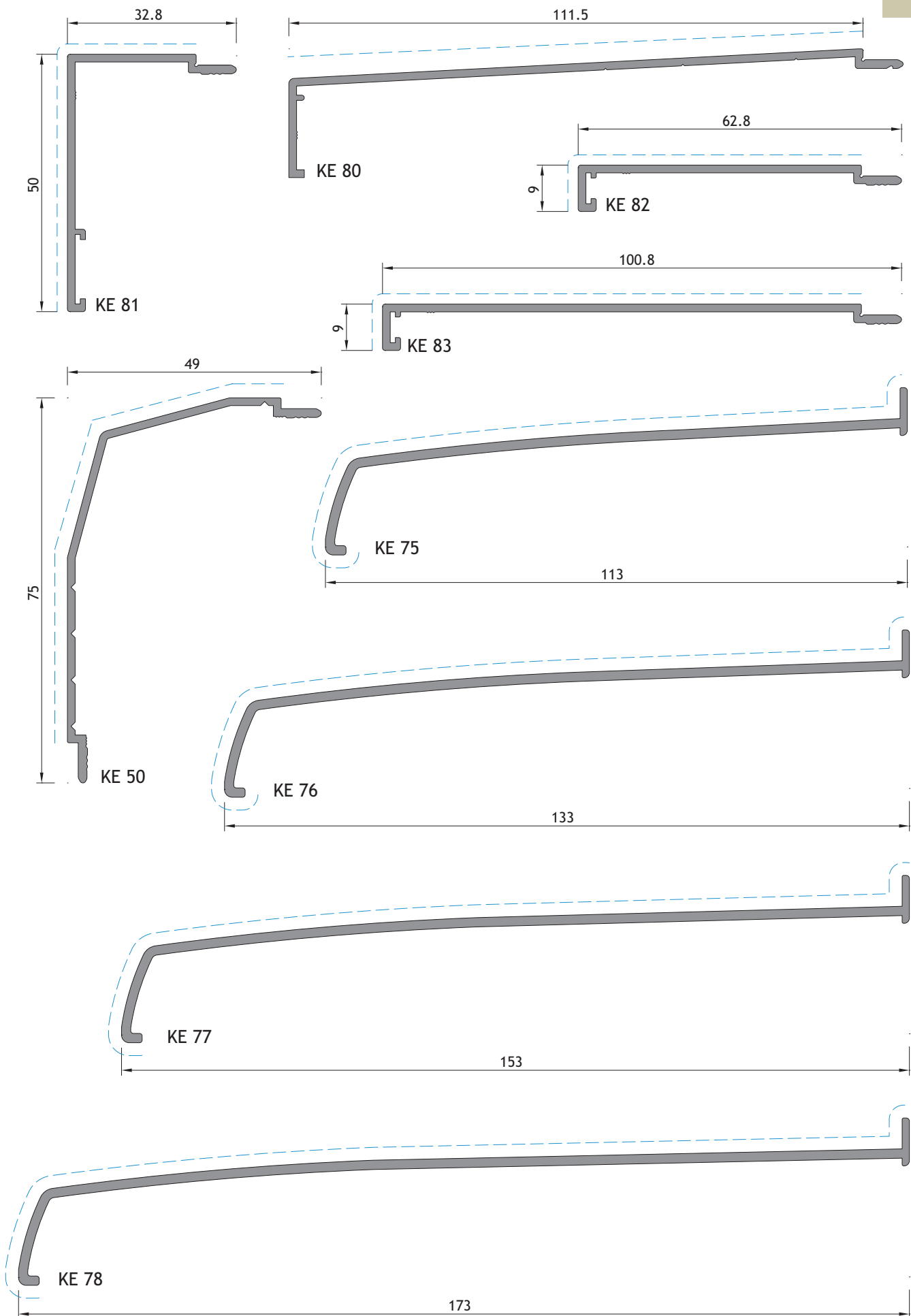

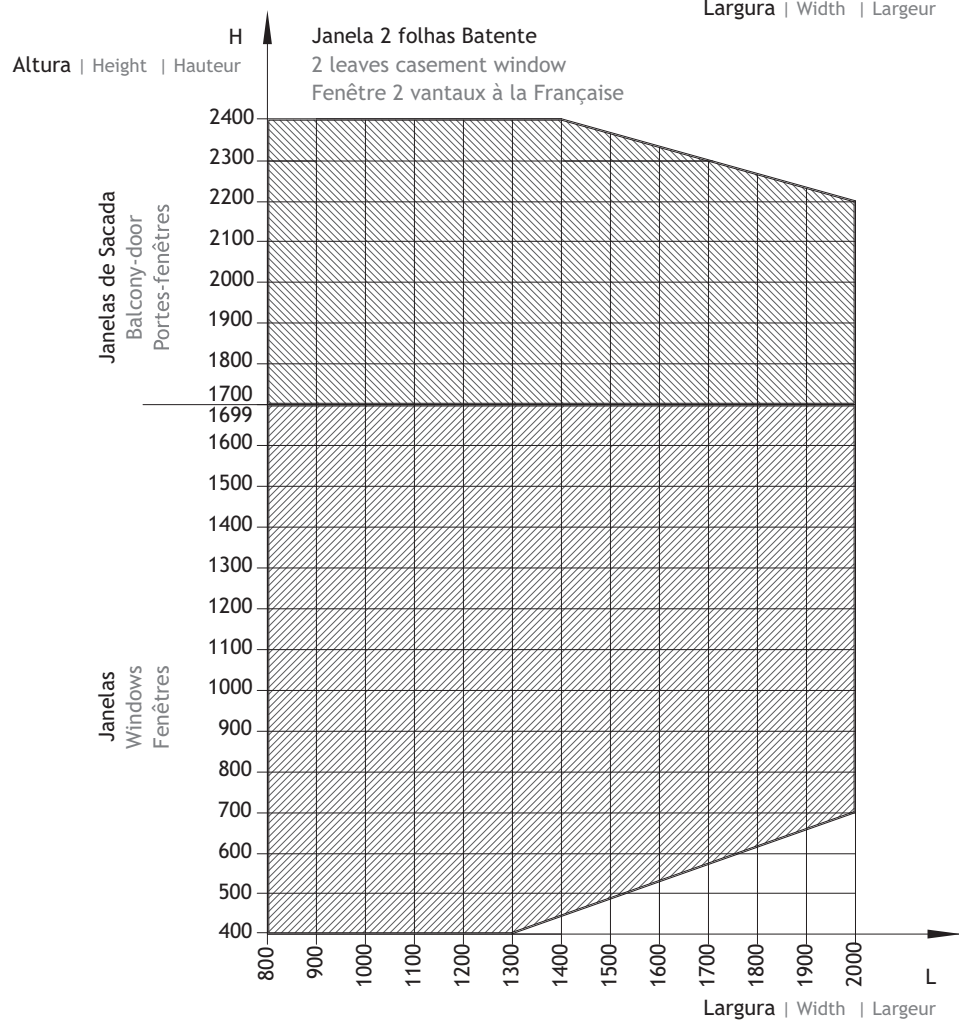
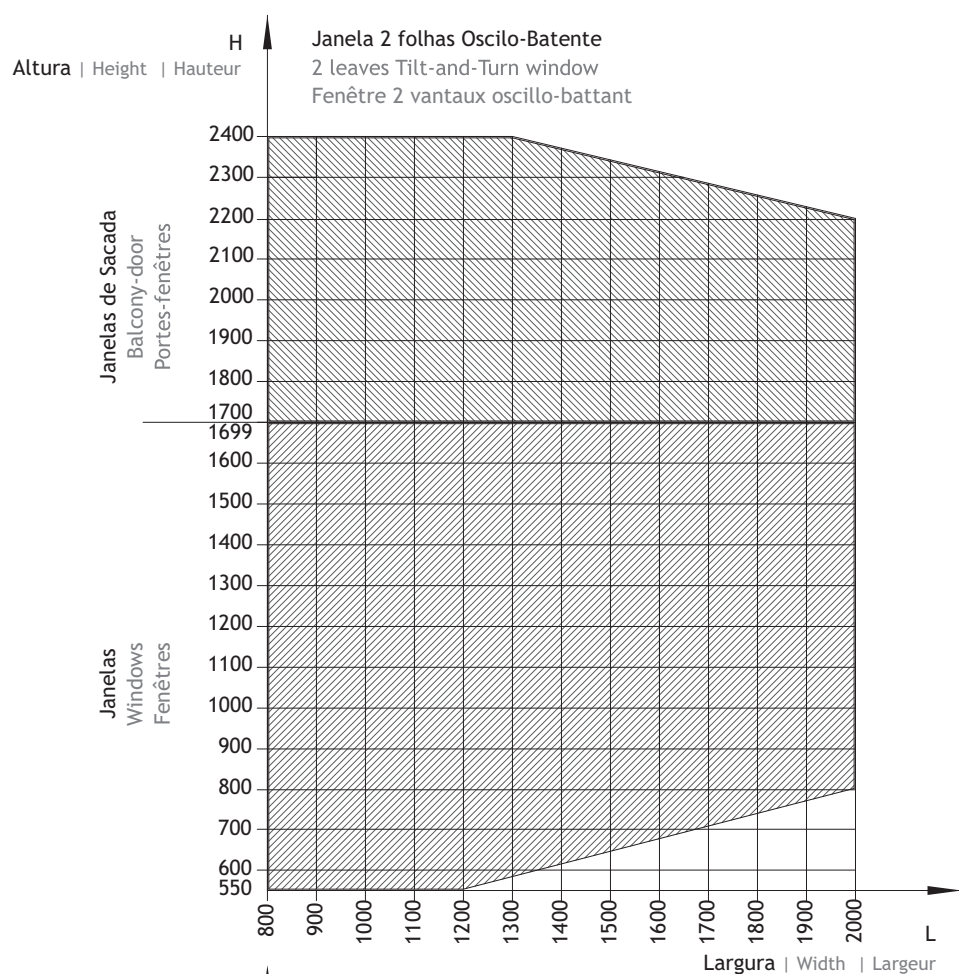



Acessórios

Accessories

Accessoires







2001

Material: EPDM
(Caixa: 8 rolos x 50m)

2051

Material com 2 durezas
(Zona de batente: E.P.D.M. esponjoso)
(Base: E.P.D.M. de 70° SHORE)
(Rolo: 300m (150m+150m))

2071

Material: EPDM, 2 durezas
(Caixa: 300m)208274
208008
208143JUNTA DE ESTANQUIDADE 2001
JUNTA DE ESTANQUIDADE 2051
JUNTA DE ESTANQUIDADE 2071

2003

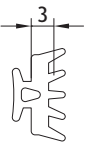
Material: EPDM
Rolo: 100m

2055

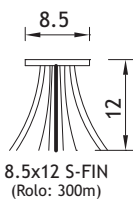
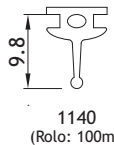
Material: EPDM
Rolo: 200m208350
208289JUNTA DE VEDAÇÃO EXTERIOR 2003
JUNTA DE BATENTE 20558.5x12 S-FIN
(Rolo: 300m)1140
(Rolo: 100m)

Para o perfil SA32

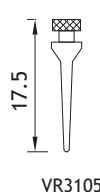
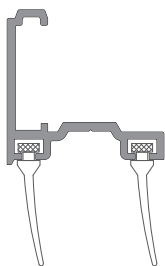
208464
208246JUNTA PELÚCIA 8.5x12 S-FIN
JUNTA ENCAIXE 1140 PRT

VR3105

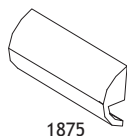

VR3180

VR 3105 = Junta de 2 durezas em PVC para o perfil SB 32
VR 3180 = Junta de 2 durezas em PVC para o perfil SB 32
- Alternativa à Junta VR3105 no exterior208292
208294JUNTA INFERIOR PORTA VR3105
JUNTA INFERIOR PORTA VR3180

1875

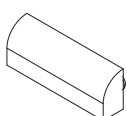
1875.1.x
1875.1.74 - Preto
1875.1.78 - Branco

SOS

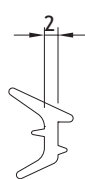
210154
210280GOTEIRA 1875 Br/Pr
GOTEIRA SOS C/ VÁLV. Br/Pr.210142
210144GOT. C/VÁLV. 1875.1.74
GOT. C/VÁLV. 1875.1.78

2042

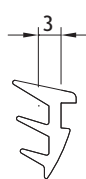

2073



2034



2035



2037

Material: EPDM
Rolo: 200m208191 JUNTA DE CUNHA 2042
208195 JUNTA DE CUNHA 2034208196 JUNTA DE CUNHA 2035
208904 JUNTA DE CUNHA 2037
208199 JUNTA DE CUNHA 2073Material: EPDM
Rolo: 200m

208278

JUNTA DE ESTANQUIDADE 2112

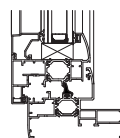

Para os perfis OT 03, 43, 53, 62, 63 e 73

208210

JUNTA VD 2705

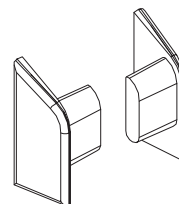

212346

CONJ. TAPA-TOPOS SA 32 Br/Pr

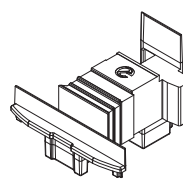

ESQUERDA

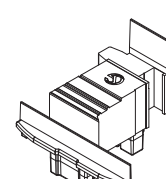

DIREITA

212058

CONJ. TOPO INVERSOR OT-Ocultar (Pr)

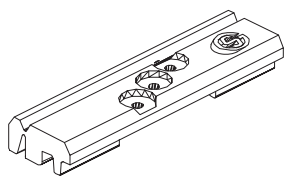

218194

CALÇO P/VIDRO EURO 2000 Nylon

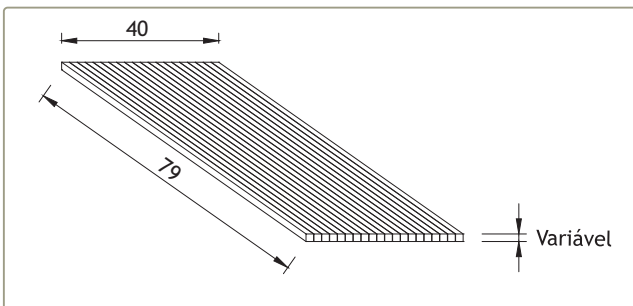

218113
218109

CALÇO P/VIDRO 79x40x2
CALÇO P/VIDRO 79x40x3

218111
218112

CALÇO P/VIDRO 79x40x4
CALÇO P/VIDRO 79x49x5

Variável

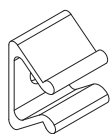

MOLA P/PINGADEIRA
(Para o perfil SA 32)

228181
228165

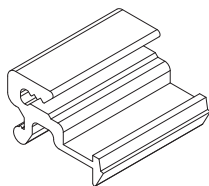

MOLA EURO 2000
(Para os bites SA)

MOLA PARA PINGADEIRA
MOLA EURO 2000

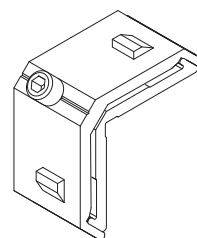

Para os perfis OT 01, 02, 03, 05, 41, 43, 51, 53, 61, 63, 71, 73 e 86

204133

ESQUADRO 18-1123-C

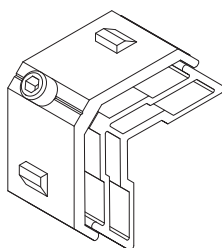

Para os perfis OT 60, 62, 88 e 89

204728

ESQUADRO AT E. PEQUENO

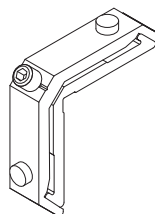

Para os perfis OT 85 e OT 86

204901

ESQUADRO 18-1112-C

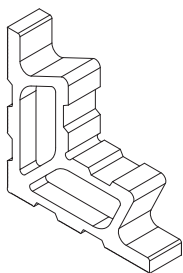

Para o perfil OT 88 e OT 89

204256

ESQUADRO SA 35 CORTADO PEQUENO

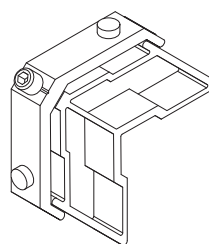

Para os perfis OT 88 e OT 89

204902

ESQUADRO 18-1135-C

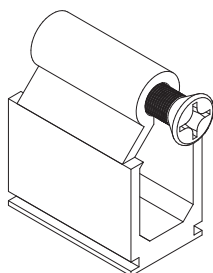

Para o perfil LT 18

232116
290037

UNIÃO TRAVESSAS SA2001 G
PARAFUSO SUPLEMENTAR P/UNIÃO SA2001 G INOX

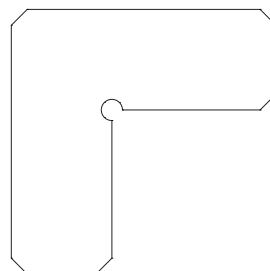

213246

CANTO CR S/SB

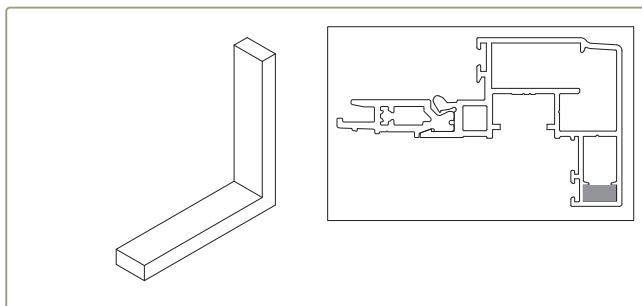

213267

CANTO ALINHAMENTO N°1 OT

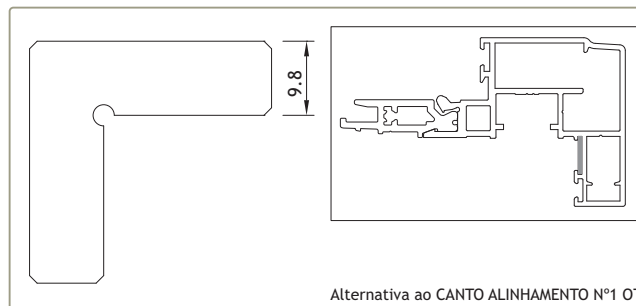

Alternativa ao CANTO ALINHAMENTO N°1 OT

213269

CANTO ALINHAMENTO N°2 OT

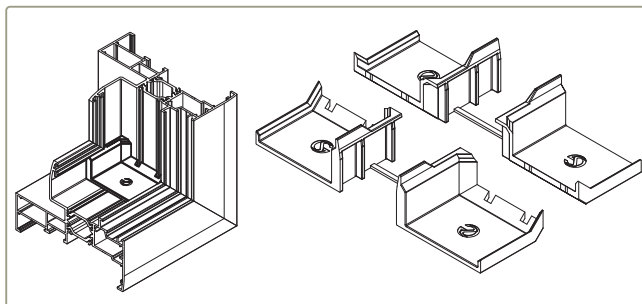

212059

CONJUNTO CANTOS ALINHAMENTO P/ AROS FIXOS OT

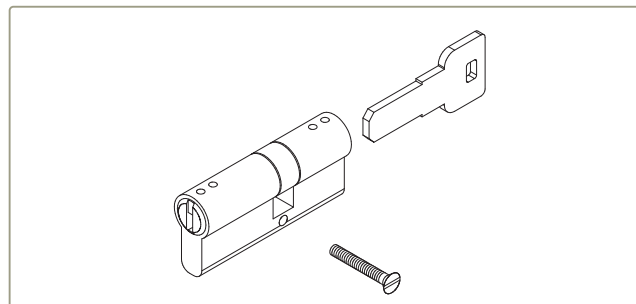

207403

CILINDRO SEGURANÇA 60/30

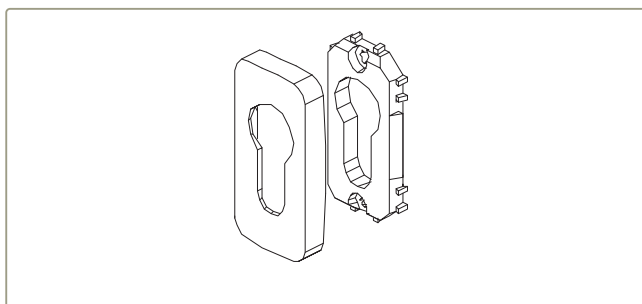

220190

ESPELHO 874.801 (Br./Pr.)

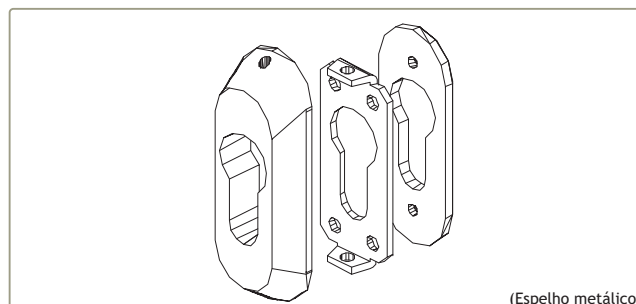

(Espelho metálico)

220008

ESPELHO PARA SEGURANÇA 5100 (Pr.)



212640

ACIONADOR 40837Z

Alimentação: 220V-230V
Curso de abertura: 500mm
Força de abertura: 300N
Potência: 50W
Classe de proteção: IP 30
Cores: Cinza, Branco ou Preto



212036

ACIONADOR ELÉCTRICO DUPLO 240Vac 40989D(Nat.)

Accionador para janelas projetantes e basculantes
Voltagem: 100Vac - 240Vac
Inversão de marcha: por inversão de polaridade
Abertura: 500mm
Força: 600N
Classe de proteção: IP 30
Cores: Natural, Preto, Branco



230018

SUPORTE PARA MOTOR 40858U

Cores: Natural, Preto, Branco



230463

SUPORTE PARA ACION. ELÉC. DUPLO 41101H(Nat.)

Cores: Natural, Preto, Branco



230309

SUORTE DE FIXAÇÃO 90m



213257

ÂNGULO DE FIXAÇÃO 90mm



230014

SUORTE DE FIXAÇÃO 100mm



213239

ÂNGULO DE FIXAÇÃO 100mm



230019

SUORTE DE FIXAÇÃO 120mm



213240

ÂNGULO DE FIXAÇÃO 120mm



230308

SUORTE DE FIXAÇÃO 140mm



213256

ÂNGULO DE FIXAÇÃO 140mm



Presilha M6 x 37 mm
(Aplicar com os perfis AT 31, AT 60, AT 61 e AT 81)

207220

PRESILHA M6 x 37mm



Presilha M6 x 17 mm
(Aplicar com os perfis AT 41, AT 51, AT 47, AT 57e DT 57)

207203

PRESILHA M6 x 17mm

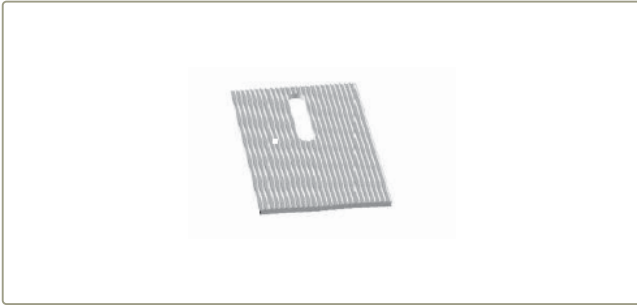

218116

CALÇO SEPARADOR (50 x 70mm)

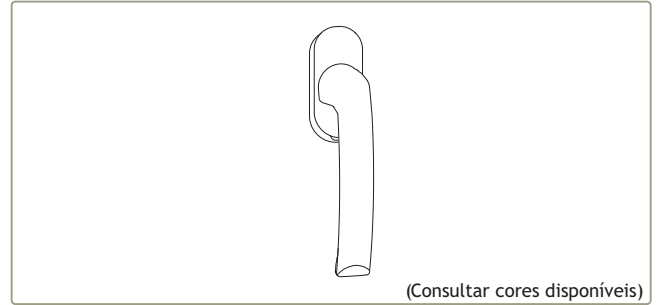

200211

(Consultar cores disponíveis)

CREMONE HPMAN739

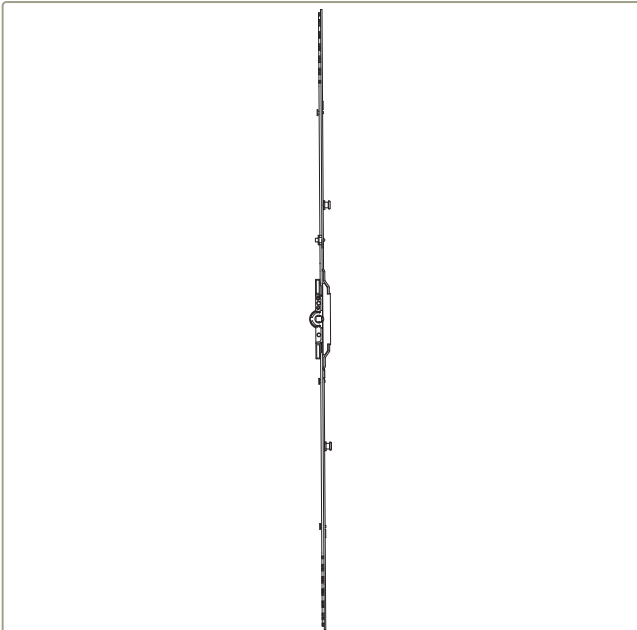

211105 FERRAGEM CREMONE cota va. AG.7 GR.20(260-600) TS AF
211106 FERRAGEM CREMONE cota va. AG.7 GR.60(601-1000) TS AF
211107 FERRAGEM CREMONE cota va. AG.7 GR.80(801-1200) TS AF
211108 FERRAGEM CREMONE cota va. AG.7 GR.120(1201-1600) TS AF
211109 FERRAGEM CREMONE cota va. AG.7 GR.160(1601-2000) TS AF
211111 FERRAGEM CREMONE cota va. AG.7 GR.200(2001-2400) TS AF

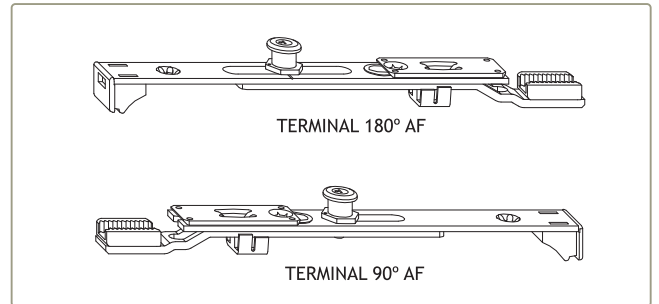

206507
206506

TERMINAL 180° AF
TERMINAL 90° AF

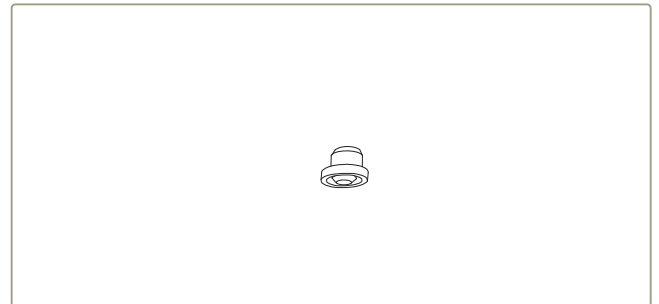

207157

PERNO PARA PONTO DE FECHO DE COMPASSO AF

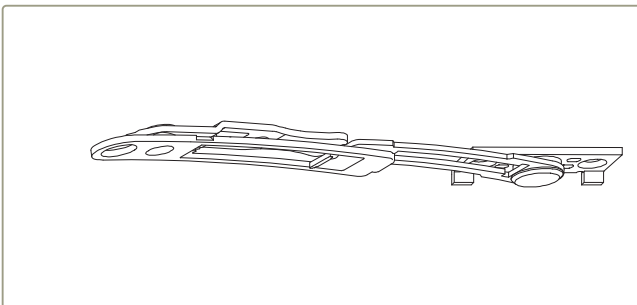

202054

COMPASSO BASCULANTE TELESCÓPICO AF

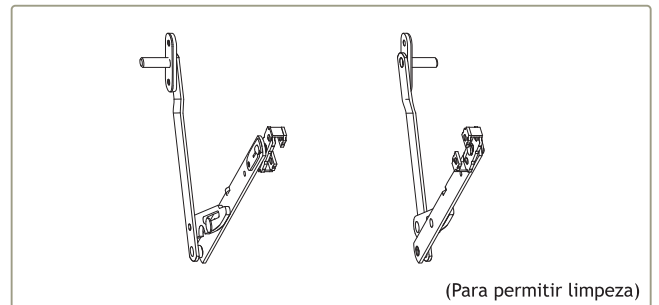

(Para permitir limpeza)

202027
202028
202029
202030

COMPASSO DIREITO HBB 350-500mm AF
COMPASSO ESQUERDO HBB 350-500mm AF
COMPASSO DIREITO HBB 501-800mm AF
COMPASSO ESQUERDO HBB 501-800mm AF

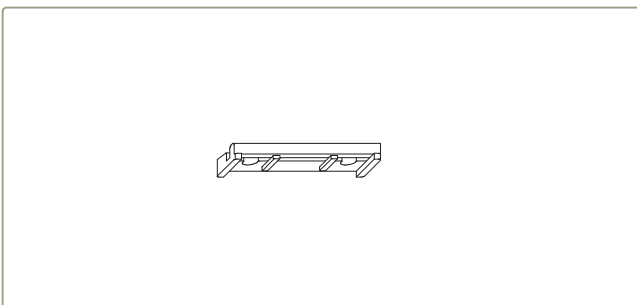

299004

DISTANCIADOR PARA COMPASSO BASCULANTE 380 AF

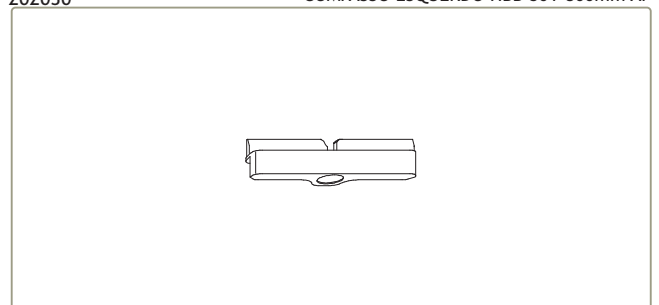

202092

CONTRA-FECHO AF

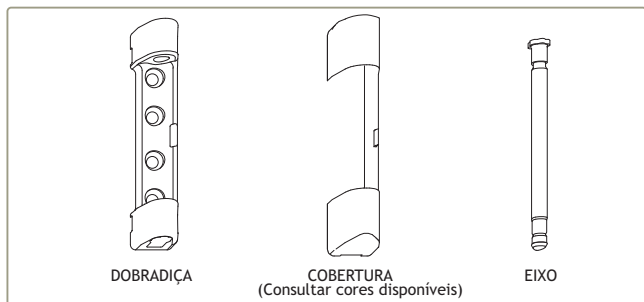

202024 DOBRADIÇA PARA BASCULANTE ARO FIXO AF
214240 COBERTURA PARA DOBRADIÇA ARO FIXO AF
220011 EIXO PARA DOBRADIÇA SUP. AF

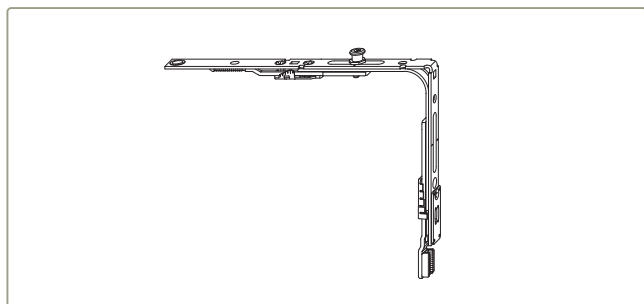

213250 ÂNGULO REENVIO SUP. FOLHA ATIVA LBB 350-1560 AF

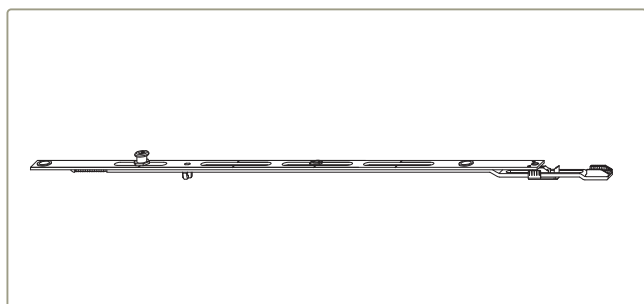

211100 PROLONGADOR TIRANTE TS AF 180
211250 PROLONGADOR TIRANTE TS AF 190
211251 PROLONGADOR TIRANTE TS AF 200

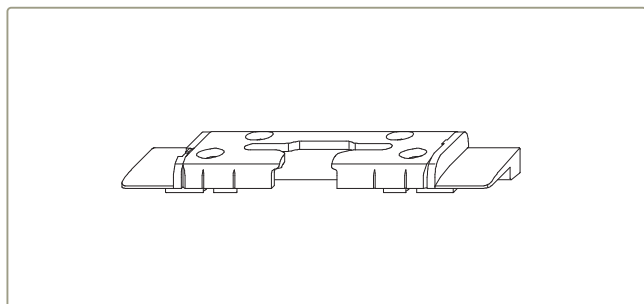

201042 CONTRA-FECHO INFERIOR DIREITO AF
201043 CONTRA-FECHO INFERIOR ESQUERDO AF

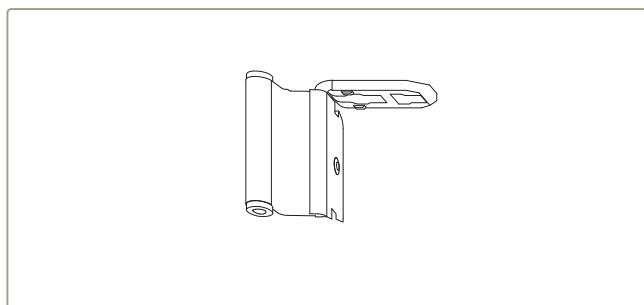

202025 DOBRADIÇA SUPERIOR ARO MÓVEL AF

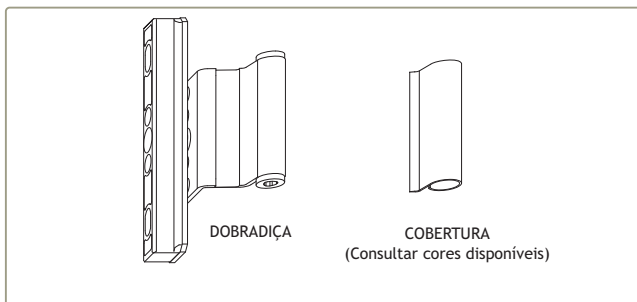

202023 DOBRADIÇA PARA BASCULANTE ARO MÓVEL AF
214241 COBERTURA PARA DOBRADIÇA ARO MÓVEL AF

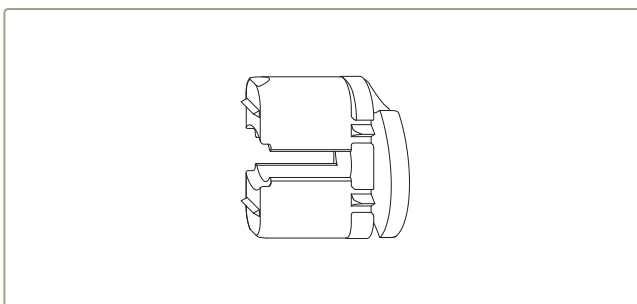

228105 LIMITADOR DE CURSO DE CREMONE 180° PARA 90° AF

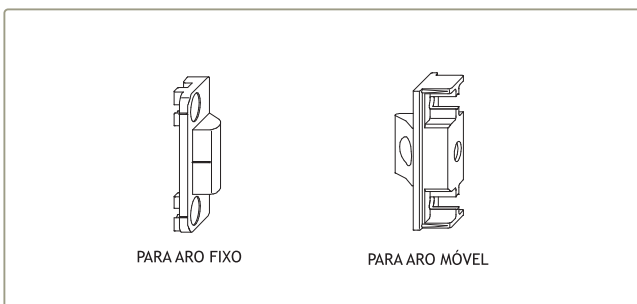

211541 FECHO OCULTO - ARO FIXO
211542 FECHO OCULTO - ARO MÓVEL

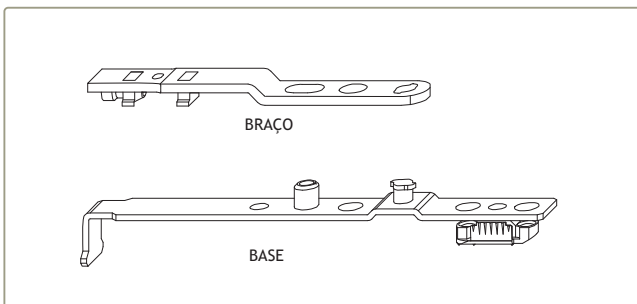

299006 BRAÇO FALSO COMPASSO AF
228011 BASE FALSO COMPASSO AF

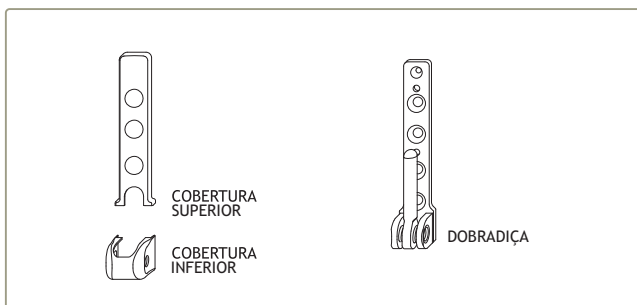

202022 DOBRADIÇA INFERIOR ARO FIXO KF TS AF
214239 COBERTURA SUPERIOR P/ DOB. INF. ARO FIXO AF
214238 COBERTURA INFERIOR P/ DOB. INF. ARO FIXO AF

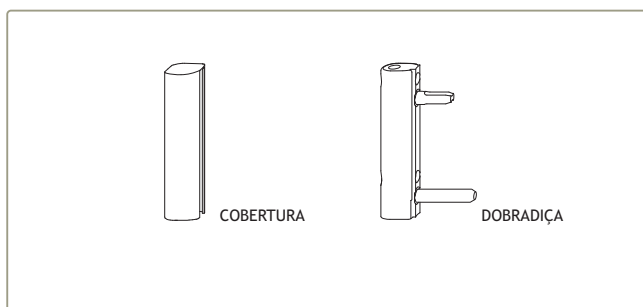

202021
214237

DOBRADIÇA INFERIOR FOLHA AF
COBERTURA SUPERIOR P/ DOB. INF. FOLHA AF

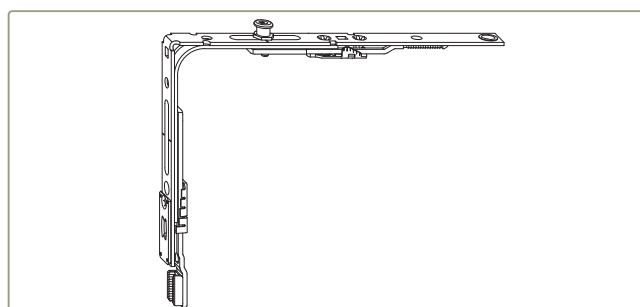

213243

ÂNGULO REENVIO SUPERIOR FOLHA ATIVA TS AF

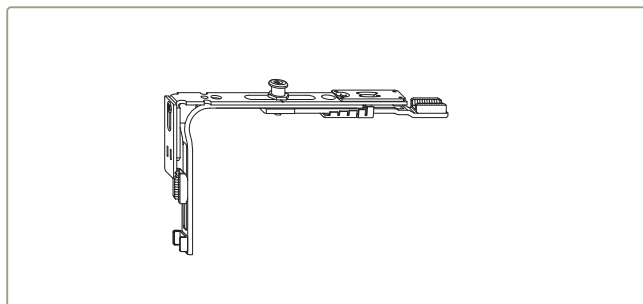

213245

ÂNGULO REENVIO SUPERIOR CURTO FOLHA ATIVA TS AF

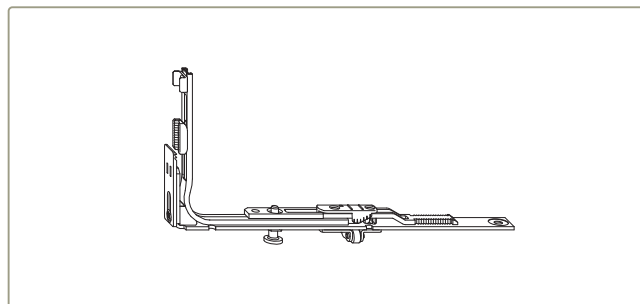

213253

ÂNGULO REENVIO BASCULANTE INFERIOR PEQUENO TS AF

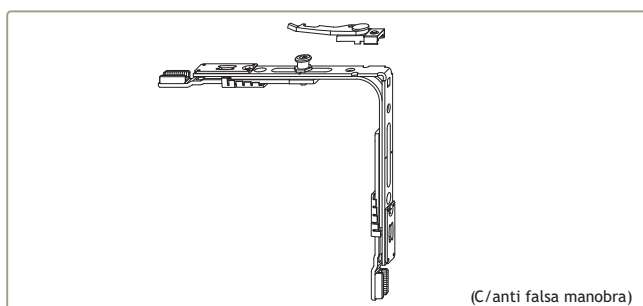

213294
213296

ÂNGULO REENVIO SUPERIOR DIREITO TS AF
ÂNGULO REENVIO SUPERIOR ESQUERDO TS AF

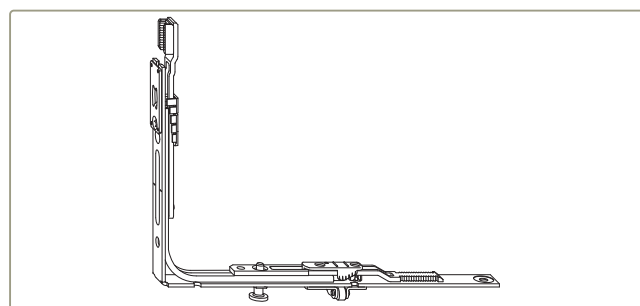

213251

ÂNGULO REENVIO BASCULANTE INFERIOR TS AF

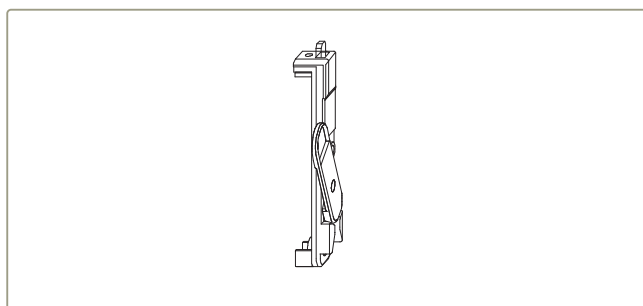

225003

PASSADOR 2ª FOLHA AF

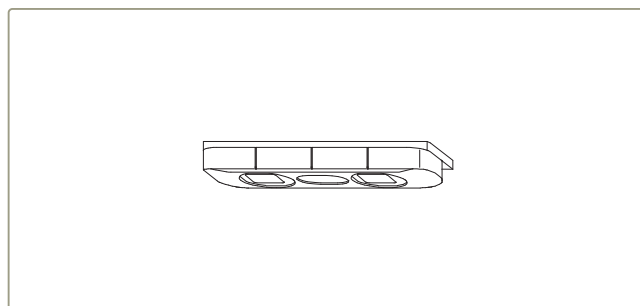

211543

CONTRA-FECHO AF PARA PASSADOR 2ª FOLHA

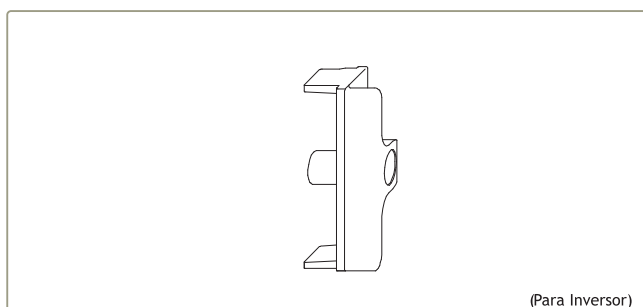

202074

CONTRA-FECHO 2000 AF

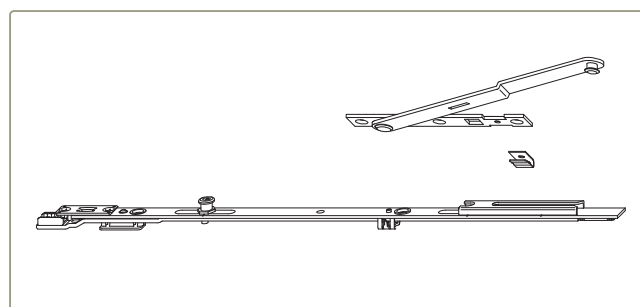

202035

COMPASSO ADICIONAL 1 RS AF TS

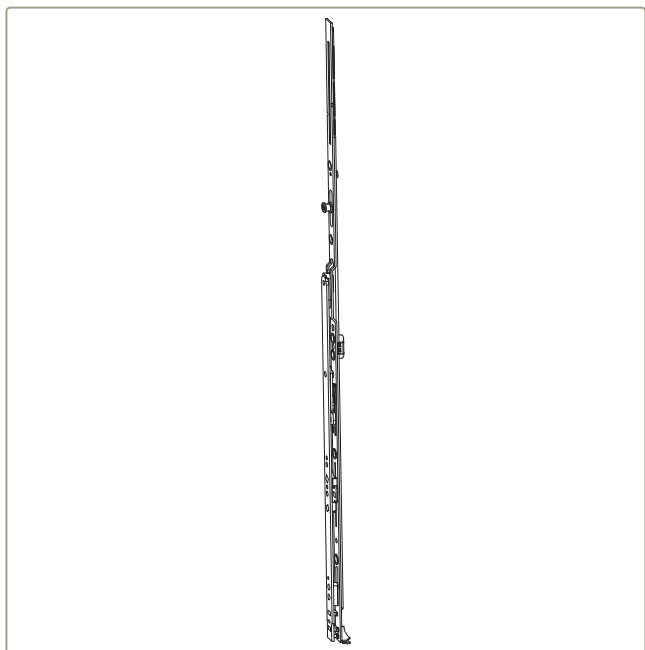

202070
202071
202072
202031
202033

COMPASSO GR. 0 TS AF
COMPASSO GR. 1 TS AF
COMPASSO GR. 2 TS AF
COMPASSO GR. 3 TS AF
COMPASSO GR. 4 TS AF



213241
213293

ÂNGULO REENVIO TIRANTE 801-1200 GR.1 TS AF
ÂNGULO REENVIO TIRANTE 1201-2360 GR.2 TS AF

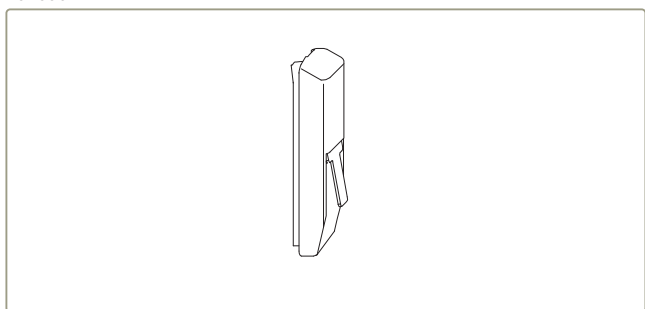

228118

MECANISMO ANTI FALSA MANOBRA AF

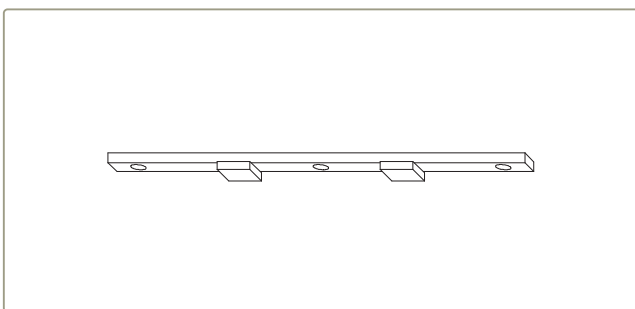

299005

DISTANCIADOR DE COMPASSO ADICIONAL AF

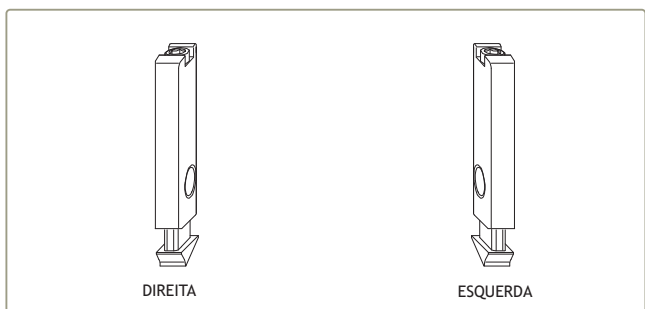

201272
201273

FECHO DE RETENÇÃO PARA SACADA DIREITA AF
FECHO DE RETENÇÃO PARA SACADA ESQUERDA AF



215015
215016

ALAVANCA DE PRESSÃO ANTI FALSA MANOBRA DIR. AF
ALAVANCA DE PRESSÃO ANTI FALSA MANOBRA ESQ. AF

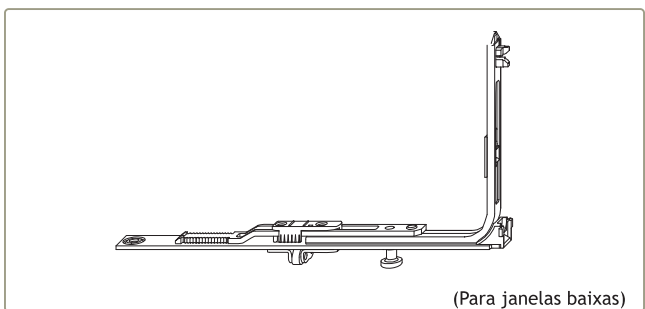

213271

ÂNGULO REENVIO INFERIOR AF
(Para janelas baixas)

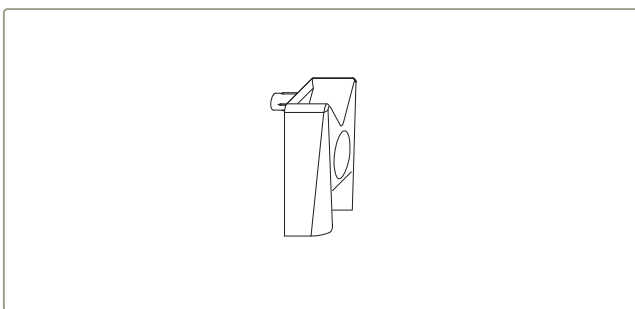

202079

CONTRA-FECHO DE RETENÇÃO PARA SACADA

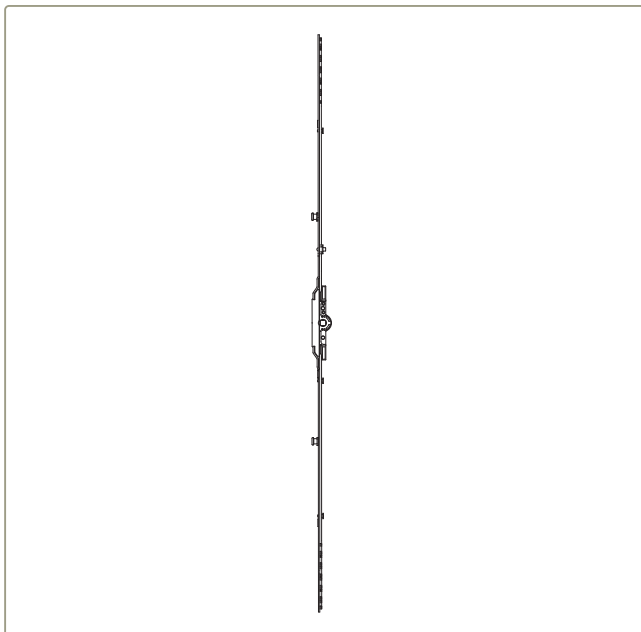

211105 FERRAGEM CREMONE cota va. AG.7 GR.20(260-600) TS AF
 211106 FERRAGEM CREMONE cota va. AG.7 GR.60(601-1000) TS AF
 211107 FERRAGEM CREMONE cota va. AG.7 GR.80(801-1200) TS AF
 211108 FERRAGEM CREMONE cota va. AG.7 GR.120(1201-1600) TS AF
 211109 FERRAGEM CREMONE cota va. AG.7 GR.160(1601-2000) TS AF
 211111 FERRAGEM CREMONE cota va. AG.7 GR.200(2001-2400) TS AF

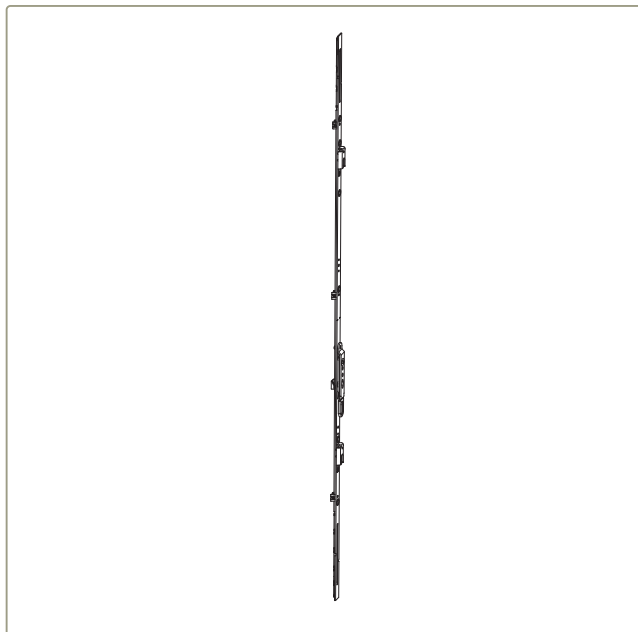

211112 FERRAGEM DE ALAVANCA 2ª FOLHA GR.80 HBB 801-1200 AF
 211113 FERRAGEM DE ALAVANCA 2ª FOLHA GR.120 HBB 1201-1600 AF
 211114 FERRAGEM DE ALAVANCA 2ª FOLHA GR.160 HBB 1601-2000 AF
 211115 FERRAGEM DE ALAVANCA 2ª FOLHA GR.200 HBB 2001-2360 AF



Junta de vedação elástica, resistente aos UV
 Impede a corrosão de penetrar pelas zonas cortadas

208019 SELA JUNTAS 150gr. (Cinza)



Limpeza de alumínio lacado ou anodizado
 Para preparação das zonas a serem unidas e limpeza final

208704 PRODUTO DE LIMPEZA DE ALUMÍNIO (1L) Transparente



(Cota fixa)

211117 FERRAGEM DE ALAVANCA 2ª FOLHA GR.30 HBB 410-600 AF
 211118 FERRAGEM DE ALAVANCA 2ª FOLHA GR.60 HBB 601-800 AF

Porta 2 folhas

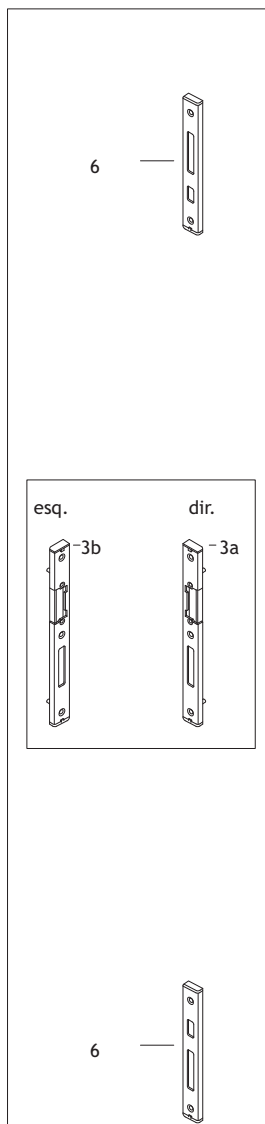

Porta 1 folha

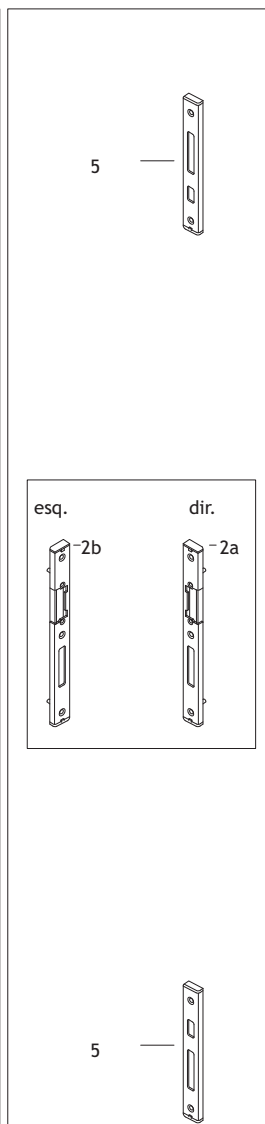

4

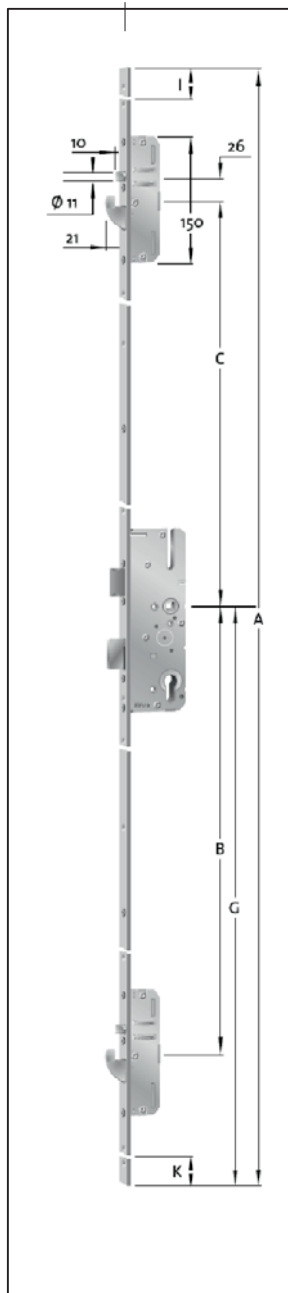

2	a	280018	TESTA CENTRAL 7/8 DIR. (aro fixo)
	b	280017	TESTA CENTRAL 7/8 ESQ. (aro fixo)
4		201048	FECHADURA AUTOMÁTICA MULTIPONTO 45/92 CA 1900-2200
5		280019	TESTA SUP./INF. P/ FECHADURA AUTOMÁTICA (aro fixo)
6		280020	TESTA SUP./INF. P/ FECHADURA AUTOMÁTICA 2ª FOLHA (inversor)
14		207403	CILINDRO SEGURANÇA 60/30
3	a	280023	TESTA CENTRAL 2ª FOLHA BATENTE DIR. (inversor)
	b	280022	TESTA CENTRAL 2ª FOLHA BATENTE ESQ. (inversor)

FECHADURA MULTI-PONTO CV50 45/92 2200MM

Porta 2 folhas

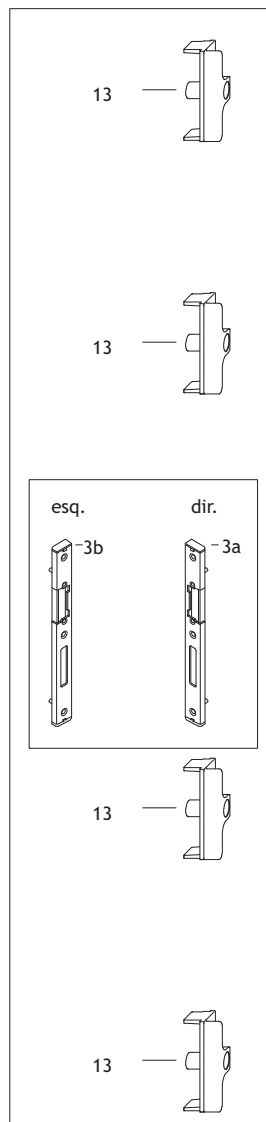

Porta 1 folha

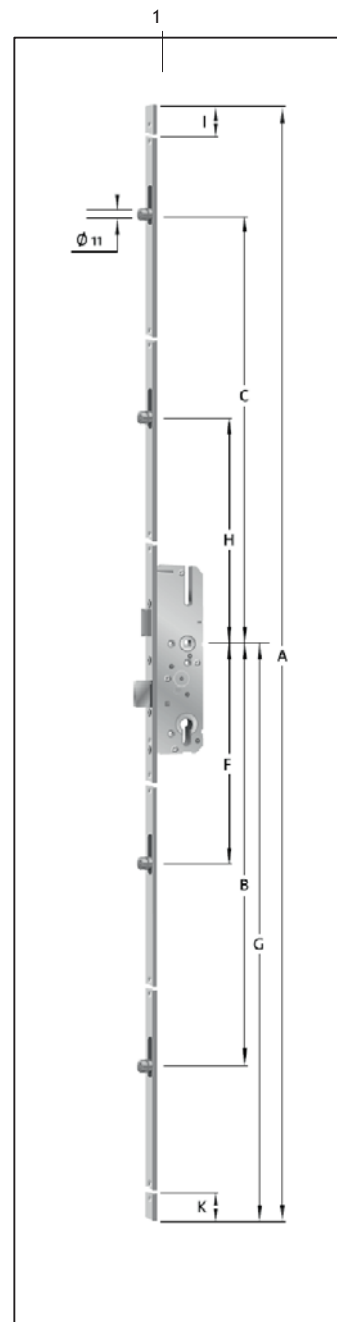
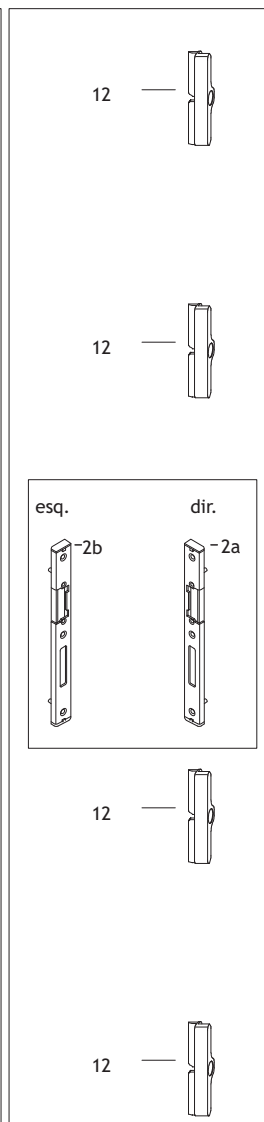

Medidas	Testa 16mm	Entrada 45mm
---------	---------------	-----------------

Medidas (mm)	A	B	C	F	G	H	I	K
	2170	823	810	410	1020	260	260	137

1		201047	FECHADURA MULTI-PONTO CV50 45/92 2200mm
2	a	280018	TESTA CENTRAL 7/8 DIR. (aro fixo)
	b	280017	TESTA CENTRAL 7/8 ESQ. (aro fixo)
12		211507	PONTO DE FECHO ARO FIXO PARA FECHADURA (aro fixo)
13		211508	PONTO DE FECHO INVERSOR 2ª FOLHA PARA FECHADURA (inversor)
14		207403	CILINDRO SEGURANÇA 60/30
3	a	280023	TESTA CENTRAL 2ª FOLHA BATENTE DIR. (inversor)
	b	280022	TESTA CENTRAL 2ª FOLHA BATENTE ESQ. (inversor)





Pormenores de montagem

Assembly details
Détails d'assemblage





MEDIDAS DO CAIXILHO A PARTIR DA MEDIDA DO VÃO

FRAME MEASURES FROM THE MEASURES OF THE WALL

MESURES DU CADRE À PARTIR DE LA MESURE DU MUR

Hp
(Altura do vão)
(Hole height)
(Hauteur du trou)

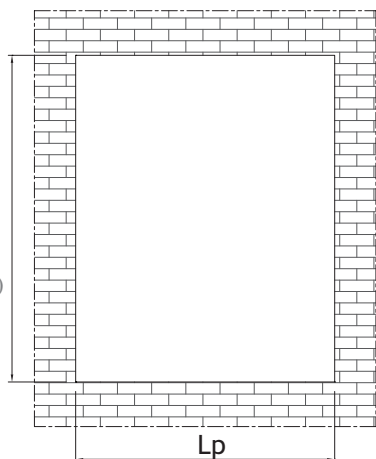

Lp
(Largura do vão)
(Hole width)
(Largeur du trou)

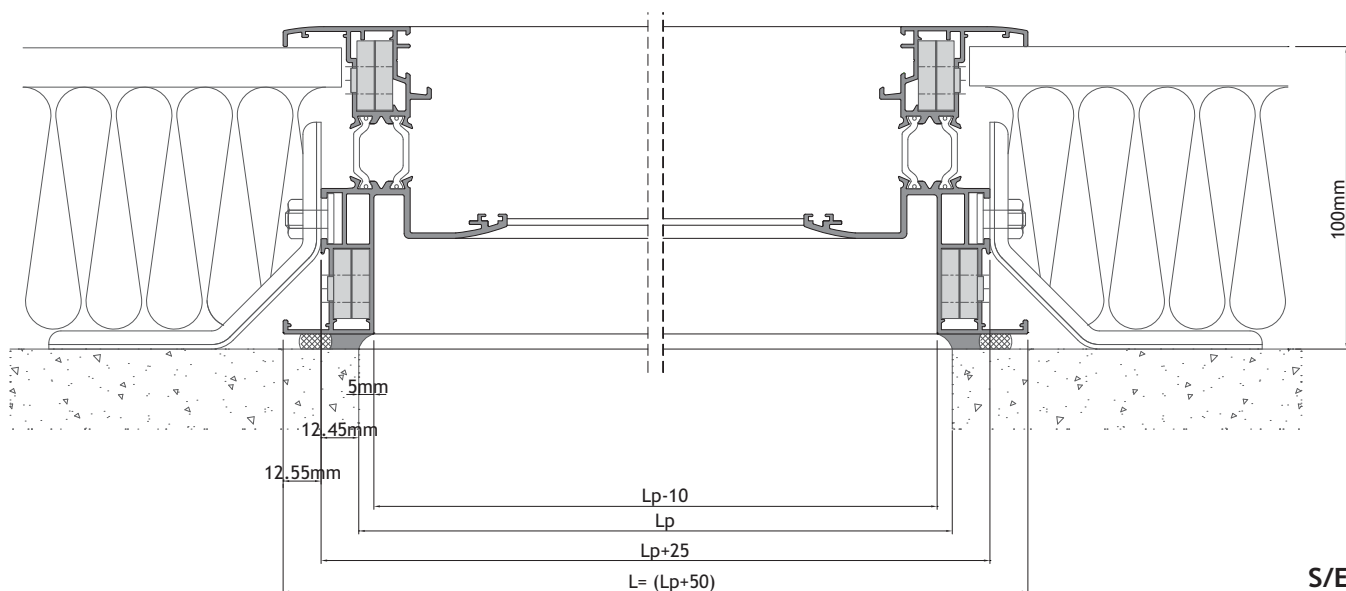
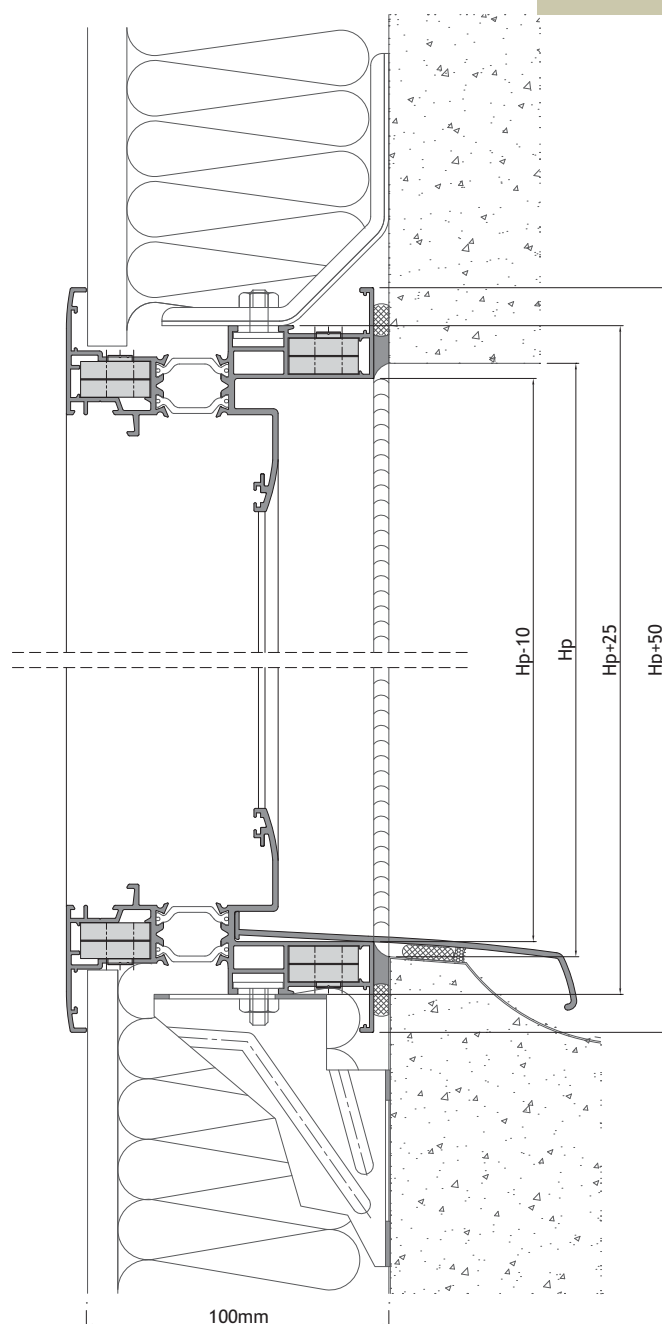

S/ESC.

JANELA DE 1 FOLHA - LINHA OCULTA

1 LEAF CASEMENT WINDOW - LINE CONCEALED

FENÊTRE À LA FRANÇAISE 1 VANTAIL - LIGNE CACHÉ

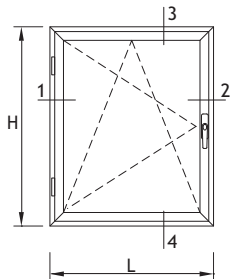

PERFIS - JANELA DE 1 FOLHA PROFILES - 1 LEAF WINDOW PROFILS - FENÊTRE À 1 VANTAIL				
REFERÊNCIA REFERENCE	CORTE HORIZONTAL HORIZONTAL DETAIL DÉTAIL HORIZONTAL	CORTE VERTICAL VERTICAL DETAIL DÉTAIL VERTICALE	QUANTIDADE QUANTITY QUANTITÉ	CORTE CUT COUPÉ
OT-01	L	H	2+2	
OT-05	L-72	H-72	2+2	
OT-95	L-118	H-118	2+2	
KE-75	L-60	-----	1	

ACESSÓRIOS ACCESSORIES ACCESSOIRES		
CÓDIGO CODE	DESIGNAÇÃO DESIGNATION DÉSIGNATION	QUANTIDADE QUANTITY QUANTITÉ
204133	ESQUADRO 18-1123-C BLOCKING BRACKET ÉQUERRE	12
213267	CANTO ALINHAMENTO Nº1 OT ALIGNMENT ANGLE COIN DE ALIGNEMENT	4
213269	ALTERNATIVA: CANTO ALINHAMENTO Nº2 OT ALIGNMENT ANGLE COIN DE ALIGNEMENT	
213246	CANTO CR S/SB ANGLE COIN	8
212059	CONJ. CANTOS ALIN. P/ARO FIXO OT ALIGN. ANGLE KIT KIT DE COINS DE ALIG	4
218109	CALÇOS P/VIDRO 79x40x3mm GLAZING SHIM CALE POUR VITRAGE	4

PARA AS FERRAGENS, CONSULTAR DEPARTAMENTO TÉCNICO
FOR HARDWARE, CONSULT TECHNICAL DEPARTMENT
POUR SERRURES, CONSULTER DÉPARTEMENT TECHNIQUE

VEDANTES SEALANTS JOINTS		
CÓDIGO CODE	DESIGNAÇÃO DESIGNATION DÉSIGNATION	QUANTIDADE QUANTITY QUANTITÉ
208008	VD 2051 *	2L+2H
208289	VD 2055 **	2L+2H

* ALTERNATIVA | ALTERNATIVE | ALTERNATIVE: VD 2071

** ALTERNATIVA | ALTERNATIVE | ALTERNATIVE: VD 2071

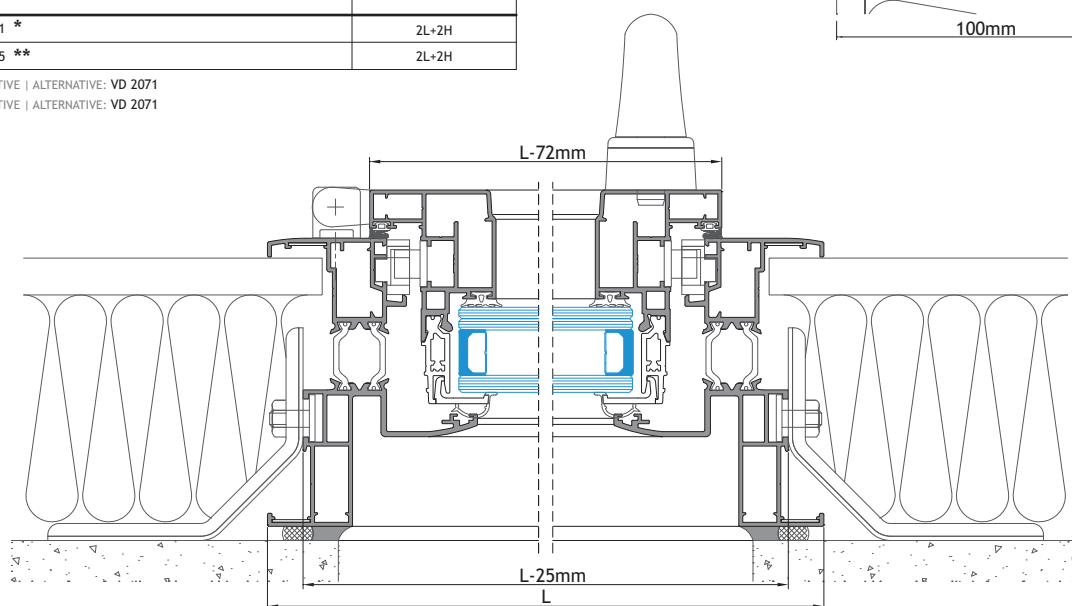
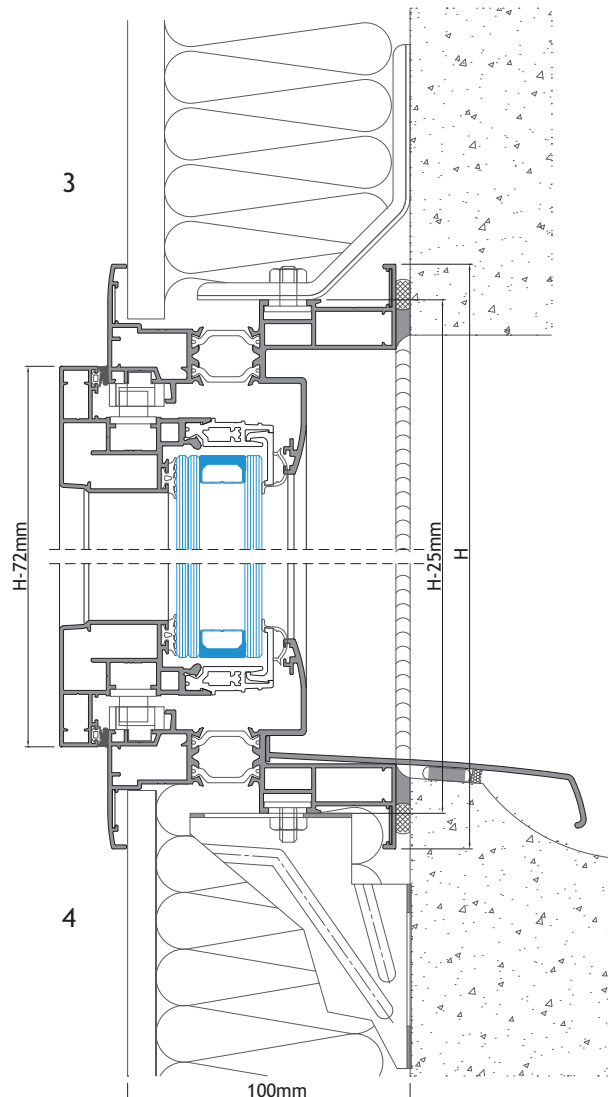

1

2

S/ESC.

JANELA DE 2 FOLHAS - LINHA OCULTA

2 LEAVES CASEMENT WINDOW - LINE CONCEALED

FENÊTRE À LA FRANÇAISE 2 VANTAUX - LIGNE CACHÉ

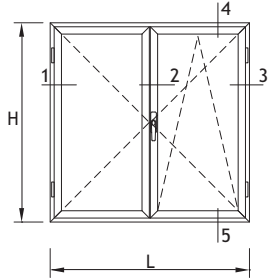

PERFIS - JANELA DE 2 FOLHAS PROFILES - 2 LEAVES WINDOW PROFILS - FENÊTRE À 2 VANTAUX				
REFERÊNCIA REFERENCE RÉFÉRENCE	CORTE HORIZONTAL HORIZONTAL DETAIL DÉTAIL HORIZONTAL	CORTE VERTICAL VERTICAL DETAIL DÉTAIL VERTICALE	QUANTIDADE QUANTITY QUANTITÉ	CORTE CUT COUPÉ
OT-01	L	H	2+2	
OT-05	(L/2)-39	H-72	4+4	
OT-06	-	H-166	1	
OT-95	(L/2)-85	H-118	4+4	
KE-75	L-60	-----	1	

ACESSÓRIOS ACCESSORIES ACCESSOIRES		
CÓDIGO CODE	DESIGNAÇÃO DESIGNATION DÉSIGNATION	QUANTIDADE QUANTITY QUANTITÉ
204133	ESQUADRO 18-1123-C BLOCKING BRACKET ÉQUERRE	16
213267	CANTO ALINHAMENTO Nº1 OT ALIGNMENT ANGLE COIN DE ALIGNEMENT	8
213269	ALTERNATIVA: CANTO ALINHAMENTO Nº2 OT ALIGNMENT ANGLE COIN DE ALIGNEMENT	
213246	CANTO CR S/SB ANGLE COIN	8
212059	CONJ. CANTOS ALIN. P/ARO FIXO OT ALIGN. ANGLE KIT KIT DE COINS DE ALIG	4
212058	CONJ. TOPO-INVERSOR OT-OCULTA END CAP KIT KIT DE EMBOUTES	1
218109	CALÇOS P/VIDRO 79x40x3mm GLAZING SHIM CALE POUR VITRAGE	8

PARA AS FERRAGENS, CONSULTAR DEPARTAMENTO TÉCNICO
FOR HARDWARE, CONSULT TECHNICAL DEPARTMENT
POUR SERRURES, CONSULTER DÉPARTEMENT TECHNIQUE

VEDANTES SEALANTS JOINTS		
CÓDIGO CODE	DESIGNAÇÃO DESIGNATION DÉSIGNATION	QUANTIDADE QUANTITY QUANTITÉ
208143	VD 2071 *	2L+4H
208289	VD 2055 **	2L+4H

* ALTERNATIVA | ALTERNATIVE | ALTERNATIVE: VD 2051

** ALTERNATIVA | ALTERNATIVE | ALTERNATIVE: VD 2071

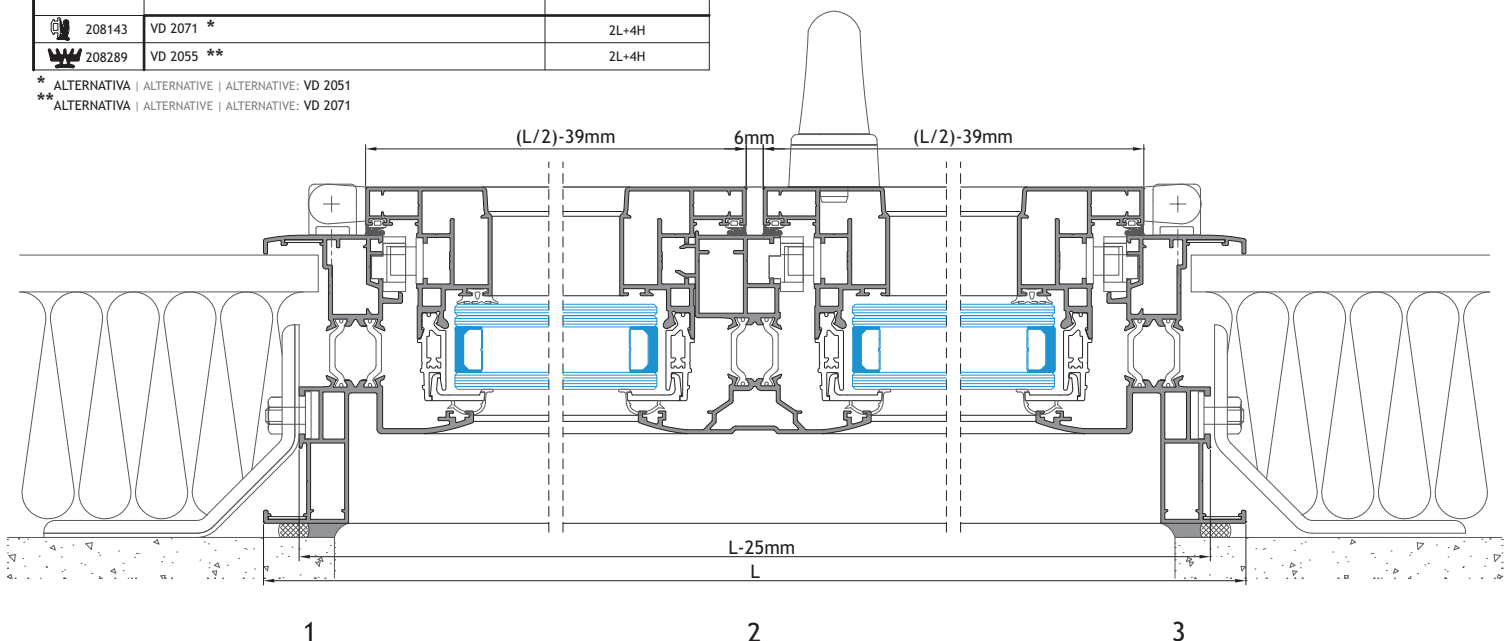
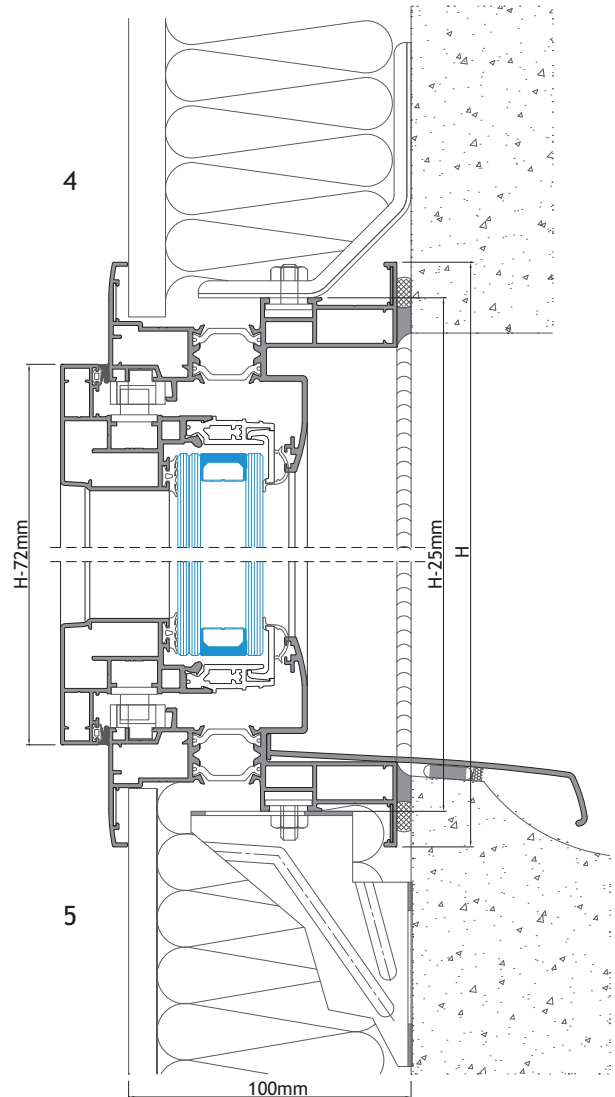

S/ESC.

JANELA DE 1 FOLHA - LINHA OVAL

1 LEAF CASEMENT WINDOW - LINE OVAL

FENÊTRE À LA FRANÇAISE 1 VANTAIL - LIGNE OVALE

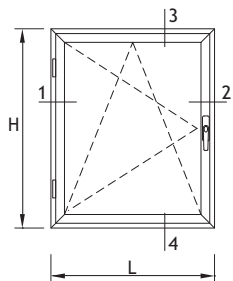

PERFIS - JANELA DE 2 FOLHAS PROFILES - 2 LEAVES WINDOW PROFILS - FENÊTRE À 2 VANTAUX				
REFERÊNCIA REFERENCE	CORTE HORIZONTAL HORIZONTAL DETAIL DÉTAIL HORIZONTAL	CORTE VERTICAL VERTICAL DETAIL DÉTAIL VERTICALE	QUANTIDADE QUANTITY QUANTITÉ	CORTE CUT COUPÉ
OT-01	L	H	2+2	
OT-85	L-72	H-72	2+2	
OT-96	-	H-166	2	
OT-97	L-174.5	-----	2	
KE-75	L-60	-----	1	

ACESSÓRIOS ACCESSORIES ACCESSOIRES		
CÓDIGO CODE	DESIGNAÇÃO DESIGNATION DÉSIGNATION	QUANTIDADE QUANTITY QUANTITÉ
204133	ESQUADRO 18-1123-C BLOCKING BRACKET ÉQUERRE	12
204901	ESQUADRO 18-1112-C BLOCKING BRACKET ÉQUERRE	4
213267	CANTO ALINHAMENTO Nº1 OT ALIGNMENT ANGLE COIN DE ALIGNEMENT	4
213269	ALTERNATIVA: CANTO ALINHAMENTO Nº2 OT ALIGNMENT ANGLE COIN DE ALIGNEMENT	
213246	CANTO CR 5/SB ANGLE COIN	8
212059	CONJ. CANTOS ALIN. P/ARO FIXO OT ALIGN. ANGLE KIT KIT DE COINS DE ALIG.	4
218111	CALÇOS P/VIDRO 79x40x4mm GLAZING SHIM CALE POUR VITRAGE	12
228165	MOLA EURO 2000 CLAMP CLAMEAUX	Diversos Several Diverses

PARA AS FERRAGENS, CONSULTAR DEPARTAMENTO TÉCNICO

FOR HARDWARE, CONSULT TECHNICAL DEPARTMENT

POUR SERRURES, CONSULTER DÉPARTEMENT TECHNIQUE

VEDANTES SEALANTS JOINTS		
CÓDIGO CODE	DESIGNAÇÃO DESIGNATION DÉSIGNATION	QUANTIDADE QUANTITY QUANTITÉ
208143	VD 2071 *	6L+6H
VARIÁVEL VARIABLE	JUNTA DE CUNHA GLAZING WEDGE GASKET JOINT EXTÉRIEUR	2L+2H

* ALTERNATIVA | ALTERNATIVE | ALTERNATIVE: VD 2051

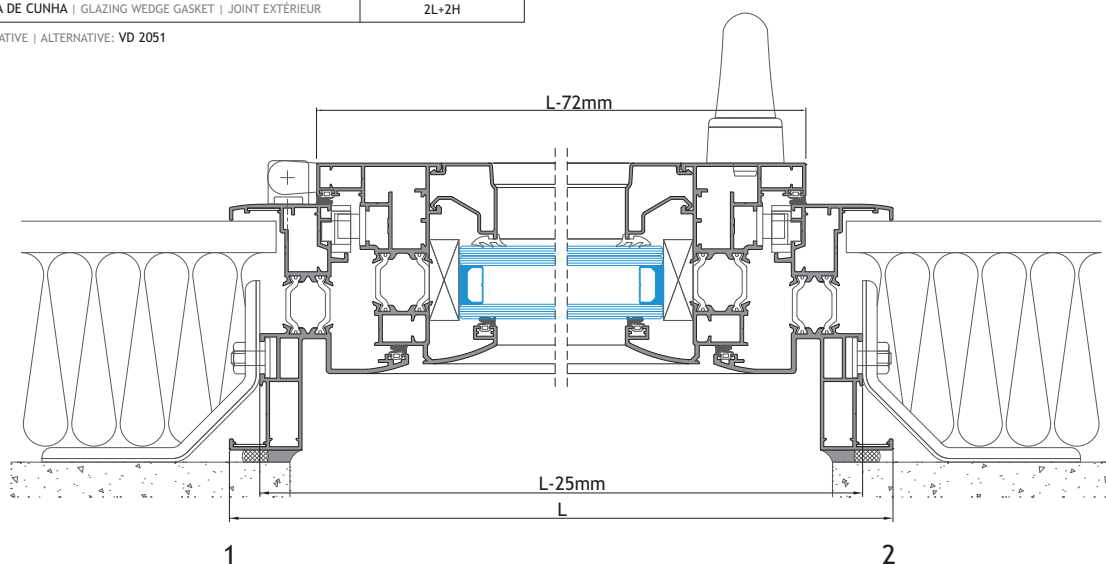
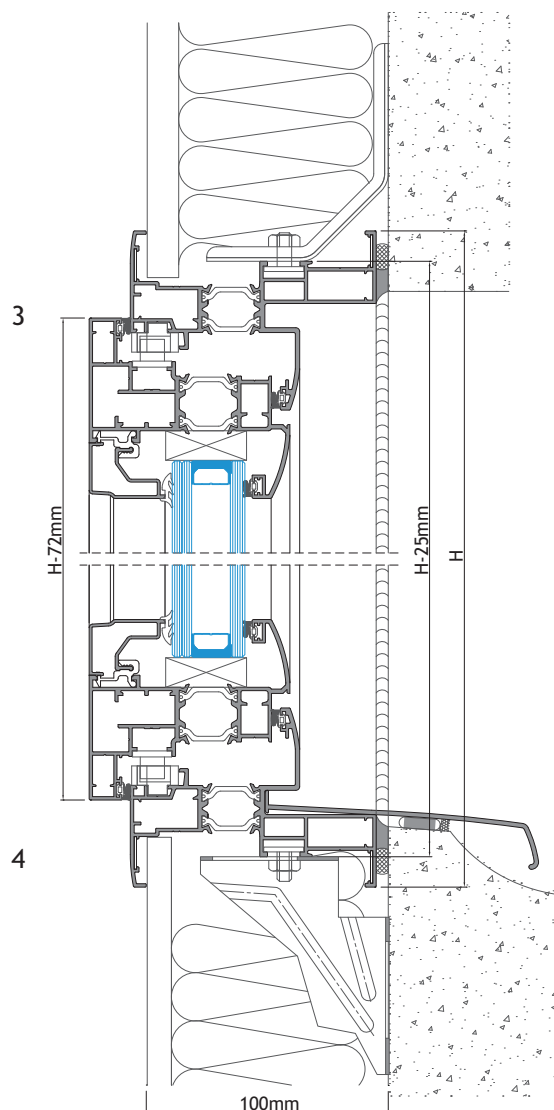

JANELA DE 2 FOLHAS - LINHA OVAL

2 LEAVES CASEMENT WINDOW - LINE OVAL

FENÊTRE À LA FRANÇAISE 2 VANTAUX - LIGNE OVALE

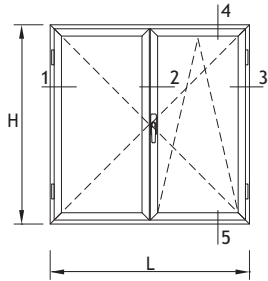

PERFIS - JANELA DE 2 FOLHAS PROFILES - 2 LEAVES WINDOW PROFILS - FENÊTRE À 2 VANTAUX				
REFERÊNCIA REFERENCE	CORTE HORIZONTAL HORIZONTAL DETAIL	CORTE VERTICAL VERTICAL DETAIL	QUANTIDADE QUANTITY	CORTE CUT
OT-01	L	H	2+2	
OT-85	(L/2)-39	H-72	4+4	
OT-06	-	H-166	1	
OT-96	-	H-166	4	
OT-97	(L/2)-141.5	-----	4	
KE-75	L-60	-----	1	

ACESSÓRIOS ACCESSORIES ACCESSOIRES		
CÓDIGO CODE	DESIGNAÇÃO DESIGNATION DÉSIGNATION	QUANTIDADE QUANTITY QUANTITÉ
204133	ESQUADRO 18-1123-C BLOCKING BRACKET ÉQUERRE	16
204901	ESQUADRO 18-1112-C BLOCKING BRACKET ÉQUERRE	8
213267	CANTO ALINHAMENTO Nº1 OT ALIGNMENT ANGLE COIN DE ALIGNEMENT	8
213269	ALTERNATIVA: CANTO ALINHAMENTO Nº2 OT ALIGNMENT ANGLE COIN DE ALIGNEMENT	
213246	CANTO CR S/SB ANGLE COIN	8
212059	CONJ. CANTOS ALIN. P/ARO FIXO OT ALIGN. ANGLE KIT KIT DE COINS DE ALIG	4
212058	CONJ. TOPO-INVERSOR OT-OCULTA END CAP KIT KIT DE EMBOUTES	1
218111	CALÇOS P/VIDRO 79x40x4mm GLAZING SHIM CALE POUR VITRAGE	24
228165	MOLA EURO 2000 CLAMP CLAMEAUX	Diversos Several Diverses

PARA AS FERRAGENS, CONSULTAR DEPARTAMENTO TÉCNICO
FOR HARDWARE, CONSULT TECHNICAL DEPARTMENT
POUR SERRURES, CONSULTER DÉPARTEMENT TECHNIQUE

VEDANTES SEALANTS JOINTS		
CÓDIGO CODE	DESIGNAÇÃO DESIGNATION DÉSIGNATION	QUANTIDADE QUANTITY QUANTITÉ
208143	VD 2071 * (Pelo interior from inside par l'intérieur)	4L+8H
208143	VD 2071 ** (Pelo exterior from outside par l'extérieur)	2L+4H

* ALTERNATIVA | ALTERNATIVE | ALTERNATIVE: VD 2051

** ALTERNATIVA | ALTERNATIVE | ALTERNATIVE: VD 2055

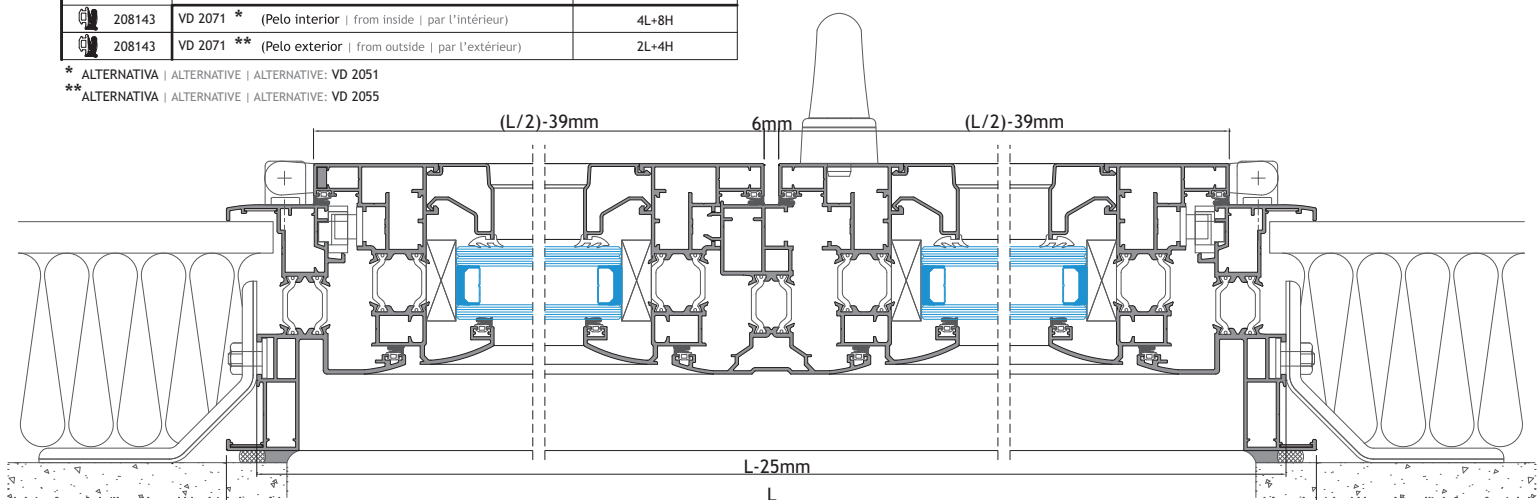
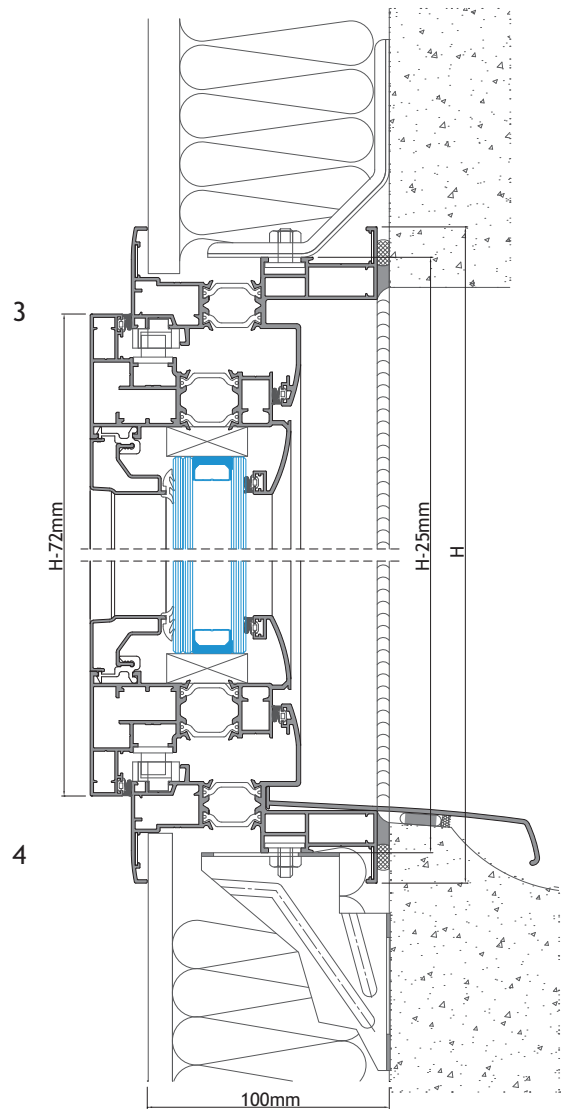

PORTA DE 1 FOLHA - ABERTURA PARA INTERIOR

1 LEAF DOOR - INWARD OPENING

PORTE 1 VANTAIL - OUVERTURE VERS L'INTÉRIEUR

PERFIS - JANELA DE 2 FOLHAS PROFILES - 2 LEAVES WINDOW PROFILS - FENÊTRE À 2 VANTAUX				
REFERÊNCIA REFERENCE RÉFÉRENCE	CORTE HORIZONTAL HORIZONTAL DETAIL DÉTAIL HORIZONTAL	CORTE VERTICAL VERTICAL DETAIL DÉTAIL VERTICALE	QUANTIDADE QUANTITY QUANTITÉ	CORTE CUT COUPÉ
OT-01	L	H	1+2	
OT-88	L-72	H-43	4+4	
OT-96	-	H-210	2	
OT-97	L-247	-----	2	
OT-50	L-84	-----	1	
OT-49	L-160	-----	1	
SA-32	L-164	-----	1	

ACESSÓRIOS ACCESSORIES ACCESSOIRES		
CÓDIGO CODE	DESIGNAÇÃO DESIGNATION DÉSIGNATION	QUANTIDADE QUANTITY QUANTITÉ
204133	ESQUADRO 18-1123-C BLOCKING BRACKET ÉQUERRE	4
204728	ESQUADRO AT E. P. BLOCKING BRACKET ÉQUERRE	4
204257	ESQUADRO SA 35 COR. P. BLOCKING BRACKET ÉQUERRE	4
204902	ESQUADRO 18-1135-C BLOCKING BRACKET ÉQUERRE	4
213267	CANTO ALINHAMENTO Nº1 OT ALIGNMENT ANGLE COIN DE ALIGNEMENT	4
213269	ALTERNATIVA: CANTO ALINHAMENTO Nº2 OT ALIGNMENT ANGLE COIN DE ALIGNEMENT	
213246	CANTO CR S/SB ANGLE COIN	4
212059	CONJ. CANTOS ALIN. P/ARO FIXO OT ALIGN. ANGLE KIT KIT DE COINS DE ALIG	2
218111	CALÇOS P/VIDRO 79x40x4mm GLAZING SHIM CALE POUR VITRAGE	12
228165	MOLA EURO 2000 CLAMP CLAMEAUX	Diversos Several Diverses
228181	MOLA PARA PINGADEIRA DRIP CLAMP CLAMEAUX POUR GOUTTIÈRE	4

PARA AS FERRAGENS, CONSULTAR DEPARTAMENTO TÉCNICO

FOR HARDWARE, CONSULT TECHNICAL DEPARTMENT

POUR SERRURES, CONSULTER DÉPARTEMENT TECHNIQUE

VEDANTES SEALANTS JOINTS		
CÓDIGO CODE	DESIGNAÇÃO DESIGNATION DÉSIGNATION	QUANTIDADE QUANTITY QUANTITÉ
208143	VD 2071 * (Pelo interior from inside par l'intérieur)	3L+4H
208289	VD 2055 ** (Pelo exterior from outside par l'extérieur)	2L+2H
VARIÁVEL VARIABLE	JUNTA DE CUNHA GLAZING WEDGE GASKET JOINT EXTÉRIEUR	2L+2H
208294	VR 3180	2L

* ALTERNATIVA | ALTERNATIVE | ALTERNATIVE: VD 2051

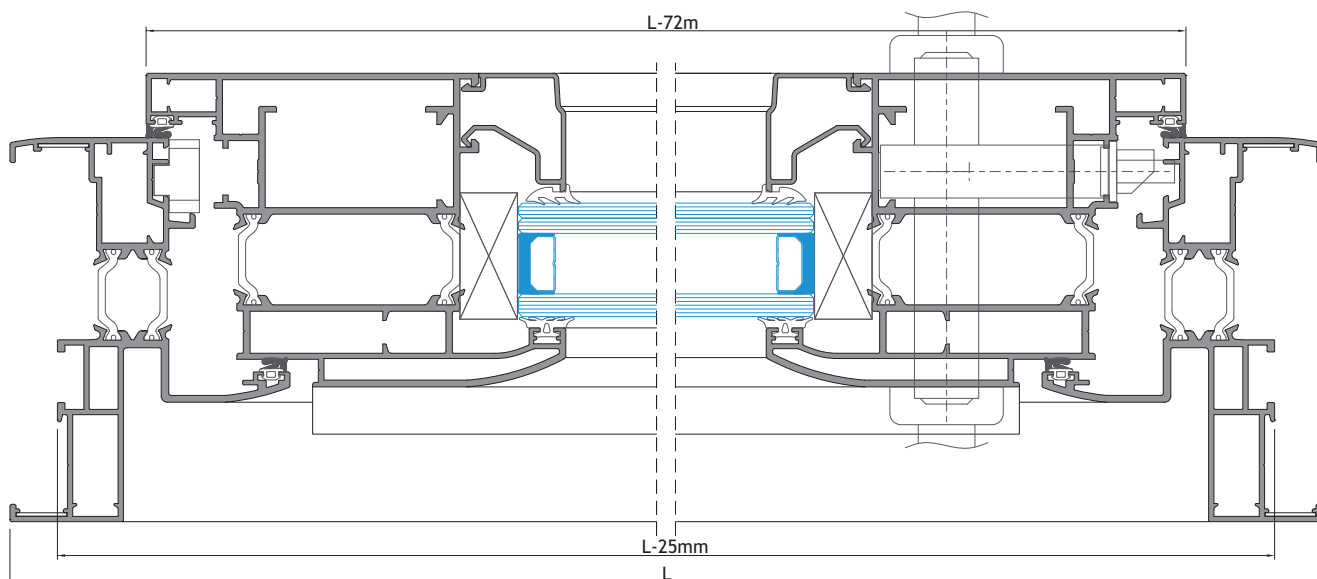
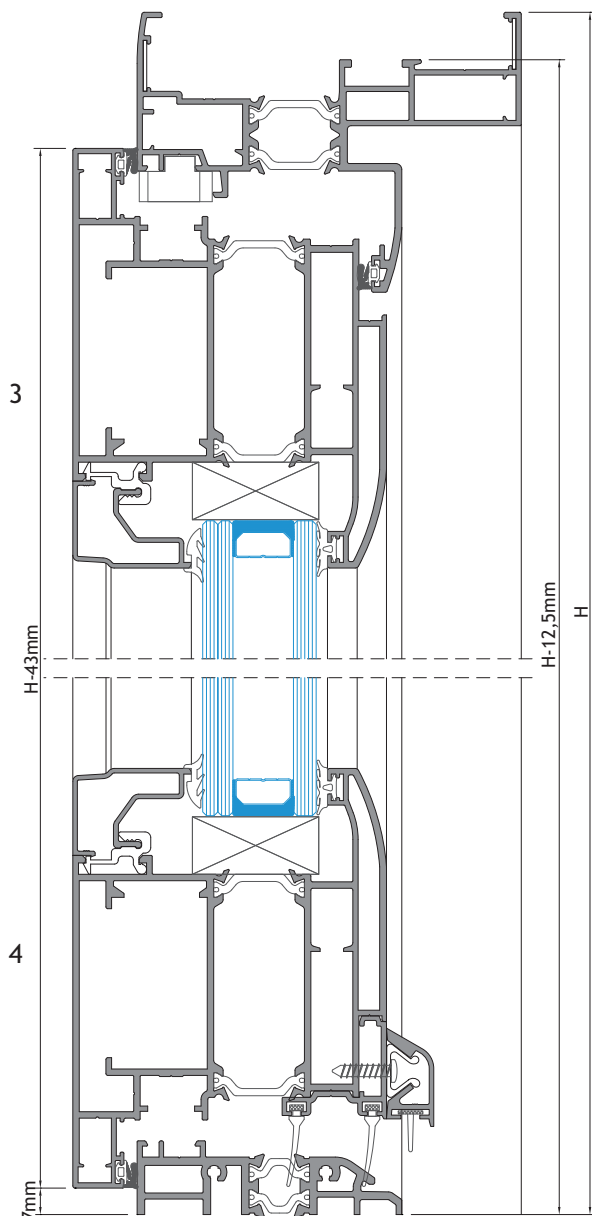
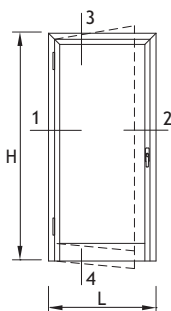

PORTA DE 1 FOLHA - ABERTURA PARA INTERIOR

1 LEAF DOOR - INWARD OPENING

PORTE 1 VANTAIL - OUVERTURE VERS L'INTÉRIEUR

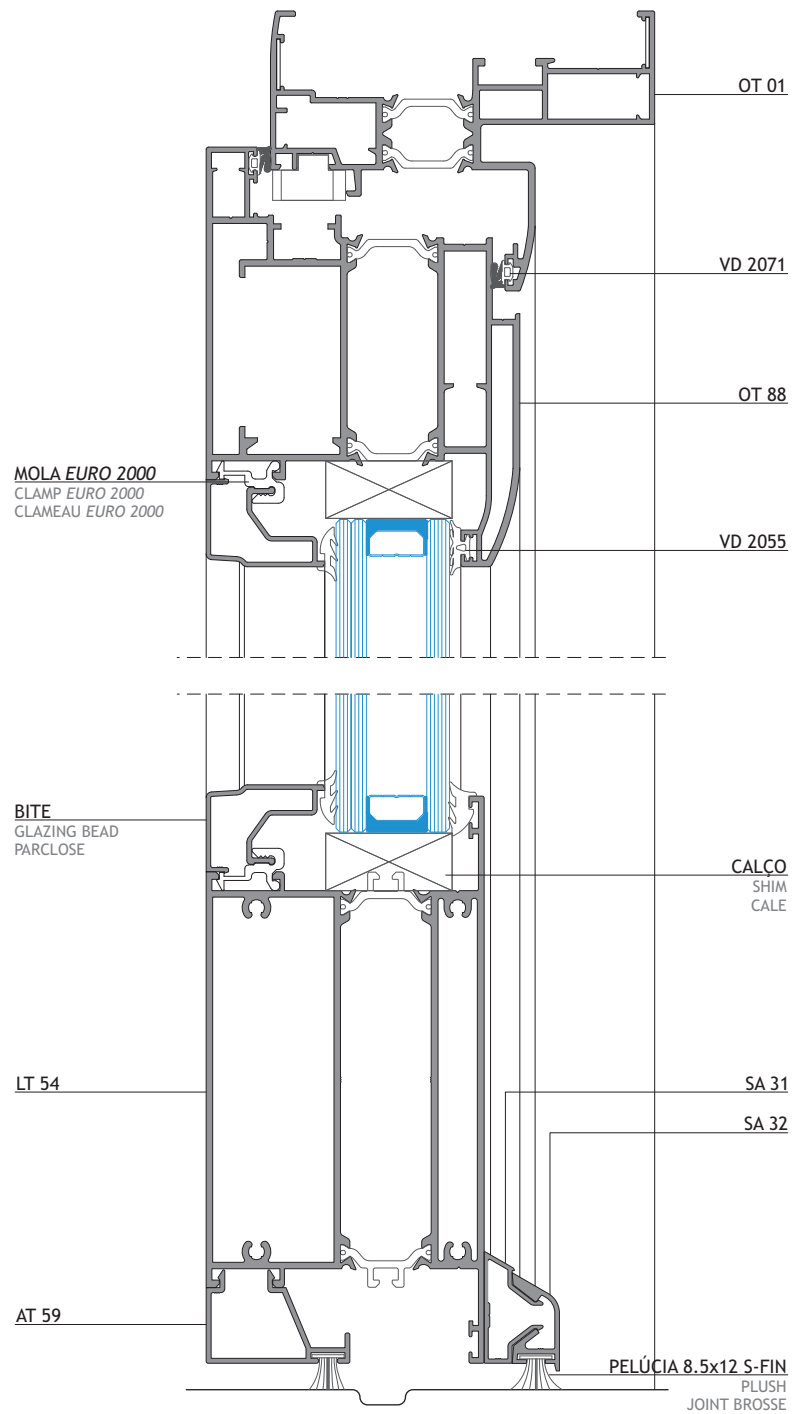

PAINEL ISOLANTE: 100mm
INSULATION PANEL: 100mm
PANNEAU D'ISOLATION: 100mm

ÂNGULO FIXAÇÃO 90mm
FIXING ANGLE 90mm
ANGLE DE FIXATION 90mm

SUPORTE DE FIXAÇÃO 90mm
FIXING BRACKET 90mm
SUPPORT DE FIXATION 90mm

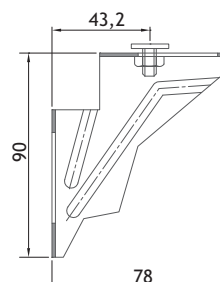
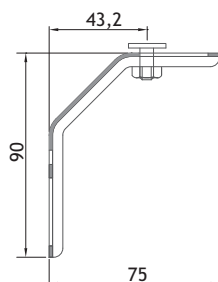

PAINEL ISOLANTE: 120mm
INSULATION PANEL: 120mm
PANNEAU D'ISOLATION: 120mm

ÂNGULO FIXAÇÃO 100mm
FIXING ANGLE 100mm
ANGLE DE FIXATION 100mm

SUPORTE DE FIXAÇÃO 90mm
FIXING BRACKET 90mm
SUPPORT DE FIXATION 90mm

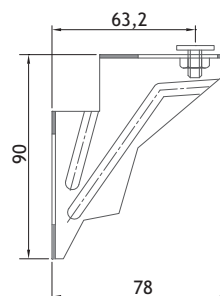
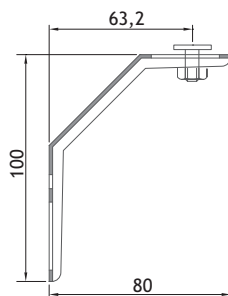

PAINEL ISOLANTE: 140mm
INSULATION PANEL: 140mm
PANNEAU D'ISOLATION: 140mm

ÂNGULO FIXAÇÃO 100mm
FIXING ANGLE 100mm
ANGLE DE FIXATION 100mm

SUPORTE DE FIXAÇÃO 100mm
FIXING BRACKET 100mm
SUPPORT DE FIXATION 100mm

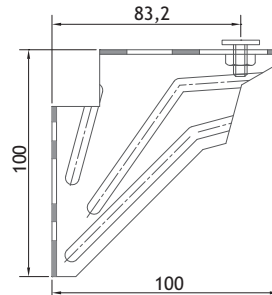
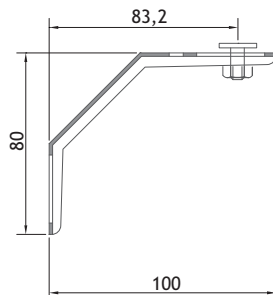

PAINEL ISOLANTE: 160mm
INSULATION PANEL: 160mm
PANNEAU D'ISOLATION: 160mm

ÂNGULO FIXAÇÃO 120mm
FIXING ANGLE 120mm
ANGLE DE FIXATION 120mm

SUPORTE DE FIXAÇÃO 120mm
FIXING BRACKET 120mm
SUPPORT DE FIXATION 120mm

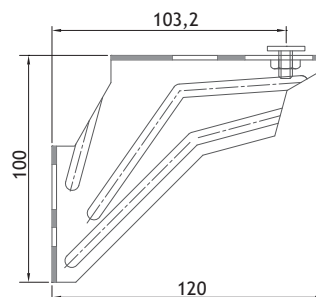
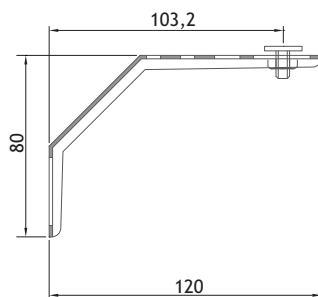

PAINEL ISOLANTE: 180mm
INSULATION PANEL: 180mm
PANNEAU D'ISOLATION: 180mm

ÂNGULO FIXAÇÃO 140mm
FIXING ANGLE 140mm
ANGLE DE FIXATION 140mm

SUPORTE DE FIXAÇÃO 140mm
FIXING BRACKET 140mm
SUPPORT DE FIXATION 140mm

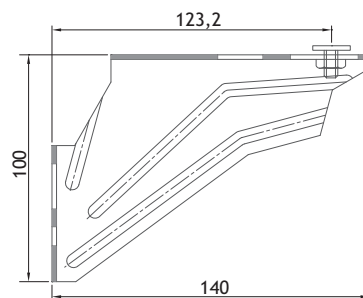
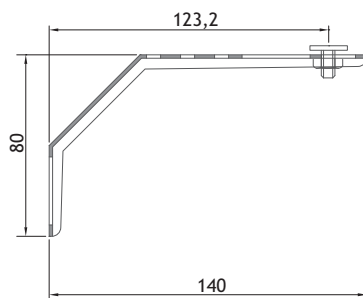

LINHA RENOVATIO - PAINEL DE 100mm

LINE RENOVATIO - 100mm PANEL

LIGNE RENOVATION - PANNEAU DE 100mm

Peso máximo de vidro permitido: 35Kg/m²

Maximum glass weight allowed: 35Kg/m²

Poids maximum de verre autorisé: 35Kg/m²

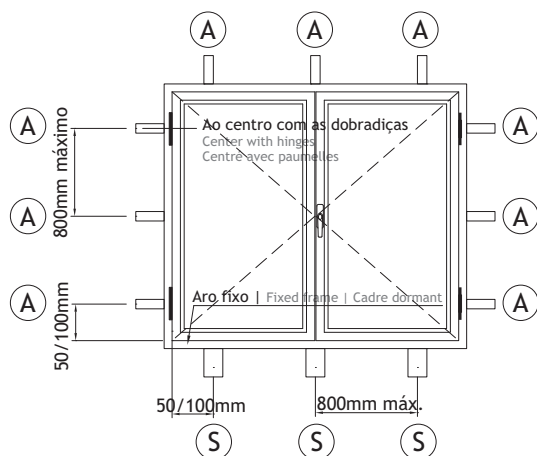

A ÂNGULO FIXAÇÃO 90mm, 100mm, 120mm ou 140mm

FIXING ANGLE 90mm, 100mm, 120mm or 140mm

ANGLE DE FIXATION 90mm, 100mm, 120mm ou 140mm

S SUPORTE FIXAÇÃO 90mm, 100mm, 120mm ou 140mm

FIXING BRACKET 90mm, 100mm, 120mm or 140mm

SUPPORT DE FIXATION 90mm, 100mm, 120mm ou 140mm

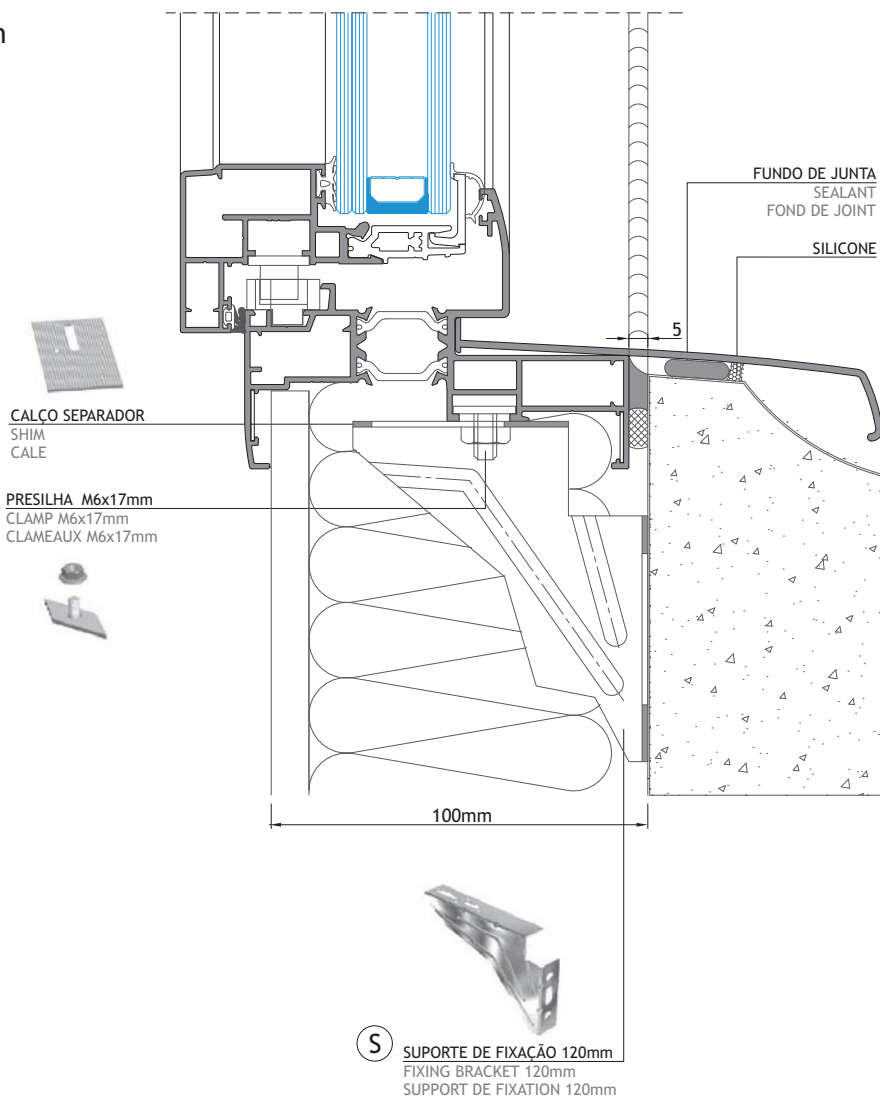

S SUPORTE DE FIXAÇÃO 120mm
FIXING BRACKET 120mm
SUPPORT DE FIXATION 120mm

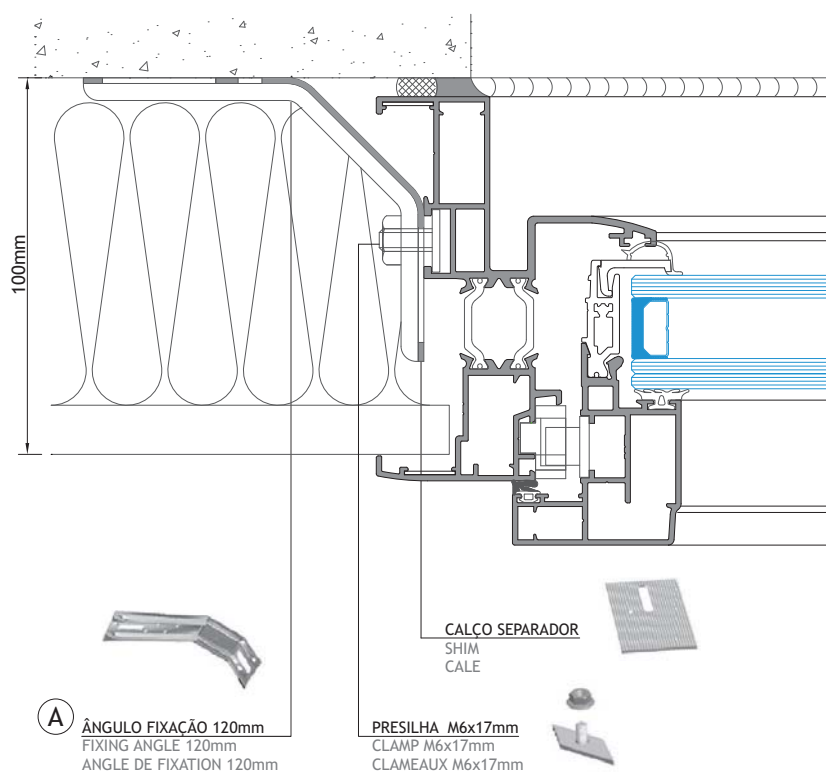

A ÂNGULO FIXAÇÃO 120mm
FIXING ANGLE 120mm
ANGLE DE FIXATION 120mm

PRESILHA M6x17mm
CLAMP M6x17mm
CLAMEAUX M6x17mm

ESC: 1/2







SISTEMAS
EURO 2000®
PERFIS DE ALUMÍNIO E VIDROS PARA ARQUITECTURA

ALFA SUL

EN Lisboa-Sintra Km 14
2725-397 Mem Martins
T +351 219 265 090 | F +351 219 265 098
E alfa.sul@sosoares.pt

ALULIDER

Pavilhão Industrial H - Plataforma 13D
Zona Franca Industrial
9200-047 Caniçal - Madeira
T +351 291 960 494 | F +351 291 960 497
E alulider@sosoares.pt

METALFER

Travessa do Bolegão, 146
Apartado 1
3754-904 Fermentelos
T +351 234 729 740 | F +351 234 729 741
E metalfer@sosoares.pt

PERFIS OEIRAS

Rua da Colónia - Quinta da Cardosa
Apartado 214 - Abrunheira
2711-952 Sintra
T +351 219 156 660 | F +351 219 156 661
E perfis.oeiras@sosoares.pt

PORTALEX

Estrada de S. Marcos, 23
2735-521 Cacém
T +351 210 412 500 | F +351 210 412 507
E comercial@portalex.eu

SOSOARES

Rua do Campo Alegre, 474
4150-170 Porto
T +351 226 096 709 | F +351 226 005 642
E comercial@sosoares.pt



www.sosoares.pt



www.portalex.eu